

SYMBOL DEFINITION		MISSING SYMBOLS		REV. SYMBOL		REVISION HISTORY		APP	DATE
A DIMENSION WITHOUT AN INSPECTION REPORT SYMBOL (M) DOES NOT REQUIRE INSPECTION. IT MAY BE CONTROLLED ON THE INDIVIDUAL COMPONENT DRAWING.	TOTAL NO. OF INSPECTIONS REQUIRED	NO. MISSING SYMBOL NUMBER	DATE	DESCRIPTION	ZONE	REVISION NO.	BY	DATE	APP
	8	07	06	01	-	REVISION BY NO. 20	MM	1/13/11	200707
	5					REVISED DIM. ON T.C. SPEC.			
						REVISED RADIUS ON INSIDE OF LOCK FEATURE			

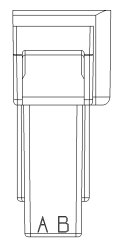

- NOTES
- UNLESS OTHERWISE SPECIFIED AND/OR INDICATED, DIMENSIONS ARE TO FACE OF VIEW SHOWN AND AUTOMATICALLY ROUNDED BY COMPUTER FOR INSPECTION (SEE MATH MODEL FOR PRECISE DIMENSIONS). FOR ALL OTHER DIMENSIONS NOT SHOWN BUT REQUIRED FOR TOOL BUILD, SEE MATH MODEL FOR PRECISE TOOL PATH DATA.
 - MATERIAL RECYCLING CODE 39811 PER SAE J1344. (11)(10.1) RAISED CHARACTERS AS SHOWN TO BE LOCATED ON ANY EXTERIOR SURFACE. OPTIONAL CONSTRUCTION TO BE NO MATERIAL RECYCLING CODE.
 - MATING COMPONENTS OR EQUIVALENT: CONNECTOR 12064865
 - THIS PART ACCEPTS THE FOLLOWING COMPONENTS OR EQUIVALENT: TERMINAL 12040993
MAX. INSULATION CRIMP MUST BE LESS THAN 3 HIGH AND 2.6 WIDE.
SECONDARY TERMINAL LOCK 12047665
 - (11)(10.1) RAISED DELPHI CORPORATE BRAND TO BE LOCATED ON ANY EXTERIOR SURFACE, PREFERABLY VISIBLE AT FINAL ASSEMBLY. OPTIONAL CONSTRUCTION TO BE "PRED" OR NO LOGO.
 - THIS CONNECTOR WILL PASS THROUGH A 21 DIA. MIN. HOLE.

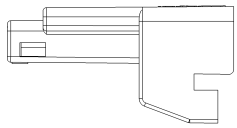
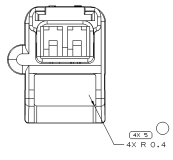
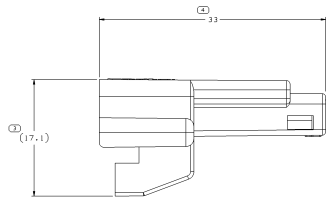
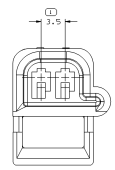
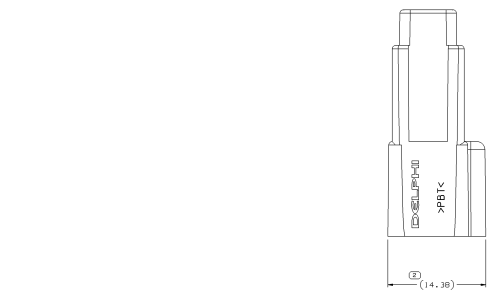
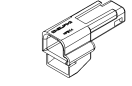

VIEW SCALE DOES NOT REFLECT ACTUAL PART SIZE

PART DRAWING	
DATE	11/17/10
SCALE	1:1
UNLESS OTHERWISE SPECIFIED	
DIMENSIONS ARE TO FACE UNLESS OTHERWISE SPECIFIED	
ALL DIMENSIONS ARE TO BE HONED UNLESS OTHERWISE SPECIFIED	
ALL DIMENSIONS ARE TO BE HONED UNLESS OTHERWISE SPECIFIED	
ALL DIMENSIONS ARE TO BE HONED UNLESS OTHERWISE SPECIFIED	

DELPHI
DELPHI PACKAGING ELECTRIC SYSTEM
WARR, OH

DATE	11/17/10
SCALE	1:1
UNLESS OTHERWISE SPECIFIED	
DIMENSIONS ARE TO FACE UNLESS OTHERWISE SPECIFIED	
ALL DIMENSIONS ARE TO BE HONED UNLESS OTHERWISE SPECIFIED	
ALL DIMENSIONS ARE TO BE HONED UNLESS OTHERWISE SPECIFIED	
ALL DIMENSIONS ARE TO BE HONED UNLESS OTHERWISE SPECIFIED	

ISSUED TO: COEN 2 M W/P 150 NAT

ISSUED BY: 12064868

SHEET NO. 1 OF 1