

REVISION HISTORY				
REV	DESCRIPTION	BY	DATE	ECN
0	FIRST ISSUE	T.N	11/02/10	8882



PART NUMBER BREAKDOWN

**TM2R B J - AU**

SERIES DESIGNATION

CONTACT FINISH  
BLANK: NICKEL  
AU: : GOLD

SHELL FINISH  
BLANK: NICKEL  
B: : BLACK

CABLE CLAMP SIZE  
BLANK: STANDARD  
J: : LARGE

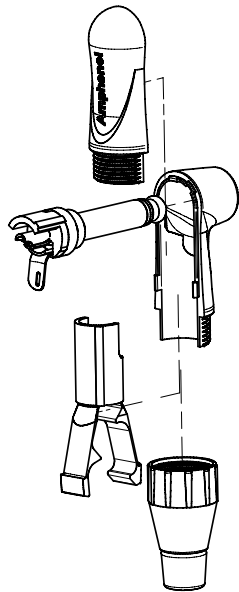
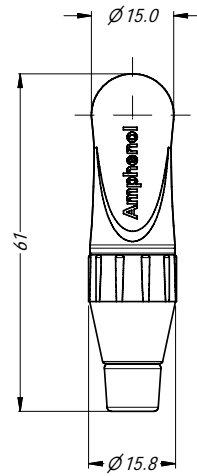
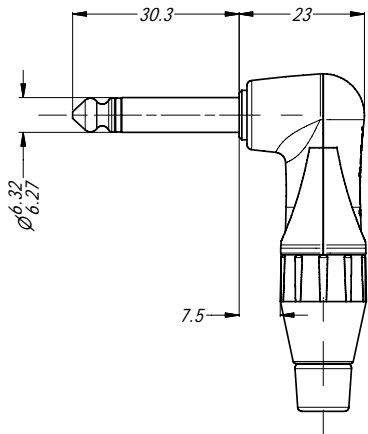
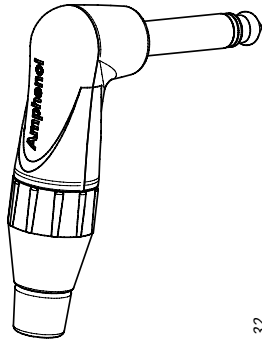

NOTES:

- STANDARD JAW CABLE CLAMP (BLACK) USED FOR CABLE OD 3.0 mm TO 5.5mm  
LARGE JAW CABLE CLAMP (PURPLE) USED FOR CABLE OD 5.5mm TO 6.5mm

UNLESS OTHERWISE SPECIFIED TOLERANCE TO BE		THIS DOCUMENT IS THE PROPERTY OF AMPHENOL AUSTRALIA PTY. LTD. NO PART THEREOF MAY BE REPRODUCED AND USED WITHOUT THE PRIOR WRITTEN CONSENT OF THE OWNER				<b>Amphenol</b> Amphenol Australia Pty.Ltd, 2 Fiveways Blvd, Keysborough, VIC 3173	
LINEAR		ANGULAR		MATERIAL:	DRN: T.N	DATE: 26/10/09	TITLE: <b>1/4 PHONE PLUG MONO RIGHT ANGLE CUSTOMER DWO</b>
X ± 0.5	X° ± 1			SEE COMPONENTS	CKD: P.M	DATE: 27/10/09	PART No: SEE P/No BREAKDOWN
X.X ± 0.1	X.X° ± 30'	BREAK ALL SHARP EDGES AND REMOVE ALL BURRS		DO NOT SCALE	APP'D: P.M	DATE: 27/10/09	DRAWING NO: 55010637-000-2
X.XX ± 0.05	X.XX° ± 15'			FINISH: SEE COMPONENTS	SCALE: 1:1	SIZE: A4	SHEET 2/2
DIMENSIONS IN MILLIMETRES		THIRD ANGLE PROJECTION		CAD FILE: 55010637000210			