

ISO VIEW
(FOR DUST CAP OPTION
REFER TO TABLE)

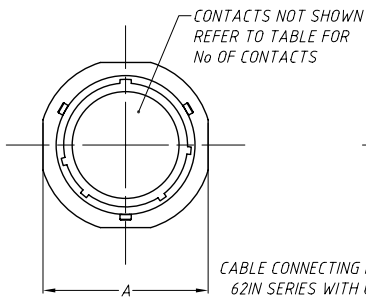

CONTACTS NOT SHOWN
REFER TO TABLE FOR
No OF CONTACTS

CABLE CONNECTING RECP
62IN SERIES WITH GOLD
PLATED SOLDER
SOCKET CONTACTS

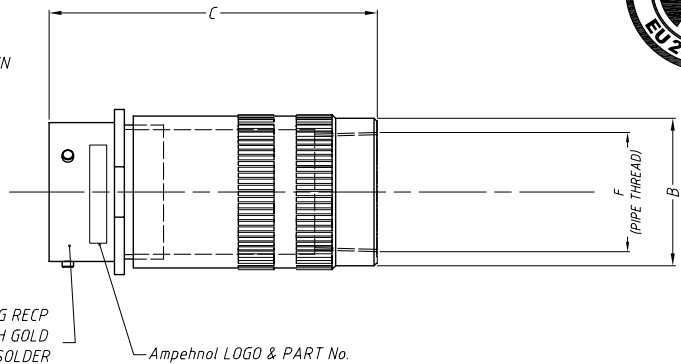

Amphenol LOGO & PART No.

ITEM	PART No	DUST CAP OPTION	SHELL SIZE	No OF CONTACTS	A	DIA B	C ±.5	THREAD F
1	MP-6511-39S	NO	20	39	36.6	34	90	3/4" - 14 NPT
2	MP-6511-39S-C	YES						
3	MP-6511-61S	NO	24	61	43.0	41	100	3/4" - 14 NPT
4	MP-6511-61S-C	YES						

NOTES:

- MATERIAL & FINISH: DIE CAST ALUMINUM ALLOY, BLACK FINISH
- ASSEMBLY TO BE SUPPLIED WITH GOLD PLATED SOCKET CONTACTS

CUSTOMER DRAWING

UNLESS OTHERWISE SPECIFIED TOLERANCE TO BE		THIS DOCUMENT IS THE PROPERTY OF AMPHENOL AUSTRALIA PTY. LTD. NO PART THEREOF MAY BE REPRODUCED AND USED WITHOUT THE PRIOR WRITTEN CONSENT OF THE OWNER				0	FIRST ISSUE	L.V	20-10-05	----
LINEAR	ANGULAR	CAD FILE: 55010309000121	DRN: L.V	DATE: 20-10-05	REV.	CHANGE DETAILS	BY	DATE	CHG/No	
X ± 0.5	X° ± 1°	MATL: SEE NOTE 1	CKD: M.P	DATE: 20/02/06	TITLE: CABLE CONNECTING RECEPTACLE SOCKET CONTACTS		Amphenol		Amphenol Australia Pty Ltd, 7 Friarage Blvd, Kaysborough, Vic 3173	
XX ± 0.1	X°X' ± 30'	FINISH: SEE NOTE 2	APP'D: M.P	DATE: 20/02/06	DRAWING NO. 55010309-000-2		SHEET 1 OF 2			
XXX ± 0.05	X°XX' ± 15'	DIMENSIONS IN MILLIMETRES		THIRD ANGLE PROJECTION	SCALE: NTS	PART No: SEE TABLE	SIZE: A4			