

# Right Angle RCA PCB Mount Phono Jacks

161-0360, 161-0370, 161-0380, 161-0390

**KOBI**CONN

Right Angle RCA PCB Mount Phono Jacks

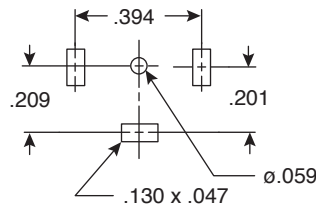
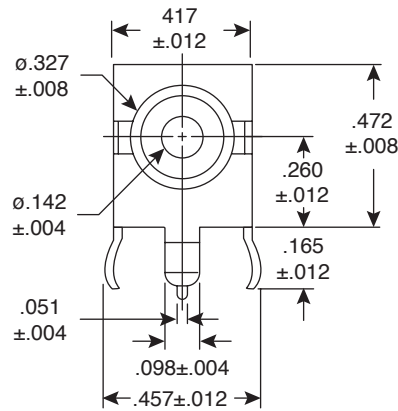
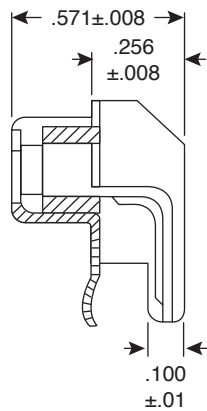
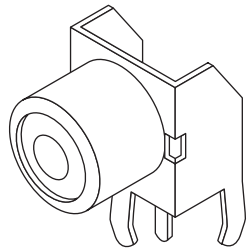

PCB Hole Layout

Dimensions: In.

## SPECIFICATIONS

<b>Type:</b>	Right Angle, PCB Mount, Phono
<b>Insulation Resistance:</b>	10MΩ min. @ 500V RMS
<b>Withstand Voltage:</b>	1080VAC for 1 Minute
<b>Humidity Test:</b>	90% RH @ 40°C for 48 Hours
<b>Temperature Rating:</b>	70°C
<b>Body:</b>	Tin Plated Steel
<b>Contact:</b>	Tin Plated Brass
<b>Insulator:</b>	PBT
<b>Withstand Heat:</b>	250°C, 3 sec.

MOUSER STOCK NO.	Color
161-0360	White
161-0370	Red
161-0380	Yellow
161-0390	Black

Date Last Revised: 4-19-05

Available from Mouser Electronics  
1-800-346-6873  
www.mouser.com

KC-300561

161-0360, 161-0370, 161-0380, 161-0390