

**Dimensions (In.)**  
(except where noted)

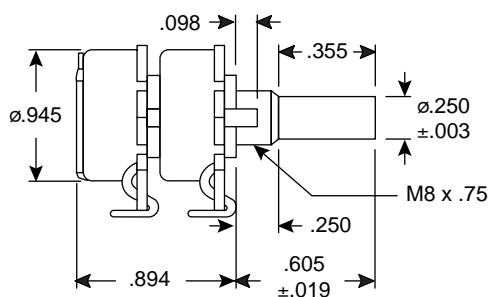
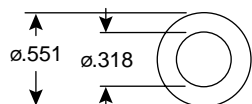

**Specifications:**

- Type: dual ganged
- Resistance tolerance:  $\pm 20\%$
- Working voltage: 350V max.
- Overload voltage: 1000VAC for 1 minute
- Power dissipation: 0.5W (31VW Series) .25W (313-2420-Value)
- Insulation resistance:  $>100M\Omega$  @ 500VDC
- Rotational noise: with 20VDC between terminals 1 and 3, noise should be  $< 47mV$  with shaft rotation of 30 cycles per minute
- Rotation angle:  $300^\circ \pm 5^\circ$
- Rotational torque: 50-450 gcm
- Rotational life: 15,000 cycles
- Anti-rotational torque: 9Kgcm
- Tracking tolerance:  $0\sim 40\pm 3dB$

Audio Taper

Mouser Stock No.	Value ( $\Omega$ )
313-2420-1K	1K
313-2420-5K	5K
313-2420-10K	10K
313-2420-50K	50K
313-2420-100K	100K
313-2420-250K	250K
313-2420-500K	500K
313-2420-1M	1M

Linear Taper

Mouser Stock No.	Value ( $\Omega$ )
31VW205	500
31VW301	1K
31VW305	5K
31VW401	10K
31VW405	50K
31VW501	100K
31VW503	250K
31VW505	500K
31VW601	1M