

Shaft shown in full CCW position

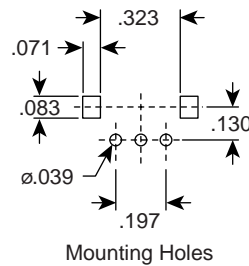
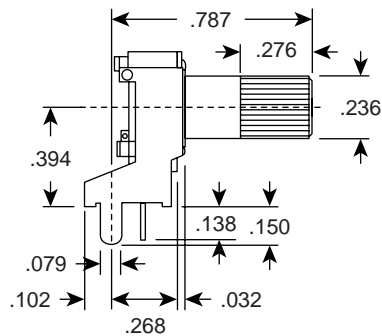

Mounting Holes

Dimensions (In.)

Specifications:

- Type: miniature snap-in
- Taper: linear
- Rotation angle: $280^\circ \pm 5^\circ$
- Rotation torque: 10 ~ 100gf.cm
- Shaft stop strength: >3Kgf cm/min.
- Rotation life: 10,000 cycles
- Rated wattage: .1W
- Rated voltage: 50VAC