

DC San Ace

Blower

150mm
San Ace B150



Blower

General specifications

Frame, Impeller Plastics
 Motor protection system Current Cut System (with reverse polarity protection)
 Dielectric strength AC50/60Hz 500V 1 minute (between lead conductor and frame)
 Operating thermally range -20°C to +70°C (non-condensing)
 Life Expectancy 40,000 hours (Survival Rate 90% at 60°C, rated voltage and continuously run in a free air state)
 Fan power lead ⊕red, ⊖black

Specifications

Model No.	Rated voltage (V)	Operating voltage range (V)	Rated current (A)	Rated input (W)	Rated rotating speed (min ⁻¹)	Air flow (m ³ /min) (CFM)	Static pressure (Pa)	Noise (dB [A])	Mass (g)
9BN12HA1	12	8.4~13.8	1.6	19.2	2,700	2.0	70.7	56	380
9BN12FA1			1.1	13.2	2,200	1.65	58.3	51	
9BN24HA1	24	16.8~27.6	0.74	17.8	2,700	2.0	70.7	56	
9BN24FA1			0.54	13.0	2,200	1.65	58.3	51	

Typical air flow and static pressure characteristics

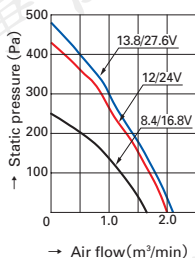

9BN12HA1
9BN24HA1

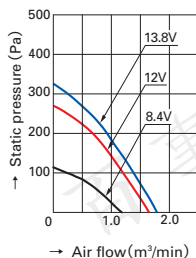

9BN12FA1

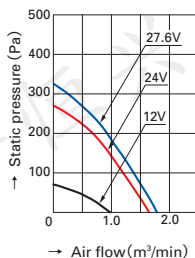

9BN24FA1

Dimensions (unit: mm)

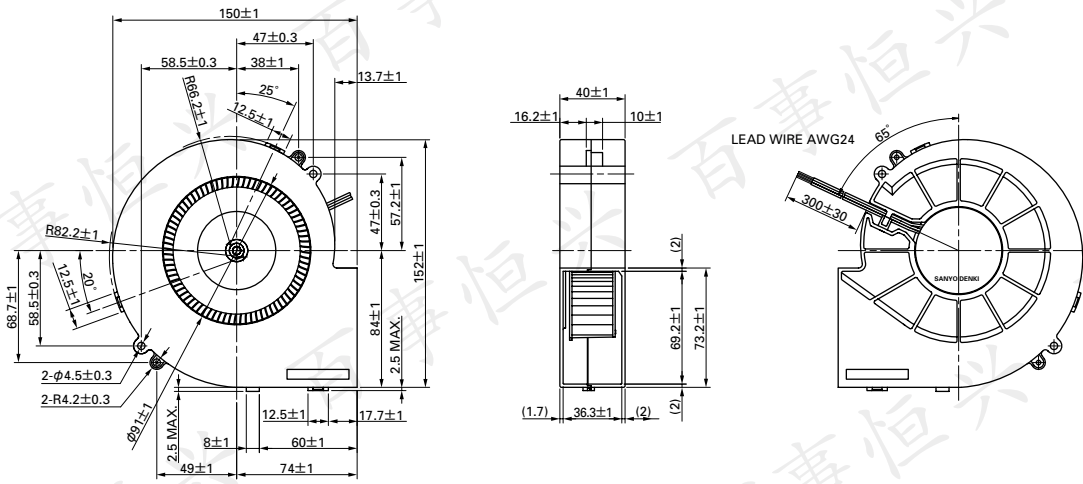

BLOWER

150mm

Notice

- The products shown in the catalog are subject to Japanese Export Control Law. Diversion contrary to the law of exporting country is prohibited.
- To protect against electrolytic cooling corrosion that may occur in locations of strong electromagnetic noise, we provide fans that are unaffected by electrolytic corrosion. Alternative measures to protect against electrolytic corrosion may include metallic finger guards or other metallic attachments. Please contact us for details.

SANYO DENKI