

**Specification Status: Released**

**Max Electrical Rating at 20°C**

**Operating Voltage: 250V<sub>DC</sub>**  
**Fault Voltage: 600V<sub>RMS</sub>**  
**Interrupt Current: 3A<sub>RMS</sub>**

Lead Material :  
 22 AWG Sn/Pb plated copper

**Marking:**

Raychem Logo and Voltage  
 X 600  
 160 — Part Identification  
 □ □ □ □ — Lot Identification

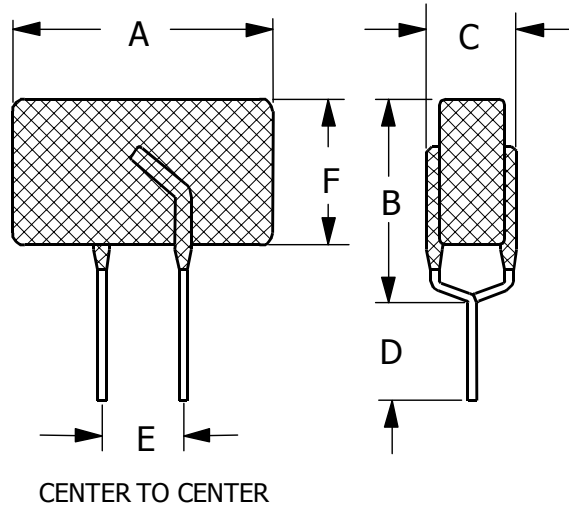

**TABLE I. DIMENSIONS:**

	A		B		C		D		E	F
	MIN	MAX	MIN	MAX	MIN	MAX	MIN	MAX	NOM	MIN
mm:	--	16.0	--	12.6	--	6.0	4.7	--	5.0	10.0
in:	--	(0.630)	--	(0.496)	--	(0.236)	(0.185)	--	(0.197)	(0.394)

**TABLE II. PERFORMANCE RATINGS @ 20°C (unless otherwise noted):**

IHOLD (A)		RESISTANCE (Ω)			TIME TO TRIP (S) @ 1A		OPERATING TEMPERATURE (°C)	
20°C	60°C	R MIN	R MAX	R <sub>1 MAX</sub> *	TYP	MAX	MIN	MAX
0.160	0.100	4.0	10.0	18.0	7.5	18.0	-40	85

\*Maximum device resistance at 20°C measured 1 hour post trip.

Storage Temperature: -40° to 85°C

Agency Recognition: UL, CSA  
 Reference Documents: PS300  
 Precedence: This specification takes precedence over documents referenced herein.  
 Effectivity: Reference documents shall be the issue in effect on the date of invitation for bid.  
 CAUTION: Operation beyond the rated voltage or current may result in rupture, electrical arcing or flame.