

Copyright FCJ

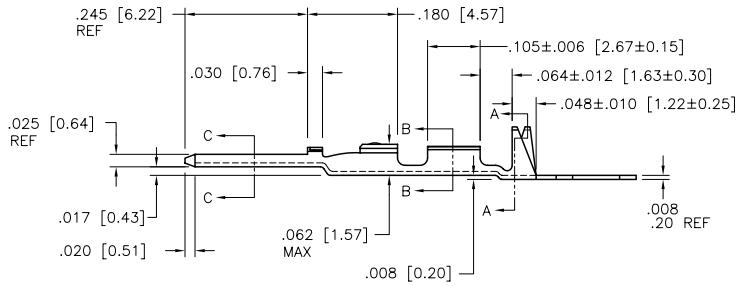

PRODUCT NUMBER  
SEE SHEET 2

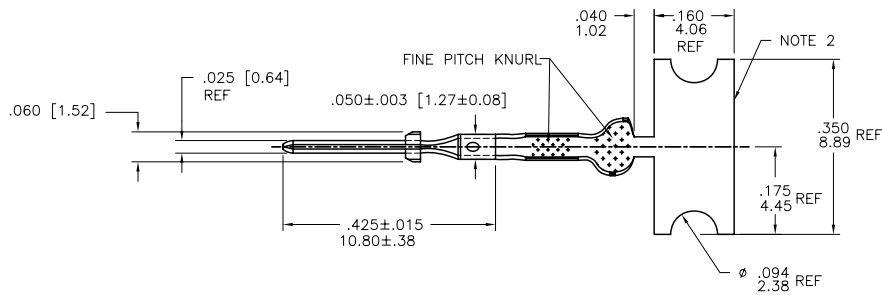

mat'l. code 3/4 HD BRASS CDA NO. 260		surface	tolerance	projection	product family
D v41703 SAR 1994-11-30			XX +01/-x+3		PV TERMINAL
E v80946 LSS 1998-06-03		angles	XXX +005/-XX+13	INCH/MM	title
F v04-0056 VS 2004-02-17		dr	XXXX +0020/-XXX+051	scale 4/1	CTW MALE PIN
G v05-0467 HTB 2005-05-23	dr	S ROYER	1994-11-30		sheet 1 of 3
H v06-0623 HTB 2006-06-28	engr	T.HANNA	1994-11-30		size
J v07-0218 HTB 2007-03-16	chr	T.HANNA	1994-11-30		A4
K v08-0440 HTB 2008-10-09	appd	T.HANNA	1994-11-30		type
sheet	revision	K	K	K	CUSTOMER Drawing
index	sheet	1	2	3	

form A4mmXLC

PDM: Rev:K STATUS:Released Printed: Feb 20, 2010

PRODUCT NO. AS REELED FOR APPLICATION MACHINES NOTE 5		WIRE AWG	WIRE BARREL			INSULATION BARREL			
RIGHT TO LEFT FEED	LEFT TO RIGHT FEED		A	B	C	D	E	F	
75653-001	75653-004	28-32	.054/1.37	.058/1.47	.011/0.28	.115/2.92	.105/2.67	.040/1.02	OBSOLETE
75653-001LF	75653-004LF	28-32	.054/1.37	.058/1.47	.011/0.28	.115/2.92	.105/2.67	.040/1.02	NOTE 7
75653-002	75653-005	22-26	.070/1.78	.065/1.65	.017/0.43	.139/3.53	.120/3.05	.050/1.27	OBSOLETE
75653-002LF	75653-005LF	22-26	.070/1.78	.065/1.65	.017/0.43	.139/3.53	.120/3.05	.050/1.27	NOTE 7
75653-003	75653-006	18-20	.104/2.64	.104/2.64	.021/0.53	.139/3.53	.120/3.05	.050/1.27	OBSOLETE
75653-003LF	75653-006LF	18-20	.104/2.64	.104/2.64	.021/0.53	.139/3.53	.120/3.05	.050/1.27	NOTE 7

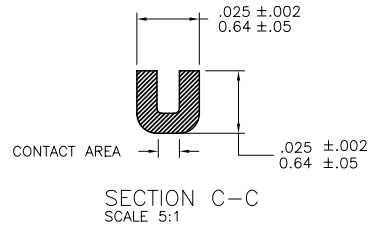
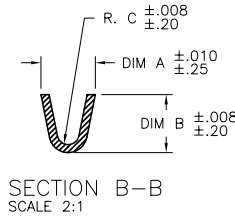
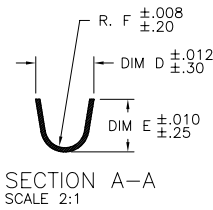

NOTES:

- PLATING: 100 $\mu$ "/2.54 $\mu$  SnPb MINIMUM PRE-PLATED (OBSOLETE)  
P/N WITH LF SUFFIX: 100 $\mu$ "/2.54 $\mu$  Sn MINIMUM PRE-PLATED
- FOR MANUFACTURING PURPOSES ONLY.
- PART MAY BE USED WITH MINI-LATCH HSG.
- APPLICABLE SPECIFICATIONS:  
A. BUS-12-098: PRODUCT SPECIFICATION  
B. TA-211: CRIMP SPECIFICATION
- PART NUMBERS WITH AN LF SUFFIX MEET EUROPEAN UNION DIRECTIVES AND OTHER COUNTRY REGULATIONS AS DESCRIBED IN GS-22-008.
- THIS PRODUCT IS NOT INTENDED TO BE EXPOSED TO MANUFACTURING SOLDER PROCESSES.
- THIS PRODUCT HAS 100% TIN PLATING IN THE INTERFACE AND HAS NOT BEEN TESTED FOR WHISKER GROWTH IN ALL INTERCONNECT ENVIRONMENTS.
- PACKAGE QUANTITY: 8000 PER REEL

mat'l. code 3/4 HD BRASS CDA NO. 260		surface	tolerance	projection	product family PV TERMINAL
lfr	ec'n no	dr	date	tolerances unless otherwise specified	title CTW MALE PIN
k				angles XX +01/XX-3 XXX +005/XX+13 XXXX +0020/XXX+051	INCH/MM
				0' ±2'	scale 4/1
		dr	S ROYER	1994-11-30	FCJ
		engr	T.HANNA	1994-11-30	
		chr	T.HANNA	1994-11-30	
		appd	T.HANNA	1994-11-30	dwg no 75653
sheet index	revision sheet				sheet 2 of 3 size A4 type CUSTOMER Drawing

Copyright FCJ



1 | 2

3 |

4

PRODUCT NUMBER  
SEE SHEET 2

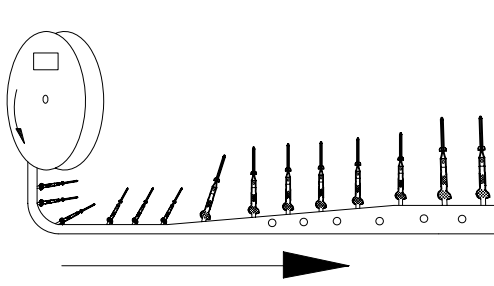

Unreeling Direction  
Left to Right Into  
Applicator

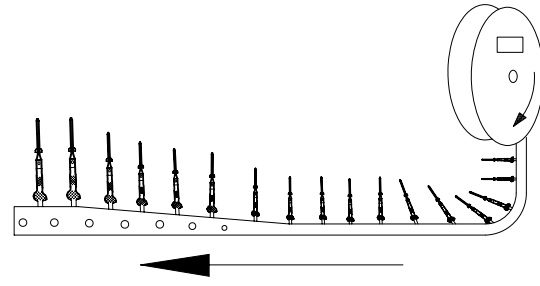

Unreeling Direction  
Right to Left Into  
Applicator

mat'l code 3/4 HD BRASS CDA NO. 260		surface	tolerance	projection	product family
itr	ecn no	dr	date		PV TERMINAL
tolerances unless otherwise specified				INCH/MM	title
k				scale 1:1	CTW MALE PIN
angles		XX ±0.1/XX±3			dwg no
or ±2'		XXX ±0.05/XXX±13			75653
dr	H. SUNDY	2004-02-17	sheet 3 of 3		size
engr	H. SUNDY	2004-02-17	A4		
chr	H. SUNDY	2004-02-17			
appd	H. SUNDY	2004-02-17			
sheet index	revision sheet				type CUSTOMER Drawing

form: A4mmXLC

1 |

2 |

3 |

4