

10 9 8 7 6 5 4 3 2 1

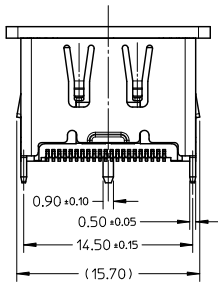
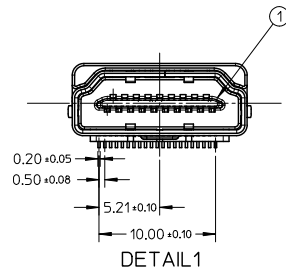
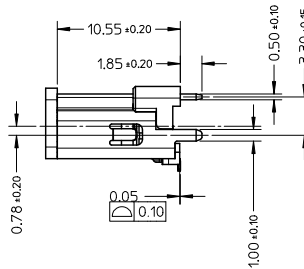
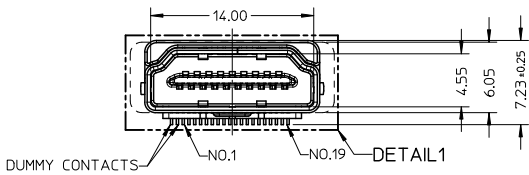
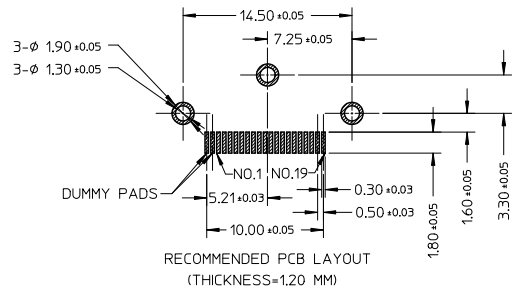
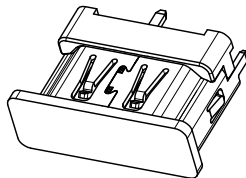
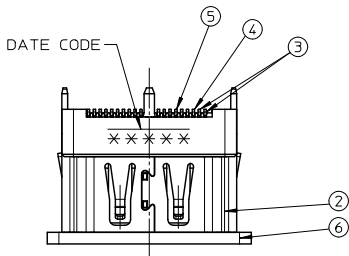

<b>NEW RELEASE</b> IEC NO: SH2010-0361 DRAWN BY: DRW:KWEI CHECKED BY: CHY:KWEI APPROVED BY: APPR:RZHANG DATE: 2010/03/22 DATE: 2010/03/22 DATE: 2010/05/13	DESCRIPTION REV: A	QUALITY SYMBOLS 	GENERAL TOLERANCES (UNLESS SPECIFIED)		DIMENSION STYLE MM ONLY		SCALE 3:1	DESIGN UNITS METRIC	THIRD ANGLE PROJECTION
		4 PLACES ± --- ± --- 3 PLACES ± --- ± --- 2 PLACES ± 0.15 ± --- 1 PLACE ± 0.15 ± ---	mm INCH	DRAWN BY: KWEI DATE: 2010/03/22	TITLE SALES DRAWING VERTICAL HDMI RECEPT.				
		ANGULAR ± --- °	DRAFT WHERE APPLICABLE MUST REMAIN WITHIN DIMENSIONS	CHECKED BY: KWEI DATE: 2010/03/22	MOLEX INCORPORATED				
		MATERIAL NO. SEE TABLE	APPROVED BY: RZHANG DATE: 2010/05/13	DOCUMENT NO. SD-48307-905	SHEET NO. 1 OF 2				

10	9	8	7	6	5	4	3	2	1	
	MOLEX P/N	PACKAGE TYPE	PACKAGE DRAWING	ITEM	DESCRIPTION	MATERIAL	FINISH			Q'TY
	48307-5012	TAPE REEL	PK-48307-905	⑥	PICK AND PLACE COVER	LIQUID CRYSTAL POLYMER, GLASS FILLED, UL94V-0, COLOR: BLACK	NONE			1
⑤				UPPER CONTACT	BRASS	GOLD FLASH PLATED, ON CONTACT AREA; TIN PLATED 3.048 MICROMETER MIN. ON SOLDER AREA, NICKEL UNDERPLATING OVERALL.			9	
④				LOWER CONTACT		TIN PLATED 3.048 MICROMETER MIN. ON SOLDER AREA, NICKEL UNDERPLATING OVERALL.			10	
③				DUMMY CONTACT		TIN PLATED 3.048 MICROMETER MIN. ON SOLDER AREA, NICKEL UNDERPLATING OVERALL.			2	
②				SHELL	BRASS	SOLDERABLE NICKEL PLATING OVERALL.			1	
①				HOUSING	LIQUID CRYSTAL POLYMER, GLASS FILLED, UL94V-0, COLOR: BLACK	NONE			1	

NOTES:

1. MATERIAL: SEE TABLE.
2. PLATING: SEE TABLE.
3. PACKAGING SPECIFICATION : SEE TABLE.
4. PRODUCT SPECIFICATION REFER TO PS-48307-901
5. DATE CODE: \*\*\*\*\*

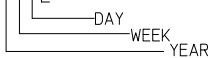

6. LEAD-FREE AND RoHS COMPLIANT PRODUCT

<b>NEW RELEASE</b> EC NO: SH2010-0361 DRW/KWEI 2010/03/22 CHK/KWEI 2010/03/22 APPR/RZHANG 2010/05/18 REV A	QUALITY SYMBOLS	GENERAL TOLERANCES (UNLESS SPECIFIED)	DIMENSION STYLE	SCALE	DESIGN UNITS	THIRD ANGLE PROJECTION																		
	$\nabla=0$ $\sphericalangle=0$	<table border="1"> <tr> <th></th> <th>mm</th> <th>INCH</th> </tr> <tr> <td>4 PLACES</td> <td>±.005</td> <td>±.0002</td> </tr> <tr> <td>3 PLACES</td> <td>±.008</td> <td>±.0003</td> </tr> <tr> <td>2 PLACES</td> <td>±.012</td> <td>±.0005</td> </tr> <tr> <td>1 PLACE</td> <td>±.015</td> <td>±.0006</td> </tr> <tr> <td>ANGULAR</td> <td colspan="2">±.0001°</td> </tr> </table>		mm	INCH	4 PLACES	±.005	±.0002	3 PLACES	±.008	±.0003	2 PLACES	±.012	±.0005	1 PLACE	±.015	±.0006	ANGULAR	±.0001°		MM ONLY	N/A	METRIC	
		mm	INCH																					
	4 PLACES	±.005	±.0002																					
3 PLACES	±.008	±.0003																						
2 PLACES	±.012	±.0005																						
1 PLACE	±.015	±.0006																						
ANGULAR	±.0001°																							
DESCRIPTION	DRAFT WHERE APPLICABLE MUST REMAIN WITHIN DIMENSIONS	<table border="1"> <tr> <td>DRAWN BY</td> <td>DATE</td> <td>TITLE</td> </tr> <tr> <td>KWEI</td> <td>2010/03/22</td> <td rowspan="2">SALES DRAWING VERTICAL HDMI RECEPT.</td> </tr> <tr> <td>CHECKED BY</td> <td>DATE</td> </tr> <tr> <td>KWEI</td> <td>2010/03/22</td> <td></td> </tr> <tr> <td>APPROVED BY</td> <td>DATE</td> <td></td> </tr> <tr> <td>RZHANG</td> <td>2010/05/13</td> <td></td> </tr> </table>	DRAWN BY	DATE	TITLE	KWEI	2010/03/22	SALES DRAWING VERTICAL HDMI RECEPT.	CHECKED BY	DATE	KWEI	2010/03/22		APPROVED BY	DATE		RZHANG	2010/05/13						
DRAWN BY	DATE	TITLE																						
KWEI	2010/03/22	SALES DRAWING VERTICAL HDMI RECEPT.																						
CHECKED BY	DATE																							
KWEI	2010/03/22																							
APPROVED BY	DATE																							
RZHANG	2010/05/13																							
		MATERIAL NO.	DOCUMENT NO.	SHEET NO.																				
		SEE TABLE	SD-48307-905	2 OF 2																				
		THIS DRAWING CONTAINS INFORMATION THAT IS PROPRIETARY TO MOLEX INCORPORATED AND SHOULD NOT BE USED WITHOUT WRITTEN PERMISSION																						