

| BLACK | | CLEAR | | MIN | MAX | RECOVERED | LENGTH FEET/METERS |
|-----------------|--------------------|-----------------|--------------------|-----------------|--------------|--------------|-----------------------|
| MATERIAL NUMBER | ENGINEERING NUMBER | MATERIAL NUMBER | ENGINEERING NUMBER | EXPANDED ID "D" | RECOVERED ID | WALL THK REF | |
| 192690008 | PF3-1/8-1BK | | | .125/3.018 | .040/1.02 | .038/0.97 | 4.0/1.2 |
| 192690013 | PF3-3/16-1BK | | | .187/4.75 | .060/1.52 | .045/1.14 | |
| | | 192690043 | PF3-3/16-1CL | .225/5.72 | .050/1.27 | .045/1.14 | |
| 192690018 | PF3-1/4-1BK | | | .250/6.35 | .080/2.03 | .047/1.19 | |
| | | 192690048 | PF3-1/4-1CL | .293/7.44 | .065/1.65 | .047/1.19 | |
| 192690023 | PF3-3/8-1BK | | | .375/9.53 | .120/3.05 | .050/1.27 | |
| | | 192690053 | PF3-3/8-1CL | .427/10.85 | .095/2.43 | .050/1.27 | |
| 192690028 | PF3-1/2-1BK | | | .500/12.70 | .157/3.99 | .055/1.40 | |
| | | 192690058 | PF3-1/2-1CL | .700/17.78 | .175/4.45 | .055/1.40 | |
| 192690033 | PF3-3/4-1BK | | | .750/19.05 | .230/5.84 | .065/1.65 | |
| 192690038 | PF3-1-1BK | | | 1.000/25.40 | .320/8.13 | .075/1.90 | |

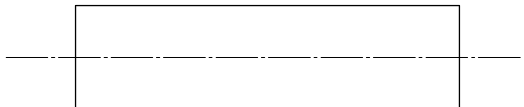
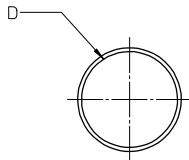

SALES DRAWING

- NOTES:
- MATERIAL: PVC WITH ADHESIVE LINER.
 - OTHER CUT LENGTHS ARE AVAILABLE.

| | | | | | | |
|--|---|---|---|---|----------------------|------------------------|
| NEW RELEASE EC NO: ETC2005-0060 DRW: BENDERLE 2004/09/28 CHKDR: DEROSS 2004/09/28 APPR: RDEROSS 2004/09/28 | QUALITY SYMBOLS | GENERAL TOLERANCES (UNLESS SPECIFIED) 4 PLACES ± --- ± --- 3 PLACES ± --- ± .010 2 PLACES ± 0.25 ± .02 1 PLACE ± 0.51 ± --- ANGULAR ± ---° | DIMENSION STYLE IN/MM | SCALE 1:1 | DESIGN UNITS INCH | THIRD ANGLE PROJECTION |
| | ▼=0 ▽=0 | | DRAWN BY BENDERLE DATE 2004/09/23 CHECKED BY R DEROSS DATE 2004/09/23 APPROVED BY R DEROSS DATE 2004/09/23 | TITLE PERMA-FIT PVC W/ADHESIVE LINER HEAT SHRINK TUBING 19269 SERIES | | |
| | DRAFT WHERE APPLICABLE MUST REMAIN WITHIN DIMENSIONS | SEE CHART | MATERIAL NO. SD-19269-001 DOCUMENT NO. | SHEET NO. 1 OF 1 | | |
| | THIS DRAWING CONTAINS INFORMATION THAT IS PROPRIETARY TO MOLEX INCORPORATED AND SHOULD NOT BE USED WITHOUT WRITTEN PERMISSION | | | | | |