

carclo
technical plastics

CARCLO TECHNICAL PLASTICS (SLOUGH) LTD.
111 BUCKINGHAM AVE, SLOUGH
SL1 4PF, ENGLAND
TEL: +44 1753 575011 FAX: +44 1753 811359
e-mail: design@ctpcoil.co.uk

GENERAL TOLERANCES (UNLESS STATED)

LINEAR	ANGULAR
X +/- 0.25	X +/- 1°
X.X +/- 0.1	X.X +/- 0.5°
X.XX +/- 0.05	X.XX +/- 0.1°

CUSTOMER
CARCLO

TITLE
**ELLIPTICAL BEAM
10MM SQUARE LED OPTIC**

DRAWN AJD	DATE 2-Apr-08
CHK'D	DATE
APP'D	DATE

SCALE 4:1	COIL PART No. 10415
---------------------	-------------------------------

SIZE A4	COIL DRG. No. 60518	SHEET 1 OF 2
-------------------	-------------------------------	------------------------

ISS.	DATE	E.C.N.	DESCRIPTION
1	2-Apr-08		FIRST ISSUE

© 2008 CARCLO
ALL DIMENSIONS IN mm

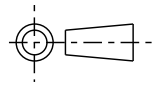

**PCB GLUE PAD AND ALIGNMENT HOLE
LAYOUT DIMENSIONS**

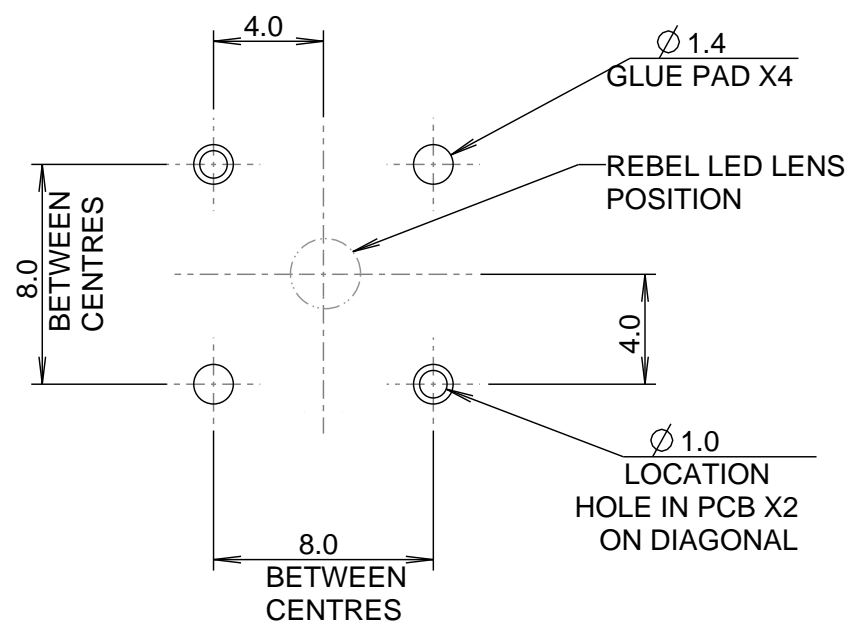

carclo
technical plastics

CARCLO TECHNICAL PLASTICS (SLOUGH)
111 BUCKINGHAM AVE, SLOUGH
SL1 4PF, ENGLAND
TEL: +44 1753 575011 FAX: +44 1753 811359
e-mail: design@carclo-optics.com

GENERAL TOLERANCES (UNLESS STATED)

LINEAR	ANGULAR
X +/- 0.25	X +/- 1°
X.X +/- 0.1	X.X +/- 0.5°
X.XX +/- 0.05	X.XX +/- 0.1°

CUSTOMER		
CARCLO		
TITLE		
ELLIPTICAL BEAM LED COLLIMATOR 10MM		
DRAWN	DATE	
AJD	2-Apr-08	
CHK'D	DATE	
APP'D	DATE	
SCALE	CARCLO PART No.	
5:1	10415	
SIZE	CARCLO DRG. No.	SHEET
A4	60518	2 OF 2