



## 2.4G DIPOLE 5DBI ANTENNA FOR SMA MALE REVERSE POLARITY

Part Number: LM252



Type: Dipole  
Frequency: 2400~2500MHz  
Gain: 5Dbi  
Polarization: Linear Vertical  
SWR:  $\leq 1.5:1$   
Impedance:  $50 \Omega$   
Base  
Connector: SMA Male Reverse Polarity  
Weight: 30g  
Size: H 200mm x W 13.7mm x D 13.7mm  
Certification: RoHS

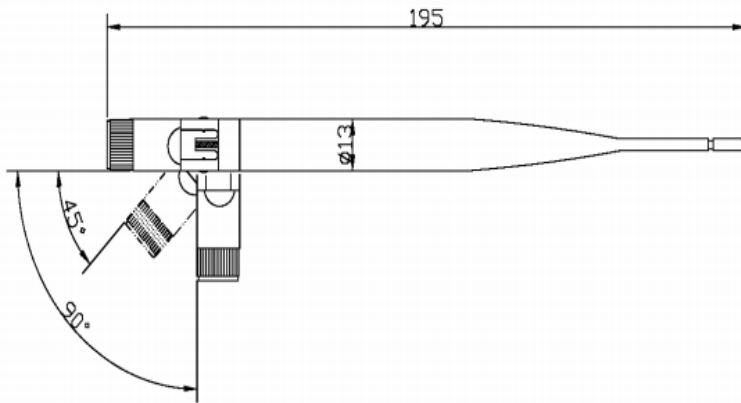

H-PLANE

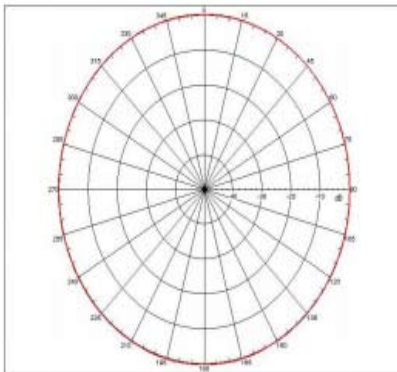

E-PLANE

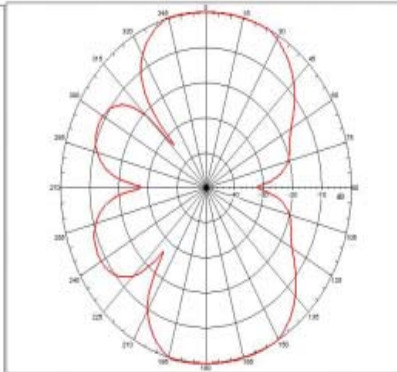

### Contact



#### Birmingham Office

LM Technologies Ltd  
Unit 10 Caroline Point  
62 Caroline Street  
Birmingham  
B3 1UF, UK.

Tel : 0121 200 1375  
Fax: 0870 112 7636

#### London Office

LM Technologies Ltd  
Unit 19 Spectrum House  
32-34 Gordon House Road  
London  
NW5 1LP, UK.

Tel : 0207 428 2647  
Fax: 0870 112 7636



## 2.4G DIPOLE 5DBI ANTENNA FOR SMA MALE REVERSE POLARITY

Part Number: LM252

