

DO NOT SCALE  
DIMENSIONS IN mm

METRIC

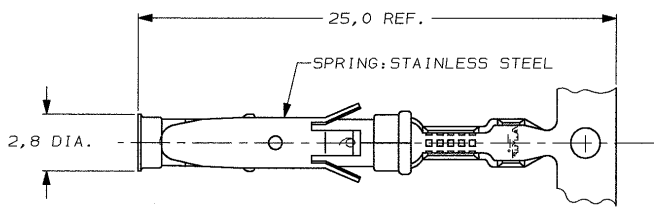

STRIP

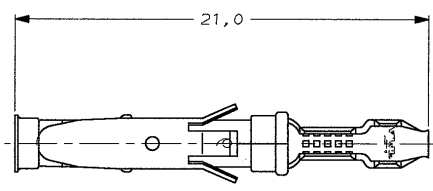

LOOSE-PIECE

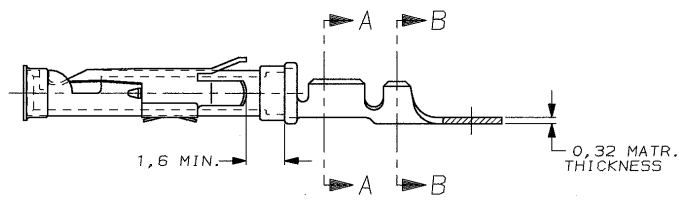

COLOR CODE: YELLOW

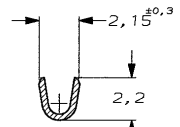

SECTION A-A

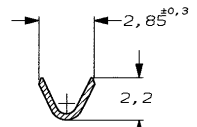

SECTION B-B

WIRE RANGE : 0,20-0,50 mm<sup>2</sup> (24-20 AWG)  
INSUL. RANGE : 1,1 -1,8 mm (.045-.070)

NOTES :

- 1 U.L. RECONIZED UNDER FILE E28476 VOL.VI SEC. I
- 2 FOR CRIMPDETAILS SEE AMP-SPEC. 114-19.000 .
- 3 MEETS PRODUCTSPECIFICATION 108-10042.
- 4 SPECIAL REEL WITH 200 PCS FOR REEL-FED HAND-TOOL
- 5 **OBSELETE PARTS: OBSELETE CIS STREAMLINING PER D.RENAUD/D.SINISI**
- 6 **OBSELETE**

NOTES	MATERIAL	THICKNESS	AREA
1	TIN	2,0 μm	ALL OVER
2	NICKEL GOLD TIV/LEAD	0,8 μm	ALL OVER CONTACT AREA BARREL
3	NICKEL GOLD	0,8 μm	ALL OVER CONTACT AREA
4	NICKEL GOLD	0,8 μm	ALL OVER
5	NICKEL GOLD	1,2 μm	ALL OVER CONTACT AREA
6	NICKEL GOLD	1,2 μm	ALL OVER
7	NICKEL SILVER TIV/LEAD	2,5 μm	ALL OVER CONTACT AREA BARREL
8	SILVER	1,5-2,5 μm	ALL OVER
9	NICKEL	0,76 μm	ALL OVER
10	SILVER	2,5 μm	ALL OVER
11	NICKEL BRIGHT TIN/LEAD	1,27 μm	ALL OVER
12	LUBRICATED		

1-163087-5	1-163087-4	1-163088-4	BRASS	SILVER
1-163087-4	1-163087-3	1-163088-4	BRASS	EL. TIN
1-163087-3	1-163087-2	1-163088-3	BRASS	BR. TIN/LEAD
5-163087-3	5-163087-2		BRASS	ECON. GOLD
5-163087-2	5-163087-1		BRASS	SEL. GOLD
5-163087-1	1-163087-2	1-163088-1	BRASS	EL. TIN
1-163087-2	1-163087-1		BRASS	GOLD
1-163087-1	1-163087-0	1-163088-0	BRASS	ECON. GOLD
163087-9	163087-8		BRASS	EL. TIN
163087-8	163087-7		BRASS	SEL. GOLD
163087-7	163087-6	163088-2	BRASS	SEL. GOLD
163087-6	163087-5	163088-1	BRASS	EL. TIN
163087-5	163087-4		BRASS	EL. TIN

DIRECTION OFF TOP OF REEL  
AMPOMATOR + MINI-APPL. 107-3-F16.1  
107-3-F16.2  
107-3-F16.4

OBSELETE  
OBSELETE

PARTNUMBER

CUSTOMER DRAWING FOR REFERENCE ONLY WILL NOT BE UPDATED

THIS DRAWING IS UNPUBLISHED RELEASED FOR PUBLICATION

**STE** TE Connectivity

NAME

SOCKET TYPE III CONTACT  
SIZE 16

AD2 REVISED PER ECO-11-005140 RK HMR 3MAY11

LTR. REVISION RECORD DR. CHK. DATE

DR. DATE: - - - - -

CHK. DATE: - - - - -

APP. DATE: - - - - -

DRG. No. 163087

REV. LTR. AD2

SHEET 1 OF 1

A3