



**Quick Reference**

**Search by part #**

Check distributor part inventory

**Products**

**Browse Products**

-By Device -

-By Product Line-

-Attachment Methods-

-Interface Materials-

-Accessories -

- Useful Links**
- [MSDS Safety Sheets](#)
  - [How to order?](#)
  - [Find Sales Rep](#)
  - [Find Distributor](#)
  - [Sample Request](#)
  - [Quote Request](#)
  - [Catalog Request](#)
  - [Building a part #](#)
  - [Part # Cross Ref](#)

**For use with TO -220 packages**

Printer friendly version

Part Number - 7020B -MT6

**RoHS Compliance PENDING**



**Mechanical Outline Drawing**

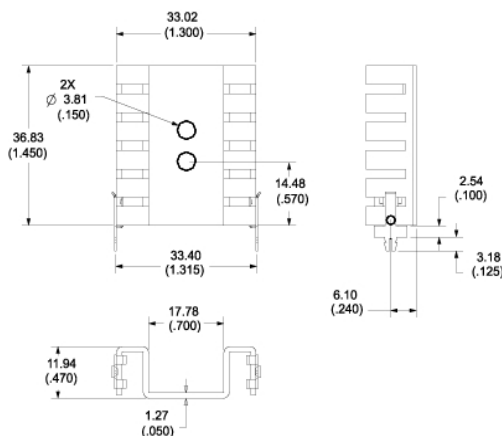

**Thermal Curves**

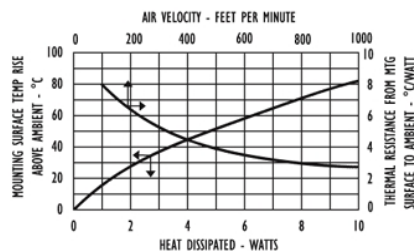

<b>Thermal Resistance</b>	8.70
---------------------------	------

Thermal resistance value is based on a 75°C rise in natural convection

**Product Information**

Part #	Description	Finish	Board Mounting
7020B - MT6	Narrow channel heat sink with folded back fins and mounting tabs	Black Anodize	<a href="#">View Hole Dimensions</a>
This non -electronic component is functionally unaffected by the normal soldering or reflow processes used for semiconductor circuits. The heat resistance time or heat resistance temperature is not applicable for the component.			

**Not Exactly what you need?**

We offer several options for those applications which require a more unique solution. For slight modifications of this part or other attachment options, finishes, and interface materials, contact your [local representative](#) . Challenge us with your thermal requirements - we can design custom solutions.