

# NTHD4502N

## Power MOSFET

30 V, 3.9 A, Dual N-Channel ChipFET™

### Features

- Planar Technology Device Offers Low  $R_{DS(on)}$  and Fast Switching Speed
- Leadless ChipFET Package has 40% Smaller Footprint than TSOP-6. Ideal Device for Applications Where Board Space is at a Premium.
- ChipFET Package Exhibits Excellent Thermal Capabilities. Ideal for Applications Where Heat Transfer is Required.
- Pb-Free Package is Available

### Applications

- DC-DC Buck or Boost Converters
- Low Side Switching
- Optimized for Battery and Low Side Switching Applications in Computing and Portable Equipment

### MAXIMUM RATINGS ( $T_J = 25^\circ\text{C}$ unless otherwise noted)

Parameter	Symbol	Value	Unit	
Drain-to-Source Voltage	$V_{DSS}$	30	V	
Gate-to-Source Voltage	$V_{GS}$	$\pm 20$	V	
Continuous Drain Current (Note 1)	Steady State	$T_A = 25^\circ\text{C}$	2.9	A
		$T_A = 85^\circ\text{C}$		
	$t \leq 5 \text{ s}$	$T_A = 25^\circ\text{C}$	3.9	
Power Dissipation (Note 1)	Steady State	$T_A = 25^\circ\text{C}$	1.13	W
		$t \leq 5 \text{ s}$	2.1	
Continuous Drain Current (Note 2)	Steady State	$T_A = 25^\circ\text{C}$	2.2	A
		$T_A = 85^\circ\text{C}$	1.6	
Power Dissipation (Note 2)	Steady State	$T_A = 25^\circ\text{C}$	0.64	W
Pulsed Drain Current	$t_p = 10 \mu\text{s}$	$I_{DM}$	12	A
ESD Capability (Note 3)	$C = 100 \text{ pF}$ , $R_S = 1500 \Omega$	ESD-HBM	125	V
Operating Junction and Storage Temperature	$T_J$ , $T_{STG}$	-55 to 150		$^\circ\text{C}$
Source Current (Body Diode)	$I_S$	2.5	A	
Lead Temperature for Soldering Purposes (1/8" from case for 10 s)	$T_L$	260		$^\circ\text{C}$

Maximum ratings are those values beyond which device damage can occur. Maximum ratings applied to the device are individual stress limit values (not normal operating conditions) and are not valid simultaneously. If these limits are exceeded, device functional operation is not implied, damage may occur and reliability may be affected.

1. Surface Mounted on FR4 Board using 1 in sq pad size (Cu area = 1.127 in sq [1 oz] including traces).
2. Surface Mounted on FR4 Board using the minimum recommended pad size (Cu area = 0.214 in sq).
3. ESD Rating Information: HBM Class 0.



ON Semiconductor®

<http://onsemi.com>

$V_{(BR)DSS}$	$R_{DS(on)}$ TYP	$I_D$ MAX
30 V	80 m $\Omega$ @ 10 V	3.9 A
	110 m $\Omega$ @ 4.5 V	

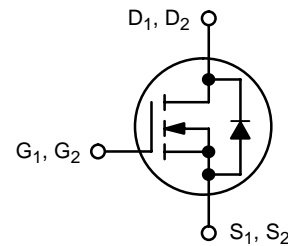

N-Channel MOSFET

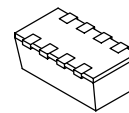

ChipFET  
CASE 1206A  
STYLE 2

### PIN CONNECTIONS

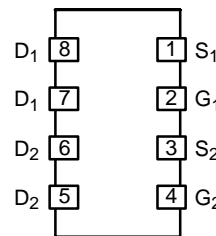

### MARKING DIAGRAM

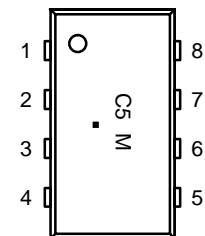

C5 = Specific Device Code  
M = Month Code  
▪ = Pb-Free Package

### ORDERING INFORMATION

Device	Package	Shipping†
NTHD4502NT1	ChipFET	3000/Tape & Reel
NTHD4502NT1G	ChipFET (Pb-Free)	3000/Tape & Reel

†For information on tape and reel specifications, including part orientation and tape sizes, please refer to our Tape and Reel Packaging Specification Brochure, BRD8011/D.

# NTHD4502N

## THERMAL RESISTANCE RATINGS

Parameter	Symbol	Max	Unit
Junction-to-Ambient – Steady State (Note 4)	$R_{\theta JA}$	110	°C/W
Junction-to-Ambient – $t \leq 5$ s (Note 4)	$R_{\theta JA}$	60	
Junction-to-Ambient – Steady State (Note 5)	$R_{\theta JA}$	195	

4. Surface Mounted on FR4 Board using 1 in sq pad size (Cu area = 1.127 in sq [1 oz] including traces).  
 5. Surface Mounted on FR4 Board using the minimum recommended pad size (Cu area = 0.214 in sq).

## ELECTRICAL CHARACTERISTICS ( $T_J = 25^\circ\text{C}$ unless otherwise noted)

Parameter	Symbol	Test Conditions	Min	Typ	Max	Units
-----------	--------	-----------------	-----	-----	-----	-------

### OFF CHARACTERISTICS

Drain-to-Source Breakdown Voltage	$V_{(BR)DSS}$	$V_{GS} = 0$ V, $I_D = 250$ $\mu$ A	30	36		V
Zero Gate Voltage Drain Current	$I_{DSS}$	$V_{GS} = 0$ V, $V_{DS} = 24$ V			1.0	$\mu$ A
		$V_{GS} = 0$ V, $V_{DS} = 24$ V, $T_J = 125^\circ\text{C}$			10	
Gate-to-Source Leakage Current	$I_{GSS}$	$V_{DS} = 0$ V, $V_{GS} = \pm 20$ V			$\pm 100$	nA

### ON CHARACTERISTICS (Note 6)

Gate Threshold Voltage	$V_{GS(TH)}$	$V_{GS} = V_{DS}$ , $I_D = 250$ $\mu$ A	1.0	1.65	3.0	V
Drain-to-Source On-Resistance	$R_{DS(on)}$	$V_{GS} = 10$ V, $I_D = 2.9$ A		78	85	m $\Omega$
		$V_{GS} = 4.5$ V, $I_D = 2.2$ A		105	140	
Forward Transconductance	$g_{FS}$	$V_{DS} = 15$ V, $I_D = 2.9$ A		3.8		S

### CHARGES AND CAPACITANCES

Input Capacitance	$C_{ISS}$	$V_{GS} = 0$ V, $f = 1.0$ MHz, $V_{DS} = 15$ V		140		pF
Output Capacitance	$C_{OSS}$			53		
Reverse Transfer Capacitance	$C_{RSS}$			16		
Input Capacitance	$C_{ISS}$	$V_{GS} = 0$ V, $f = 1.0$ MHz, $V_{DS} = 24$ V		135	250	pF
Output Capacitance	$C_{OSS}$			42	75	
Reverse Transfer Capacitance	$C_{RSS}$			13	25	
Total Gate Charge	$Q_{G(TOT)}$	$V_{GS} = 10$ V, $V_{DS} = 15$ V, $I_D = 2.9$ A		3.6	7.0	nC
Threshold Gate Charge	$Q_{G(TH)}$			0.3		
Gate-to-Source Charge	$Q_{GS}$			0.6		
Gate-to-Drain Charge	$Q_{GD}$			0.7		
Total Gate Charge	$Q_{G(TOT)}$	$V_{GS} = 4.5$ V, $V_{DS} = 24$ V, $I_D = 2.9$ A		1.9		nC
Threshold Gate Charge	$Q_{G(TH)}$			0.3		
Gate-to-Source Charge	$Q_{GS}$			0.6		
Gate-to-Drain Charge	$Q_{GD}$			0.9		

6. Pulse Test: Pulse Width  $\leq 300$   $\mu$ s, Duty Cycle  $\leq 2\%$ .

# NTHD4502N

## ELECTRICAL CHARACTERISTICS (continued) ( $T_J = 25^\circ\text{C}$ unless otherwise noted)

Parameter	Symbol	Test Conditions	Min	Typ	Max	Units
<b>DRAIN-SOURCE DIODE CHARACTERISTICS</b>						
Forward Diode Voltage	$V_{SD}$	$V_{GS} = 0\text{ V}, I_S = 2.5\text{ A}$		0.85	1.2	V
Reverse Recovery Time	$t_{RR}$	$V_{GS} = 0\text{ V}, I_S = 2.9\text{ A},$ $dI_S/dt = 100\text{ A}/\mu\text{s}$		8.6		ns
Reverse Recovery Charge	$Q_{RR}$			4.0		nC
Reverse Recovery Time	$t_{RR}$	$V_{GS} = 0\text{ V}, I_S = 1.0\text{ A},$ $dI_S/dt = 100\text{ A}/\mu\text{s}$		8.4		ns
Reverse Recovery Charge	$Q_{RR}$			4.0		nC

## SWITCHING CHARACTERISTICS (Note 7)

Turn-On Delay Time	$t_{d(ON)}$	$V_{GS} = 10\text{ V}, V_{DD} = 24\text{ V},$ $I_D = 1\text{ A}, R_G = 6\ \Omega$		6.5	12	ns
Rise Time	$t_r$			5.4	10	
Turn-Off Delay Time	$t_{d(OFF)}$			14.9	25	
Fall Time	$t_f$			1.8	5.0	
Turn-On Delay Time	$t_{d(ON)}$	$V_{GS} = 4.5\text{ V}, V_{DD} = 24\text{ V},$ $I_D = 2.9\text{ A}, R_G = 2.5\ \Omega$		7.8		ns
Rise Time	$t_r$			12.6		
Turn-Off Delay Time	$t_{d(OFF)}$			9.6		
Fall Time	$t_f$			2.8		

7. Switching characteristics are independent of operating junction temperatures.

TYPICAL PERFORMANCE CURVES

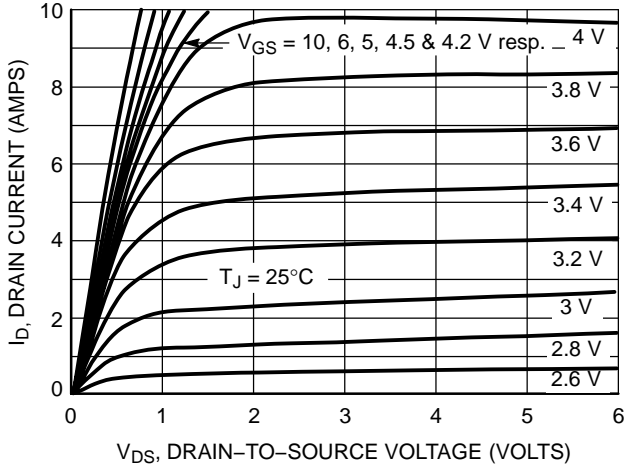

Figure 1. On-Region Characteristics

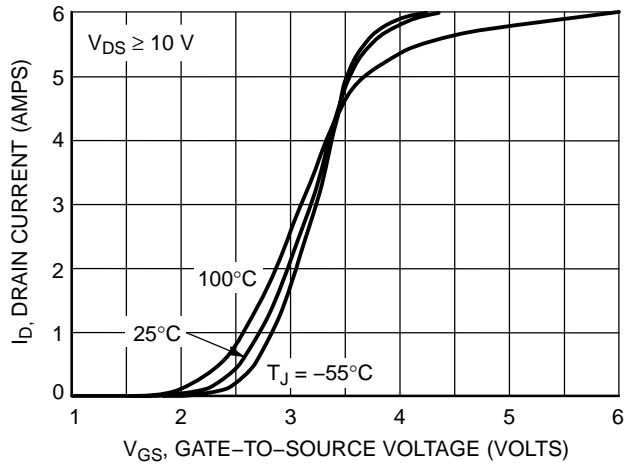

Figure 2. Transfer Characteristics

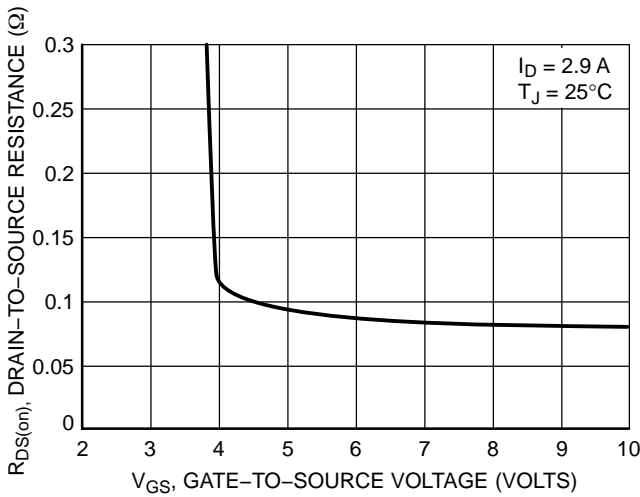

Figure 3. On-Resistance vs. Gate-to-Source Voltage

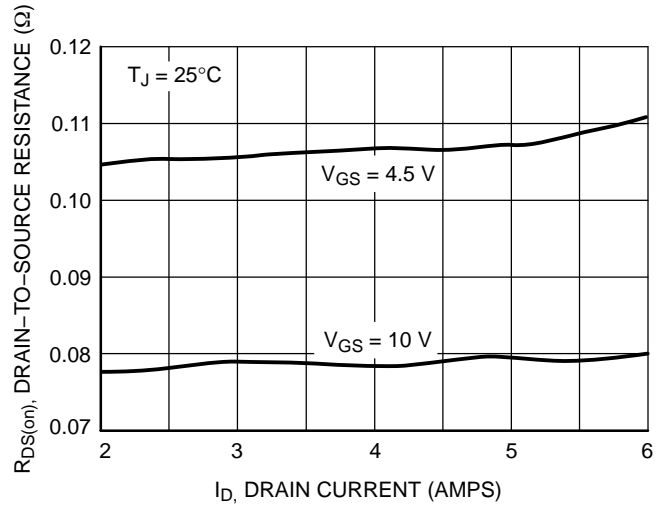

Figure 4. On-Resistance vs. Drain Current and Gate Voltage

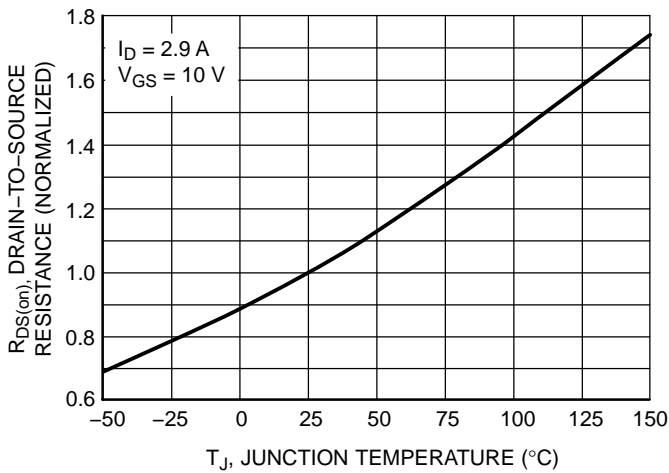

Figure 5. On-Resistance Variation with Temperature

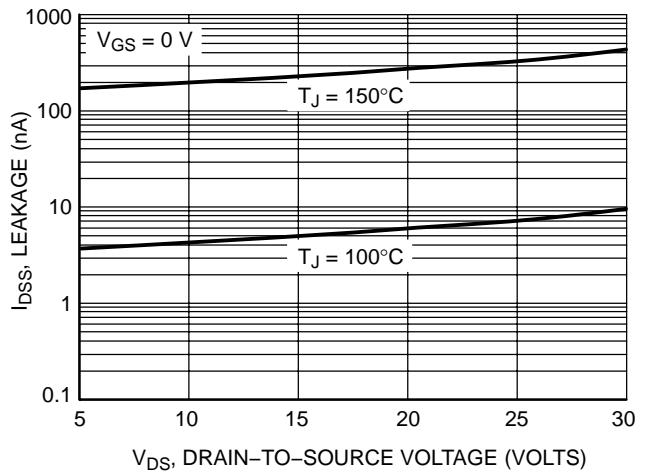
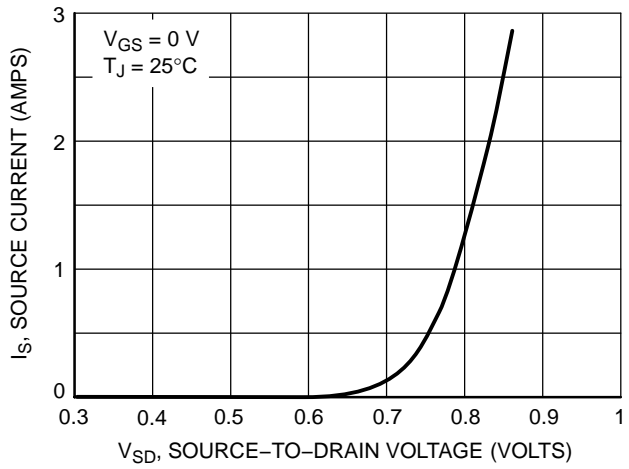
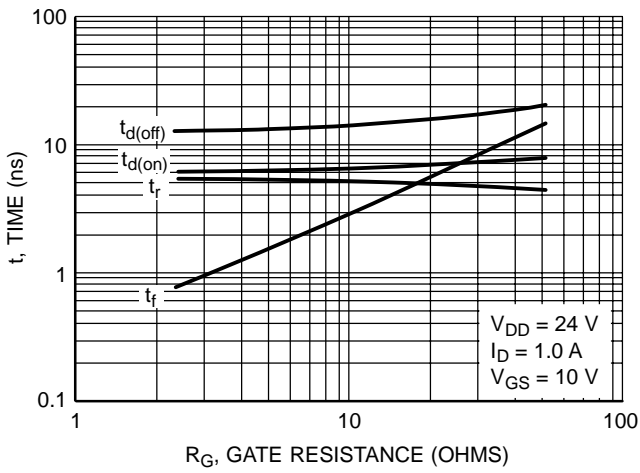
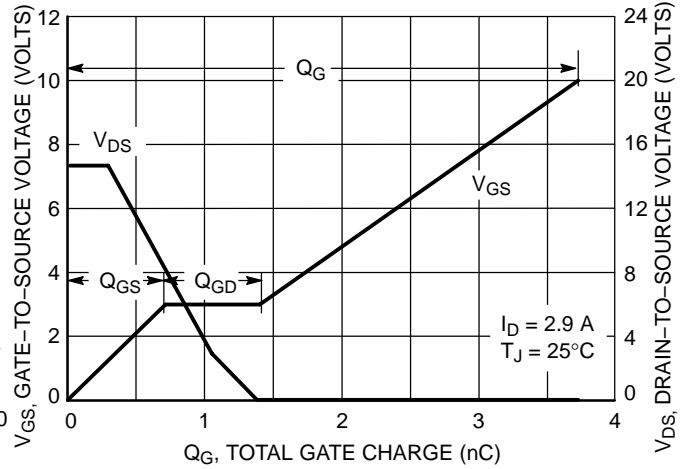
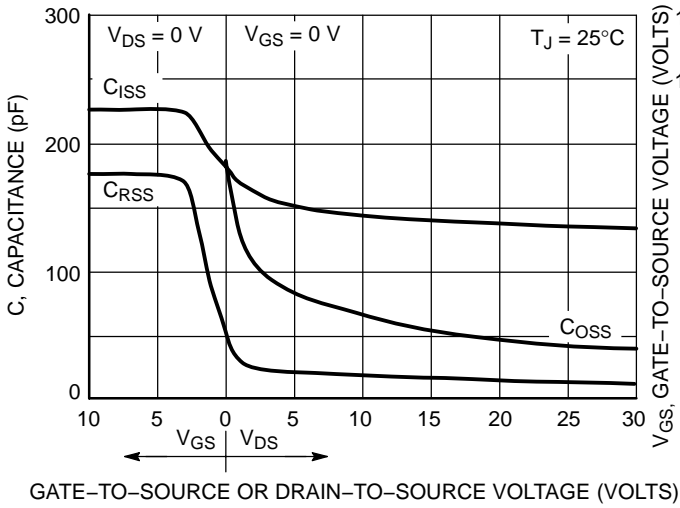

Figure 6. Drain-to-Source Leakage Current vs. Voltage

TYPICAL PERFORMANCE CURVES



# NTHD4502N

## PACKAGE DIMENSIONS

ChipFET™  
CASE 1206A-03  
ISSUE G

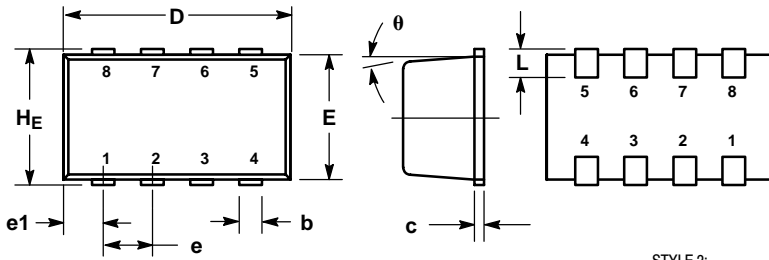

**NOTES:**

1. DIMENSIONING AND TOLERANCING PER ANSI Y14.5M, 1982.
2. CONTROLLING DIMENSION: MILLIMETER.
3. MOLD GATE BURRS SHALL NOT EXCEED 0.13 MM PER SIDE.
4. LEADFRAME TO MOLDED BODY OFFSET IN HORIZONTAL AND VERTICAL SHALL NOT EXCEED 0.08 MM.
5. DIMENSIONS A AND B EXCLUSIVE OF MOLD GATE BURRS.
6. NO MOLD FLASH ALLOWED ON THE TOP AND BOTTOM LEAD SURFACE.

DIM	MILLIMETERS			INCHES		
	MIN	NOM	MAX	MIN	NOM	MAX
A	1.00	1.05	1.10	0.039	0.041	0.043
b	0.25	0.30	0.35	0.010	0.012	0.014
c	0.10	0.15	0.20	0.004	0.006	0.008
D	2.95	3.05	3.10	0.116	0.120	0.122
E	1.55	1.65	1.70	0.061	0.065	0.067
e	0.65 BSC			0.025 BSC		
e1	0.55 BSC			0.022 BSC		
L	0.28	0.35	0.42	0.011	0.014	0.017
HE	1.80	1.90	2.00	0.071	0.075	0.079
θ	5° NOM			5° NOM		

- STYLE 2:  
PIN 1. SOURCE 1  
2. GATE 1  
3. SOURCE 2  
4. GATE 2  
5. DRAIN 2  
6. DRAIN 1  
7. DRAIN 1  
8. DRAIN 1

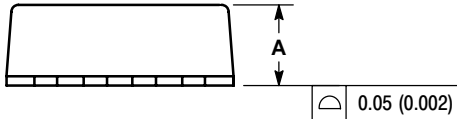

### SOLDERING FOOTPRINT\*

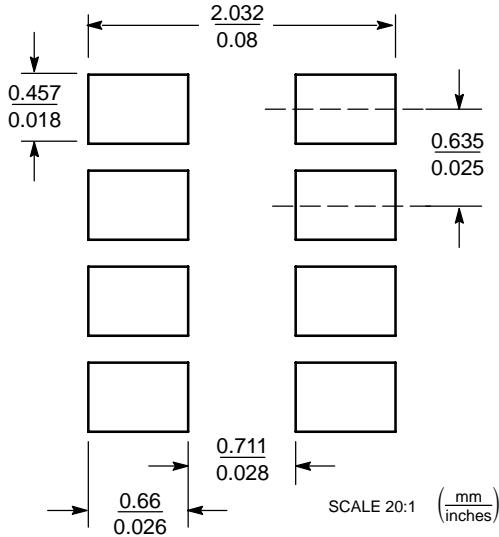

**Basic**

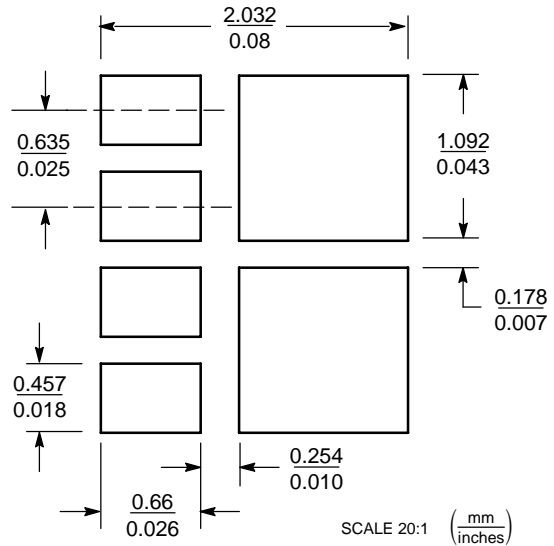

**Style 2**

\*For additional information on our Pb-Free strategy and soldering details, please download the ON Semiconductor Soldering and Mounting Techniques Reference Manual, SOLDERRM/D.

ChipFET is a trademark of Vishay Siliconix.

ON Semiconductor and are registered trademarks of Semiconductor Components Industries, LLC (SCILLC). SCILLC reserves the right to make changes without further notice to any products herein. SCILLC makes no warranty, representation or guarantee regarding the suitability of its products for any particular purpose, nor does SCILLC assume any liability arising out of the application or use of any product or circuit, and specifically disclaims any and all liability, including without limitation special, consequential or incidental damages. "Typical" parameters which may be provided in SCILLC data sheets and/or specifications can and do vary in different applications and actual performance may vary over time. All operating parameters, including "Typicals" must be validated for each customer application by customer's technical experts. SCILLC does not convey any license under its patent rights nor the rights of others. SCILLC products are not designed, intended, or authorized for use as components in systems intended for surgical implant into the body, or other applications intended to support or sustain life, or for any other application in which the failure of the SCILLC product could create a situation where personal injury or death may occur. Should Buyer purchase or use SCILLC products for any such unintended or unauthorized application, Buyer shall indemnify and hold SCILLC and its officers, employees, subsidiaries, affiliates, and distributors harmless against all claims, costs, damages, and expenses, and reasonable attorney fees arising out of, directly or indirectly, any claim of personal injury or death associated with such unintended or unauthorized use, even if such claim alleges that SCILLC was negligent regarding the design or manufacture of the part. SCILLC is an Equal Opportunity/Affirmative Action Employer. This literature is subject to all applicable copyright laws and is not for resale in any manner.

### PUBLICATION ORDERING INFORMATION

**LITERATURE FULFILLMENT:**  
Literature Distribution Center for ON Semiconductor  
P.O. Box 61312, Phoenix, Arizona 85082-1312 USA  
**Phone:** 480-829-7710 or 800-344-3860 Toll Free USA/Canada  
**Fax:** 480-829-7709 or 800-344-3867 Toll Free USA/Canada  
**Email:** orderlit@onsemi.com

**N. American Technical Support:** 800-282-9855 Toll Free  
USA/Canada

**Japan:** ON Semiconductor, Japan Customer Focus Center  
2-9-1 Kamimeguro, Meguro-ku, Tokyo, Japan 153-0051  
**Phone:** 81-3-5773-3850

**ON Semiconductor Website:** <http://onsemi.com>

**Order Literature:** <http://www.onsemi.com/litorder>

For additional information, please contact your local Sales Representative.

**NTHD4502N/D**