

Specification of Crystal Unit

| | | |
|-------|--------------------------------------|--|
| 1 | NDK PART NUMBER | NX5032GA (STD-CSU-1)(STD-CSU-2) NX5032GA |
| 5 | Type | |
| 6 | Electrical characteristics | * ATTACHED SHEETS 3 |
| 6.1 | Nominal frequency(F0) | 8MHZ to40MHZ |
| 6.2 | Overtone order | Fundamental |
| 6.3 | Adjustment tolerance | $\pm 50 \times 10^{-6}$ max. (+25 °C) |
| 6.4 | Tolerance over the temperature range | $\pm 150 \times 10^{-6}$ max. (-40~+150 °C) The reference temperature shall be +25 °C. |
| 6.5 | Equivalent resistance (R1) | *ATTACHED SHEETS 3 |
| 6.6 | Shunt Capacitance (C0) | NA |
| 6.7 | Motional Capacitance (C1) | 500 μ W max. |
| 7 | Measurement circuit | |
| 7.2 | Frequency measurement | π circuit |
| 7.1.1 | Measuring instrument | 8pF |
| 7.1.2 | Load capacitance(CL) | 10 μ W |
| 7.1.3 | Level of drive | |
| 7.2 | Equivalent resistance measurement | π circuit |
| 7.2.1 | Measuring instrument | Series |
| 7.2.2 | Load capacitance(CL) | 10 μ W |
| 7.2.3 | Level of drive | |

8 Dimension

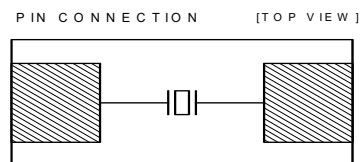
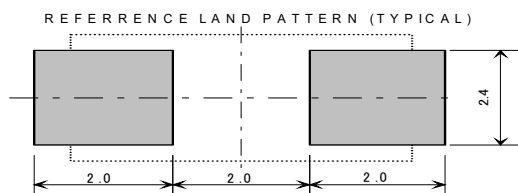
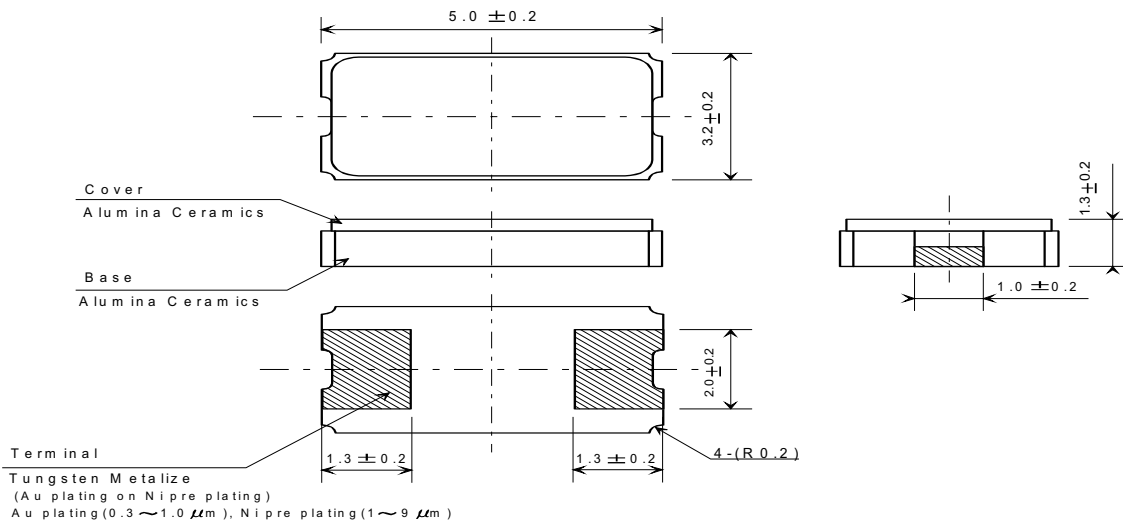

| Frequency(MHz) | CI(ESR) |
|----------------|---------|
| 8 | 300 |
| 10 | 120 ohm |
| 12 | 120 ohm |
| 16 | 120 ohm |
| 20 | 70 ohm |
| 40 | 50 ohm |