

5/8 M16* 3040 SERIES POWER OUTPUT VRS SENSORS

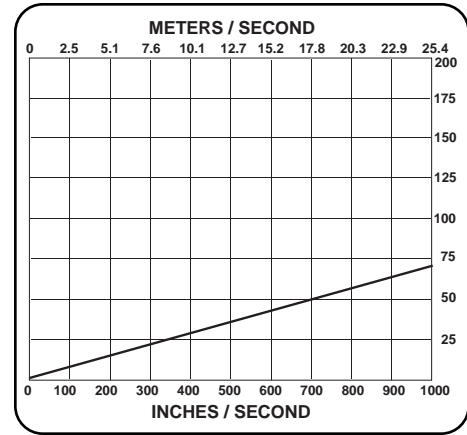

V P/P

FOR SPEED SENSING APPLICATIONS WHERE LARGER ACTUATORS CAN BE USED.
BEST FOR DRIVING LOW RESISTANCE LOADS AT LARGE AIR GAPS.

OPTIMUM ACTUATOR: 8 DP (Module 3.17) Ferrous Metal Gear

TEST CONDITION: B **VRS Tech Data**

GENERAL SPECIFICATIONS

OUTPUT VOLTAGE: 70V P-P min.
COIL RESISTANCE: 120 to 162 OHMS
POLE PIECE DIA.: .187" (4.75mm)
MIN. SURFACE SPEED: 15 IPS (.38 m/Sec) Typical

OPER. TEMP. RANGE: -67 to 250F (-55 to 120C)
INDUCTANCE: 85 mH max.
GEAR PITCH RANGE: 12 DP (Module 2.11) or Coarser
MAX. OPER. FREQ.: 40 KHz Typical

VIBRATION: Meets Mil-Std 202F Method 204D

SENSORS WITH 5/8-18 UNF-2A MOUNTING THREAD*,
MS3106 CONNECTOR

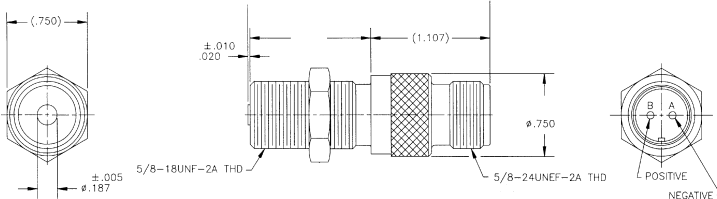

MODEL	THREAD LENGTH	WEIGHT
3040AN	1.1" (28 mm)	2.5 oz. (70 gr.)
3040AN25	2.5" (63 mm)	3.0 oz. (84 gr.)
3040AN30	3.0" (76 mm)	3.0 oz. (84 gr.)
3040AN40	4.0" (101 mm)	3.5 oz. (98 gr.)
3040AN50	5.0" (127 mm)	4.5 oz. (128 gr.)

Mates with 41010(VR) Connector or CA210 Cable Assembly

SENSORS WITH 5/8-18 UNF-2A MOUNTING THREAD*,
24" (300 mm) LEADS

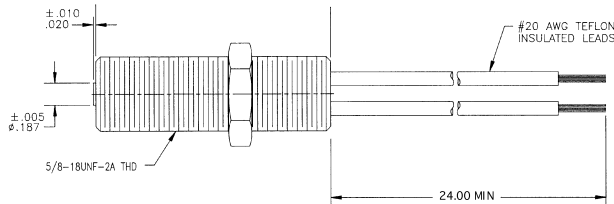

MODEL	THREAD LENGTH	WEIGHT
3040S20	2.0" (50 mm)	2.5 oz. (70 gr.)
3040S30	3.0" (76 mm)	3.0 oz. (84 gr.)

SENSORS WITH 5/8-18 UNF-2A MOUNTING THREAD*,
1/2-14 NPT CONDUIT MOUNT, 24" (300 mm) LEADS

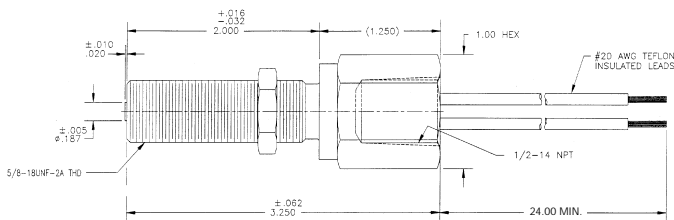

MODEL	THREAD LENGTH	WEIGHT
3040H20	2.0" (50 mm)	5.0 oz. (140 gr.)

SENSORS WITH 5/8-18 UNF-2A MOUNTING THREAD*,
MS3106 CONNECTOR, .312" THREAD RELIEF

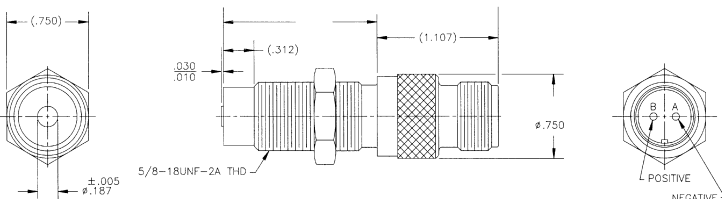

MODEL	THREAD LENGTH	WEIGHT
3040A	1.4" (35 mm)	2.5 oz. (70 gr.)
3040A25	2.5" (63 mm)	3.0 oz. (84 gr.)

Mates with 41010(VR) Connector or CA210 Cable Assembly

*For M16 x 1.5 6g Mounting Thread Versions, add "M" as the first character of the model number.
Contact Invensys/Electro for availability and pricing.

Invensys Sensor Systems / Electro Corporation, U.S.A.

Tel. 941-355-8411

www.speed-position.invensys.com

Fax 941-355-3120



ISO
9001

Certificate Number: FM37434