

## KVR800D2D8P6/1G

### 1GB 128M x 72-Bit DDR2-800

### CL6 Registered w/Parity 240-Pin DIMM

#### DESCRIPTION:

This document describes ValueRAM's 128M x 72-bit 1GB (1024MB) DDR2-800 CL6 SDRAM (Synchronous **DRAM**) "dual rank" Registered w/Parity memory module. The components on this module include eighteen 64M x 8-bit DDR2-800 SDRAM in FBGA packages. This 240-pin DIMM uses gold contact fingers and requires +1.8V. The electrical and mechanical specifications are as follows:

#### FEATURES:

✓ Clock Cycle Time (tCK) CL=6	2.5ns (min.) / 8ns (max.)
✓ Row Cycle Time (tRC)	60ns (min.)
✓ Refresh to Active/Refresh Command Time (tRFC)	105ns
✓ Row Active Time (tRAS)	45ns (min.) / 70,000ns (max.)
✓ Single Power Supply of	+1.8V (+/- .1V)
✓ Power	3.267 W (operating)
✓ UL Rating	94 V - 0

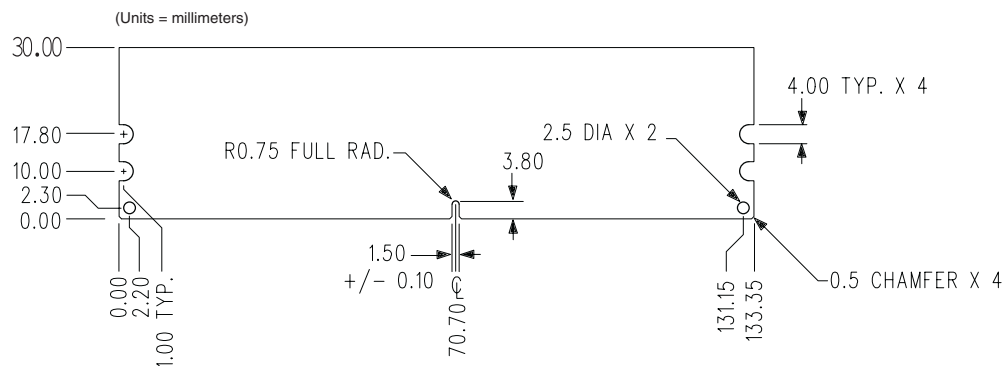
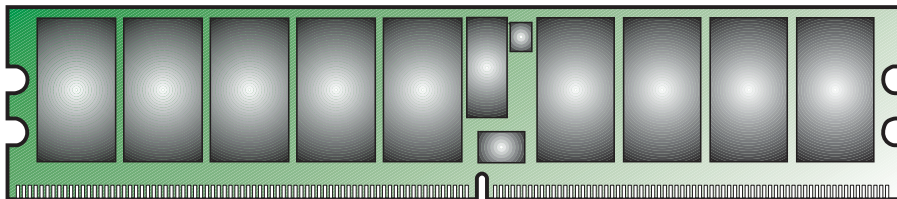
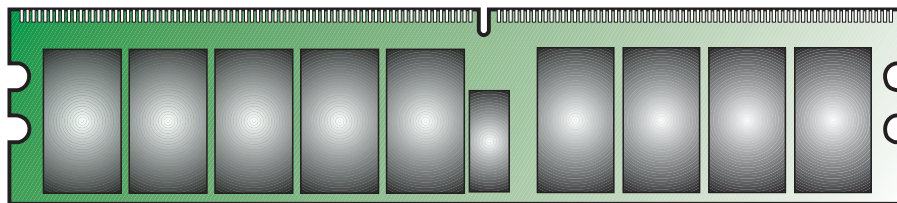

Figure 1: KVR800D2D8P5/1G 240-Pin DIMM