

4

3

2

1

THIS DRAWING IS UNPUBLISHED. RELEASED FOR PUBLICATION. BY TYCO ELECTRONICS CORPORATION. ALL RIGHTS RESERVED.

LOC	DIST	REVISIONS		
P	LTR	DESCRIPTION	DATE	BY
GP	00			
B		REVISED PER ECO-08-007327	02OCT08	BM WM

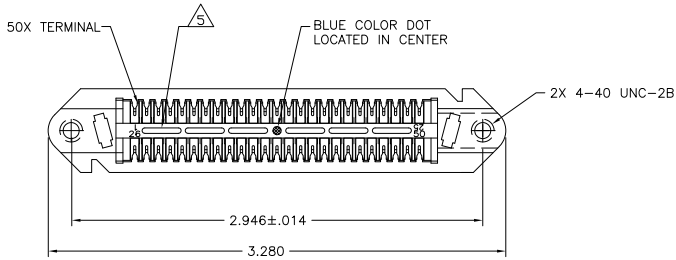

1. THE CONTACT SURFACES OF THE TERMINALS ARE COATED WITH LUBRICANT.
 2. ALL DIMENSIONS SHOWN ARE MAXIMUM UNLESS OTHERWISE SPECIFIED.
- 3 MATERIAL:
 HOUSING: POLYPHENYLENE, COLOR: BLACK.
 TERMINAL: PHOSPHOROUS BRONZE PLATED WITH .000030 MIN GOLD OR GOLD FLASH OVER PALLADIUM NICKEL PLATE, .000030 MIN TOTAL ON MATING SURFACE. .000050 MIN NICKEL UNDERPLATE OVER ENTIRE TERMINAL.
 LATCH: ZINC PLATED CARBON STEEL.
4. WIRE SIZE: 24 & 26 AWG SOLID OR 24 AWG 7 STRANDS OF COPPER CONDUCTORS. MAXIMUM INSULATION DIAMETER OF .045 IS ACCEPTABLE FOR MOST APPLICATIONS.
- 5 CORING MAY OR MAY NOT APPEAR AND IS AT THE DISCRETION OF AMP.

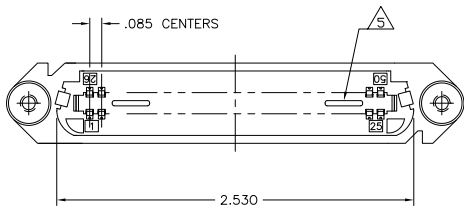
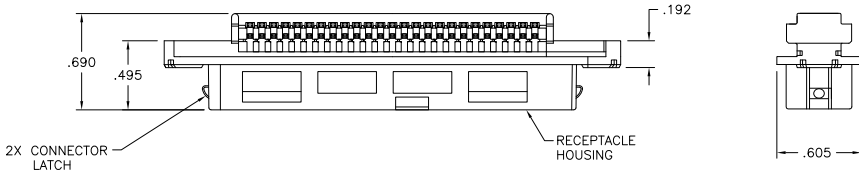

5553921-1
PART NUMBER

THIS DRAWING IS A CONTROLLED DOCUMENT.		DR. S. MCMASTER	05OCT08	Tyco Electronics Corporation	
DIMENSIONS:		CHK. W. MILLHIMES	05OCT08	Harrisburg, PA 17105-3608	
INCHES		APP'D. W. MILLHIMES	05OCT08	NAME	
OTHER DIMENSIONS:		PRODUCT SPEC		APPLICATION SPEC	
0 PLC		SIZE		CASE CODE	
1 PLC		A2		00779	
2 PLC		C=		5553921	
3 PLC		RESTRICTED TO		-	
4. PLG		CUSTOMER DRAWING		SCALE	
ANGLES		2:1		SHEET	
FINISH		1 of 1		REV	
MATERIAL		3		B	

AMP 1471-9 REV 31MM0200

5553921

A