

Filter Type SFCDL

Feedthrough EMI Filter Datasheet (12-32 UNEF Thread : 6.35mm Hexagonal Head)

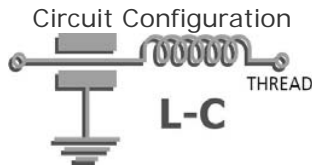

Dimensions mm (inches)

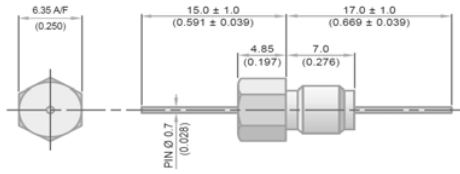

13-32 UNEF Class 2A Thread

Electrical Details	
Electrical Configuration	C Filter
Capacitance Measurement	@ 1000hr Point
Current Rating	10A
Insulation Resistance (IR)	10GΩ or 1000ΩF
Temperature Rating	-55°C to +125°C
Ferrite Inductance (Typical)	500nH
Mechanical Details	
Head A/F	6.35mm (0.250")
Nut A/F	7.92mm (0.312")
Washer Diameter	11.35mm (0.447")
Mounting Torque	0.6Nm (5.31lbf in) max. if using nut 0.3Nm (2.65lbf in) max. into tapped hole
Mounting Hole Diameter	5.7mm ± 0.1 (0.224" ± 0.004")
Max. Panel Thickness	3.9mm (0.154")
Weight (Typical)	1.8g (0.06oz)
Finish	Silver plate on copper undercoat

Product Code	Hardware	Capacitance ±20% UOS	Dielectric	Rated Voltage (dc)	DWV (dc)	Typical Insertion Loss (db)					
						0.01MHz	0.1MHz	1MHz	10MHz	100MHz	1GHz
*SFCDL5000100ZC	0 = No hardware supplied 1 = supplied with standard nut and wavy washer Other options available - please contact factory	10pF -20% / +80%	C0G	500	750						6
SFCDL5000150ZC		15pF -20% / +80%	C0G	500	750						9
SFCDL5000220ZC		22pF -20% / +80%	C0G	500	750						12
SFCDL5000330ZC		33pF -20% / +80%	C0G	500	750					1	15
*SFCDL5000470ZC		47pF -20% / +80%	C0G	500	750					2	19
*SFCDL5000680MC		68pF	C0G	500	750					4	20
*SFCDL5000101MC		100pF	C0G	500	750					7	24
SFCDL5000151MC		150pF	C0G	500	750					10	27
*SFCDL5000221MC		220pF	C0G	500	750					12	30
*SFCDL5000331MC		330pF	C0G	500	750				1	16	34
*SFCDL5000471MX		470pF	†X7R	500	750				2	19	38
SFCDL5000681MX		680pF	†X7R	500	750				3	22	41
*SFCDL5000102MX		1.0nF	X7R	500	750				6	25	44
SFCDL5000152MX		1.5nF	X7R	500	750				9	29	48
*SFCDL5000222MX		2.2nF	X7R	500	750				12	31	51
SFCDL5000332MX		3.3nF	X7R	500	750				15	35	54
*SFCDL5000472MX		4.7nF	X7R	500	750			1	18	39	57
SFCDL5000682MX		6.8nF	X7R	500	750			2	21	41	60
*SFCDL5000103MX		10nF	X7R	500	750			4	23	43	63
*SFCDL5000153MX		15nF	X7R	500	750			7	27	46	66
*SFCDL5000223MX		22nF	X7R	500	750			10	30	48	68
SFCDL5000333MX		33nF	X7R	500	750			13	34	50	70
*SFCDL5000473MX		47nF	X7R	500	750		1	17	37	51	>70
SFCDL5000683MX		68nF	X7R	500	750		2	20	40	55	>70
*SFCDL5000104MX		100nF	X7R	500	750		4	22	44	60	>70
SFCDL5000154MX		150nF	X7R	500	750		7	25	47	62	>70
*SFCDL2000224MX		220nF	X7R	200	500		10	29	49	66	>70
SFCDL1000334MX		330nF	X7R	100	250		13	33	53	68	>70
*SFCDL1000474MX		470nF	X7R	100	250		1	16	35	56	>70
SFCDL0500684MX		680nF	X7R	50	125		2	19	38	58	>70

* Recommended values

† Also available in COG

Ordering Information

Type	Case Style	Thread	Electrical configuration	Voltage (dc)	Capacitance in picofarads (pF)	Capacitance Tolerance	Dielectric	Nuts & washers
SF	C	D	L	500	010Z	M	X	0
Syfer Filter	6.35mm Hex Head	13-32 UNEF	L = L-C Filter	050 = 50V 100 = 100V 200 = 200V 500 = 500V	First digit is 0. Second and third digits are significant figures of capacitance code. The fourth digit is the number of zeros following. Examples: 0101 = 100pF 0332 = 3300pF	M = ±20% Z = -20+80%	C = COG/NPO X = X7R	0 = Without 1 = With

Note: The addition of a 4-digit numerical suffix code can be used to denote changes to the standard part.

Options include for example: change of pin length / custom body dimensions or threads / alternative voltage rating / non-standard intermediate capacitance values / test requirements.

Please refer specific requests to the factory.



Syfer Technology Ltd.
Old Stoke Road, Arminghall
Norwich, Norfolk, NR14 8SU
United Kingdom

SFCDL Issue 2 (P104775)

Tel: +44 1603 723300 | Email sales@syfer.co.uk | www.syfer.com