

Filter Type
SFBCP

Feedthrough EMI Filter Datasheet

(8-32 UNC Thread : 4.75mm Hexagonal Head)

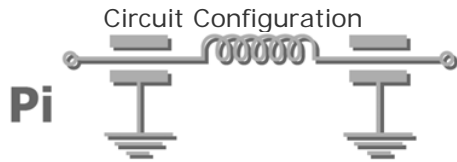

Dimensions mm (inches)

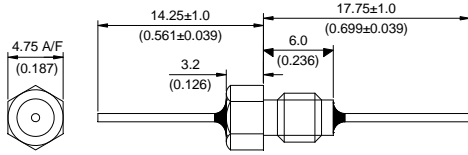

8-32 UNC Class 2A Thread

| Electrical Details | |
|------------------------------|--|
| Electrical Configuration | Pi Filter |
| Capacitance Measurement | @ 1000hr Point |
| Current Rating | 10A |
| Insulation Resistance (IR) | 10GΩ or 1000ΩF |
| Temperature Rating | -55°C to +125°C |
| Ferrite Inductance (Typical) | 75nH |
| Mechanical Details | |
| Head A/F | 4.75mm (0.187") |
| Nut A/F | 6.35mm (0.250") |
| Washer Diameter | 8mm (0.315") |
| Mounting Torque | 0.5Nm (4.42lbf in) max. if using nut 0.25Nm (2.21lbf in) max. into tapped hole |
| Mounting Hole Diameter | 4.4mm ± 0.1 (0.173" ± 0.004") |
| Max. Panel Thickness | 2.9mm (0.114") |
| Weight (Typical) | 1.2g (0.04oz) |
| Finish | Silver plate on copper undercoat |

| Product Code | Hardware (Nuts & Washers etc.) | Capacitance (-20%+80%) | Dielectric | Rated Voltage (dc) | DWV (dc) | Typical Insertion Loss (db) | | | | | |
|----------------|--|------------------------|------------|--------------------|----------|-----------------------------|--------|------|-------|--------|------|
| | | | | | | 0.01MHz | 0.1MHz | 1MHz | 10MHz | 100MHz | 1GHz |
| SFBCP5000200ZC | 0 = No hardware supplied 1 = supplied with standard nut and wavy washer Other options available - please contact factory | 20pF | COG | 500 | 750 | | | | | 1 | 11 |
| SFBCP5000440ZC | | 44pF | COG | 500 | 750 | | | | | 3 | 19 |
| SFBCP5000940ZC | | 94pF | COG | 500 | 750 | | | | | 6 | 25 |
| SFBCP5000201ZC | | 200pF | COG | 500 | 750 | | | | | 11 | 33 |
| SFBCP5000441ZC | | 440pF | COG | 500 | 750 | | | | 2 | 18 | 45 |
| SFBCP5000941ZX | | 940pF | X7R | 500 | 750 | | | | 5 | 25 | 60 |
| SFBCP5000202ZX | | 2nF | X7R | 500 | 750 | | | | 10 | 40 | 70 |
| SFBCP5000442ZX | | 4.4nF | X7R | 500 | 750 | | | 1 | 17 | 47 | >70 |
| SFBCP5000942ZX | | 9.4nF | X7R | 500 | 750 | | | 4 | 24 | 60 | >70 |
| SFBCP2000203ZX | | 20nF | X7R | 200 | 500 | | | 9 | 28 | 70 | >70 |
| SFBCP1000443ZX | | 44nF | X7R | 100 | 250 | | 0 | 14 | 42 | >70 | >70 |
| SFBCP0500943ZX | | 94nF | X7R | 50 | 125 | | 2 | 18 | 57 | >70 | >70 |

Ordering Information

| Type | Case Style | Thread | Electrical configuration | Voltage (dc) | Capacitance in picofarads (pF) | Capacitance Tolerance | Dielectric | Hardware |
|--------------|-----------------|----------|--------------------------|---|---|-----------------------|------------------------|-------------------------|
| SF | B | C | P | 050 | 0943 | Z | X | 0 |
| Syfer Filter | 4.75mm Hex Head | 8-32 UNC | P = Pi Filter | 050 = 50V 100 = 100V 200 = 200V 500 = 500V | First digit is 0. Second and third digits are significant figures of capacitance code. The fourth digit is the number of zeros following. Examples: 0201 = 200pF 0943 = 94000pF | Z = -20+80% | C = COG/NPO X = X7R | 0 = Without 1 = With |

Note: The addition of a 4-digit numerical suffix code can be used to denote changes to the standard part.

Options include for example: change of pin length / custom body dimensions or threads / alternative voltage rating / non-standard intermediate capacitance values / test requirements.

Please refer specific requests to the factory.

