

**Dimensions (In.)**

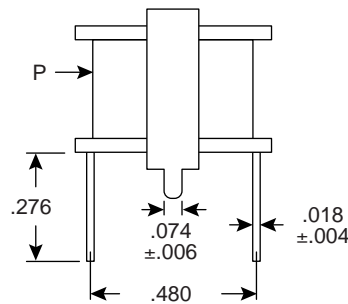
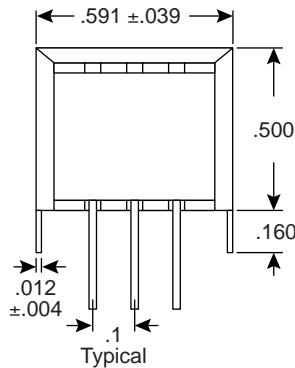

**Specifications:**

- Core type/size: EI-14
- Impedance variation: ±10% @ 1KHz
- D.C. resistance tolerance: ±15%
- Insulation: >10MΩ @ 100VDC
- Breakdown voltage: 100VAC HIPOT for 1 minute
- Maximum output: 75mW
- Frequency response: ±3dB, 300Hz-3.4KHz @ 1KHz 0dB
- Waxing: vacuum treatment
- Other: can be water washed with water temperature @ <20°C.
- PC leads are soft metal wire and can be adjusted to fit a variety of applications.

Mouser Stock No.	Impedance (Ω)		Resistance (Ω)		Turns	
	Pri.	Sec.	Pri.	Sec.	Pri.	Sec.
42TL001	500	8	35	1.0	500	60
42TL003	1.2K	8	80	1.0	810	80
42TL004	200	8	12	1.0	400	60
42TL008	800	8	40	1.0	510	60
42TL012	10K	5K	900	500	2500	1700
42TL013	1K	8	60	1.0	756	60
42TL016	600	600	65	55	680	680
42TL017	20K	600	693	66	2840	320
42TL018	7K	10K	400	385	1720	1460
42TL019	10K	600	450	100	2000	390
42TL021	4K	600	148	64	1320	440
42TL022	1.5K	600	125	55	930	540
42TL023	300	600	30	35	400	530
42TL024	10K	500	530	136	2300	490
42TL025	17K	1K	693	146	2800	460
42TL026	500	16	43	1.9	540	96
42TL027	1K	2K	130	140	920	470
42TL030	100	100	10.9	9.10	250	250
42TL218	10K	10K	715	583	1840	1840
42TL002	10K	2K	500	200	2100	600
42TL006	20K	1K	600	110	2700	410
42TL009	500	500	40	38	510	490
42TL011	1.5K	500	120	55	940	520
42TL020	600	900	36	50	520	600
42TL031	600	100	42.8	20.2	630	254