

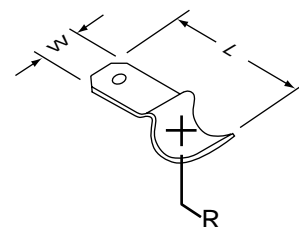

Specialty Separable Connectors

7M-250

Male Fuse-Clip Adapter, Non-Insulated



Data Sheet

Product Number	Male Tab Width (W') x Thickness	L	Radius R
7M-250	0.250 x 0.030	0.77	0.125

Specifications

Maximum Operating Temp.: 482°F (250°C)
Maximum Current: 30 Amps
Terminal Material: Brass
Terminal Plating: None

WARNING

Turn power off before installing or removing terminal. All electrical work should be done according to appropriate electrical codes.

Engineering Specification

Adapters shall, electrically and mechanically, connect to one or more crimp type, separable connectors in a separable, reusable manner. They may also have a tongue portion which is flat with a central opening for mounting around a stud, or curved for mounting alongside a fuse in its holder.

The Adapter line shall offer variations in separable connections, Male Quick-Slide (0.250" wide), Female Quick-Slide (0.250" wide), Male Snap Plug (0.156" dia.), Female Snap Receptacle (0.156" and 0.180" dia.), and variations in stud mountings, ring tongue (6, 8, 10 stud), and rectangular tongue (0.250 x 0.032").

The Male-Fuse Clip Adapter shall be 0.030" thick brass, having a 0.250" wide Male Quick-Slide Tab connected to an extending curve and suitable for fitting between the fuse metal end cap and the mounting clip.

The Separable Connection formed by the Adapter and the mating connector(s) may require a suitable strain relief to prevent accidental separation.

3M is a trademark of 3M

IMPORTANT NOTICE

Before using this product, you must evaluate it and determine if it is suitable for your intended application. You assume all risks and liability associated with such use.

Warranty; Limited Remedy; Limited Liability. This product will be free from defects in material and manufacture as of the date of purchase. **3M MAKES NO OTHER WARRANTIES INCLUDING, BUT NOT LIMITED TO, ANY IMPLIED WARRANTY OF MERCHANTABILITY OR FITNESS FOR A PARTICULAR PURPOSE.** If this product is defective within the warranty period stated above, your exclusive remedy shall be, at 3M's option, to replace or repair the 3M product or refund the purchase price of the 3M product. **Except where prohibited by law, 3M will not be liable for any loss or damage arising from this 3M product, whether direct, indirect, special, incidental or consequential regardless of the legal theory asserted.**

3M

Electrical Products Division

6801 River Place Blvd.
Austin, TX 78726-9000
<http://www.3M.com/elpd>

Litho in USA.
© 3M 2002 78-8126-0903-6-A