

<b>PART NUMBER</b>	<b>LEAD FREE VERSION</b>
7312E0525S01	7312E0525S01LF

**PACKAGING:**

READER: Std. Tray  
 COVER: Separately in SACHET 400x600  
 240cnrs/box, 120cnrs/sachet

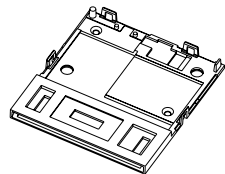

SCALE 4:5

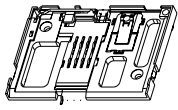

SCALE 4:5

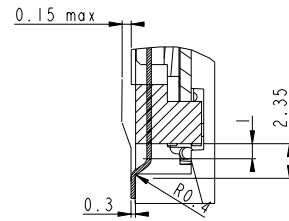
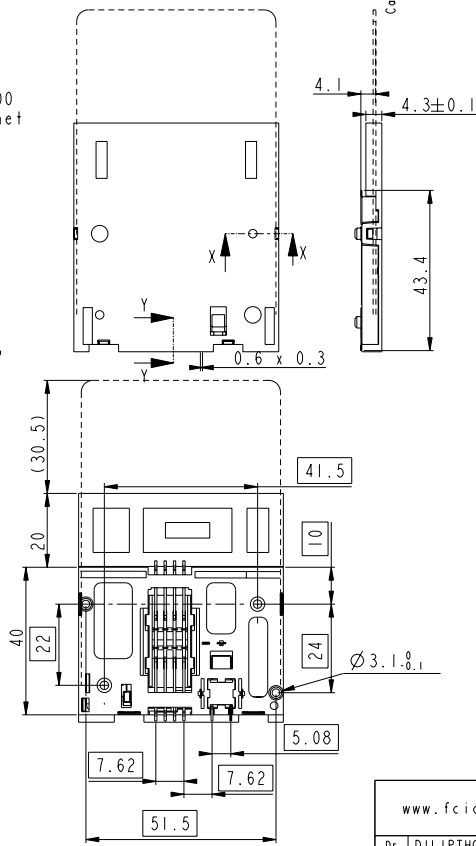

SECTION Y-Y  
SCALE 4:1

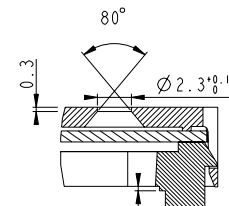

SECTION X-X  
SCALE 4:1

General Tolerances	
0 to 10mm:	±0.1mm
10 to 30mm:	±0.15mm
30 to 60mm:	±0.2mm
60 and more:	±0.3mm

www.fciconnect.com		surface	ISO 1302	tolerance std	ISO 406	ISO 1101	projection	mm
		TOLERANCES UNLESS OTHERWISE SPECIFIED						
Dr	DILIPTHOMAS	'05/07/08	ANGULAR	0.X	±	size	A3	Scale 1:1
Eng	DILIPTHOMAS	'05/07/08	LINEAR	0.XX	±	ECN	106-0078	
Chr	DILIPTHOMAS	'06/06/19	0° ±*	0.XXX	±	Spec ref	--	
Appr	K.V.SIVADAS	'06/06/19	Product family	MOBILE I/O				
		<b>TITLE</b> 8 POS. SMT E05 WITH PEGS SMART CARD READER VXX 27787		catalog no See Table		dwg no <b>VJW53787</b>		Rev. <b>G</b>
				INSPECTION		sheet 1 of 2		

rev	ecn no	dr	date
A	F20307	DLE	02/04/29
B	F20341	DLE	02/06/04
C	F20364	DLE	02/06/24
D	LS3088	JTA	03/11/28
E	105-0035	DTK	'05/03/04
F	105-0176	NT	'05/09/29
G	106-0078	DTK	'06/06/19

Copyright FCI.



Copyright FCI.

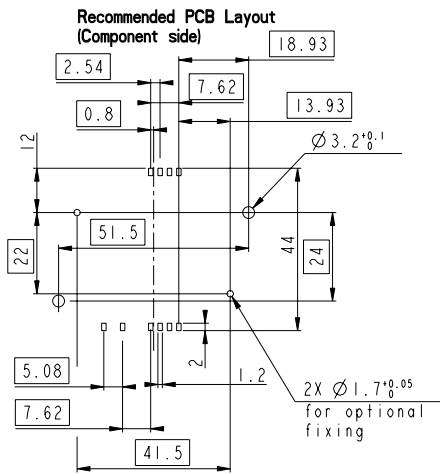

**GENERAL :**  
High cycle life duration smart card connector with landing type contacts mechanism. The landing type connector also provides the feature of recessed contacts when card is not inserted which protects them against vandalism.  
Smart card for reference purposes only.

**ELECTRICAL PROPERTIES:**  
Insulation resistance : > 1000M $\Omega$   
Dielectric withstanding voltage : >750 Vrms  
Current carrying capacity : Min 10mA, Max 1A  
Contact resistance : < 100m $\Omega$

**MECHANICAL PROPERTIES :**  
Operating force : Insertion : F < 10N  
Withdrawal : 1 < F < 10N  
Contact Normal force : 0.2 < F < 0.3 for 0.6mm of deflection  
Durability : 200 000 mating cycles

**MATERIAL :**  
Head reader : High temp. Thermoplastic, Colour Black, Rated UL94V0  
Cover : Thermoplastic, Colour black, Rated UL94V0  
Contacts : Copper alloy,  
Plating : 2.5 $\mu$ m Nickel min. all over  
2 $\mu$ m Gold min. on contact area  
3 $\mu$ m SnPb60/40 min. on solder tails (for leaded version)  
3 $\mu$ m matte tin min. on solder tails (for lead free version)

**ENVIRONMENT :**  
Operating temperature : -40°C / +85°C  
Climatic conditions : UTE 93-421

**PACKAGING :**  
Plastic cavity tray

**LEAD FREE VERSION:**

"This product meets European Union Directives and other country regulations as described in GS-22-008"

The reader housing (not cover) will withstand exposure to 260°C peak temperature for 10seconds in a convection reflow oven.

www.fciconnect.com		surface	--	tolerance std	ISO 1302	ISO 406	ISO 1101	projection	mm	
		TOLERANCES UNLESS OTHERWISE SPECIFIED								
Dr	DILIPTHOMAS	'05/07/08	ANGULAR	LINEAR	0.X	±	size	A3	Scale	1:1
Eng	DILIPTHOMAS	'05/07/08	0"	±"	0.XX	±	ECN	106-0078		
Chr	DILIPTHOMAS	'06/06/19	0"	±"	0.XXX	±	Product family	MOBILE I/O	Spec ref	--
Appr	K.V.SIVADAS	'06/06/19					Product family	MOBILE I/O	Spec ref	--
<b>FCI</b>		title			8 POS. SMT E05 WITH PEGS		dwg no	VJW53787		Rev.
		SMART CARD READER VXX 27787								G
		catalog no			See Table		INSPECTION	sheet 2 of 2		

REF: 2006-01-11