

## Series 11675

### Quick-Connect Power Distribution Blocks

#### SPECIFICATIONS

**Rating:** 40A, 250V

**Poles:** 2 to 6 poles with (3) .250" quick-connect terminals per pole

**Wire Range:** #8-14 AWG CU

**Torque Rating:** 18 in.-lb.

**Operating Temperature:** 150°C

**Design:** Screw connections for field wiring. Quick connects reduce cost of internal wiring.

**Breakdown Voltage:**

**Agency Information:** UL/CSA; CE Certified

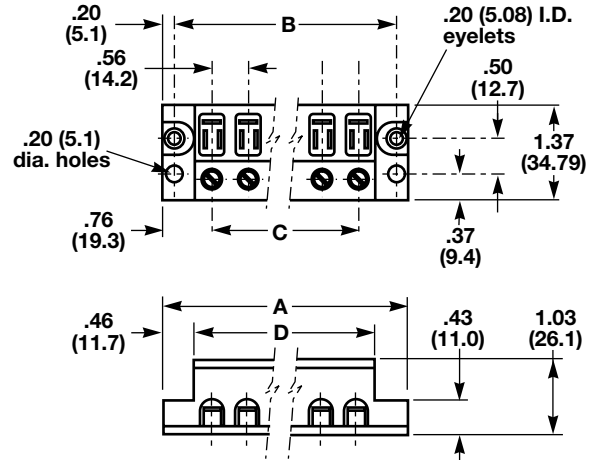
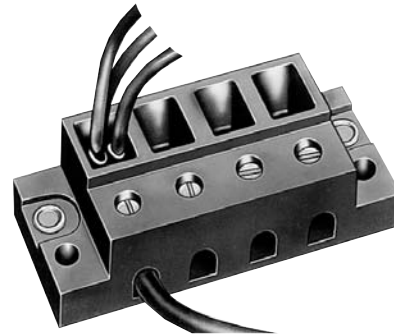

Part Number	A	B	C	D
11675-2	2.09	1.68	.56	1.15
11675-3	2.66	2.25	1.12	1.71
11675-4	3.22	2.81	1.68	2.28
11675-5	3.78	3.37	2.25	2.84
11675-6	4.34	3.93	2.81	3.40

\* Dimensions in inches. To convert to millimeters, multiply by 25.4.

## Series 11725

### Quick-Connect Power Distribution Blocks

#### SPECIFICATIONS

**Rating:** 70A, 600V; UL/CSA

**Poles:** 2, 3 or 4 poles with (4) .250" quick-connect terminals per pole

**Wire Range:** #2-14 AWG CU / #2-8 AWG AL

**Torque Rating:** 45 in.-lb.

**Operating Temperature:** 150°C

**Design:** Screw connections for field wiring. Quick connects reduce cost of internal wiring.

**Agency Information:** UL/CSA E62622; CE Certified

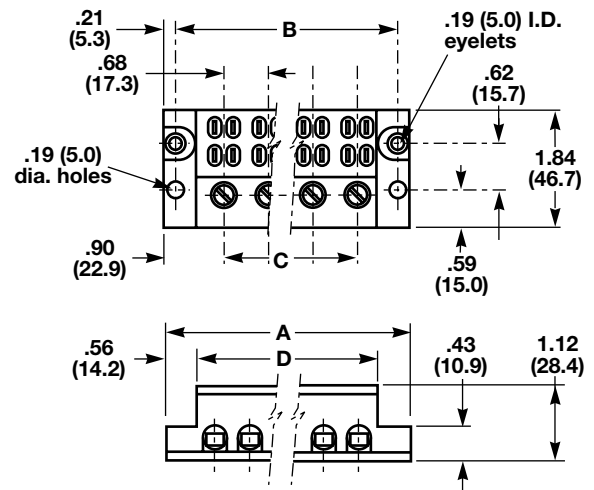

Part Number	A	B	C	D
11725-2	2.50	2.06	.68	1.37
11725-3	3.18	2.75	1.37	2.06
11725-4	3.87	3.43	2.06	2.75

\* Dimensions in inches. To convert to millimeters, multiply by 25.4.

## Series EN

Power Blocks  
1.78" Centers

### SPECIFICATIONS

**Rating:** 285A, 600V; UL/CSA

**Wire Range:** Line Connection: #300MCM-#4 CU/AL  
Load Connection: (6) #6-14AWG CU  
(6) #8-14 AWG AL

**Material:** Molded material; Black, UL rated  
94V-2 thermoplastic

**Operating Temperature:** 125°C

**Torque Rating:** 200 in-lb. line terminal, 20 in-lb. load terminal

**Agency Information:** UL/CSA; CE Certified

**Covers:** Not available



Series	A	B
EN61	1.38	1.78
EN62	3.15	3.62
EN63	4.93	5.37

