

(0,80mm) .0315"

CLE SERIES



COST EFFECTIVE MICRO SOCKET

SPECIFICATIONS

For complete specifications and recommended PCB layouts see www.samtec.com?CLE

Insulator Material: Black Liquid Crystal Polymer



Contact Material: BeCu

Plating: Au over 50µ" (1,27µm) Ni

Operating Temp Range: -55°C to +125°C

Contact Resistance: 15 mΩ max (initial)

Insertion Depth: Top Entry = (1,73mm) .068" to (3,18mm) .125" with (0,38mm) .015" wipe, or pass-through

Bottom Entry = (3,23mm) .127" minimum plus board thickness

Insertion Force: (Single contact only) 2.0oz (0,56N)

Normal Force: 75 grams (0,73N)

Withdrawal Force: (Single contact only) 1.2oz (0,33N)

Max Cycles: 100 with 10µ" (0,25µm) Au

RoHS Compliant: Yes

Mates with: FTE, AW



Ideal for pass-through applications

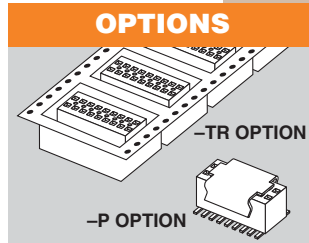

(0,80mm) .0315" micro pitch

Surface Mount

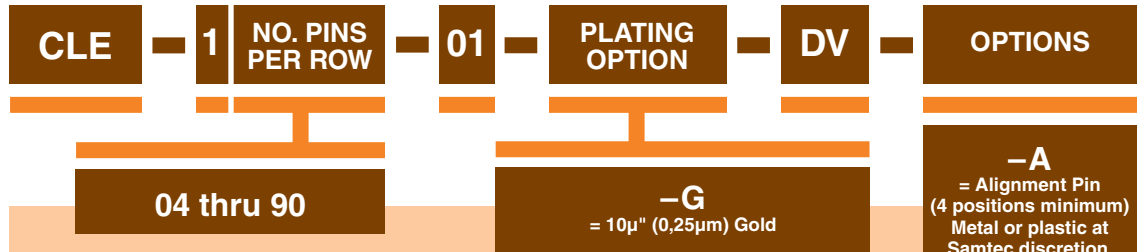

CURRENT RATING	
AMBIENT TEMP	FTE/CLE
20°C	3.1A
40°C	2.8A
60°C	2.4A
95°C	1.6A

6 POSITIONS (2x3) POWERED

Processing:

Lead-Free Solderable:

Yes

SMT Lead Coplanarity:

(0,10mm) .004" max (04-65)
(0,15mm) .006" max (66-90)

- A**
= Alignment Pin
(4 positions minimum)
Metal or plastic at Samtec discretion.
- K**
= (3,50mm) .138" DIA
Polyimide film
Pick & Place Pad
(8 positions minimum)
- P**
= Metal Pick & Place Pad
(8 positions minimum)
- TR**
= Tape & Reel Packaging

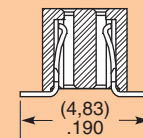
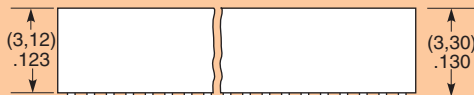
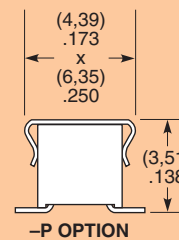
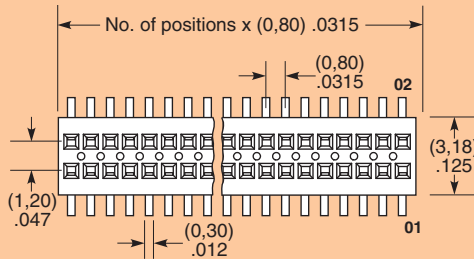

TAPE & REEL AVAILABILITY

No tooling charges.
Minimum order is the lesser of a full reel quantity or 125 pieces.
Order any quantity above minimum.
In-house design, manufacture.
Quick turn-around.

Call Samtec for specifications and ordering information.

Note: Some lengths, styles and options are non-standard, non-returnable.

Due to technical progress, all designs, specifications and components are subject to change without notice.

WWW.SAMTEC.COM