

PC card drilling dimensions (after plating)
(thickness 1.60 ± 0.20mm)

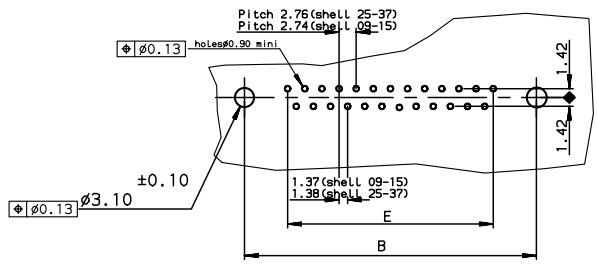

TIN LEAD PART NUMBER

SHELL	A±0.38	B±0.12	C±0.10	D±0.25	E±0.07	PART NUMBER
09	30.81	24.99	16.96	16.21	10.96	D09S24A.PX00
15	39.14	33.32	25.18	24.54	19.18	D15S24A.PX00
25	53.03	47.04	39.12	38.25	33.12	D25S24A.PX00
37	69.32	63.50	55.68	54.71	49.68	D37S24A.PX00

Plating: 4 --> flash AU
Plating: 6 --> 0.76µ AU

LEAD FREE PART NUMBER

SHELL	A±0.38	B±0.12	C±0.10	D±0.25	E±0.07	PART NUMBER
09	30.81	24.99	16.96	16.21	10.96	D09S24A.PX00LF
15	39.14	33.32	25.18	24.54	19.18	D15S24A.PX00LF
25	53.03	47.04	39.12	38.25	33.12	D25S24A.PX00LF
37	69.32	63.50	55.68	54.71	49.68	D37S24A.PX00LF

Plating: 4 --> flash AU
Plating: 6 --> 0.76µ AU

GENERAL CHARACTERISTICS AND ROHS INFORMATIONS:
SEE DRAWING C01-8646-0000

European Views

www.fciconnect.com		surface ISO 1302	tolerance std ISO 406 ISO 1101	projection mm
TOLERANCES UNLESS OTHERWISE SPECIFIED				
Dr	JOUBERT	1996/09/10	ANGULAR	0.X ± 0.1
Eng	PESSON	1996/09/10	LINEAR	0.XX ± 0.1
Chr	LEGARE	1996/09/10	0.III' ± 2'	0.XXX ± 0.1
Appr	LEGARE	1996/09/10	Product family	D-SUB
FCj			title FEMALE CONNECTOR STD EUROPE	
			straight solder type for PCB 1.6mm	
			Rev. D	
			no C01-8646-0492	
			Rev. CUSTOMER sheet 1 of 1	

rev	ecn no	dr	date
A	-	JOU	1996/09/10
B	LS05-001	MPE	2005/03/14
C	LS06-0095	LGO	2006/07/20
D	LS08-0217	MPE	2008/11/25
-	-	-	-
-	-	-	-

Copyright FCj

REV F - 2006-04-17