



CPC - Medical Connector

Reliable and low cost for disposable or re-useable applications

- Suitable for surgical power instrument, RF and ultrasound ablation and EP monitors used in the O.R.
- Grip area with push-pull action
- Robust self-latching mechanism
- Gold-plated contacts
- Sterilizable
 - Autoclave, STERRAD, CIDEK+, EtO
- Available contact types 5, 6, 7, 10 positions
- Lightweight housing is resistant to shock, drop and chemically induced cracking.
- Accommodates cables OD from 2.7 to 6.5 mm
- Available in either black or gray housing and optional color coding for mating polarization
- MEDLOC II enhanced latch release



3D
PDF

Click the active links
within this document to
view 3D PDF models!

CPC - Medical Connector

KEY FEATURES

- Connectors are user friendly, sterilizable, robust and provide secure self-latching
- Can be overmolded with silicone or PVC flex reliefs for cable strain and flex protection
- Available with an integral cable collet or an overmolded flex relief
- Self-latching mechanism is secure under axial and torsional loads
- Overmolded flex-reliefs can be customized per customer requirements

ELECTRICAL

- Operating Voltage - 300 VAC
- Current rating - 5 position - 7A
6 position - 6A
7 position - 5A
10 position - 3A
- Dielectric Withstanding Voltage - 1200 VAC
- Insulation Resistance - 1000 megohms
- Contact Resistance - 20 milliohms max

MECHANICAL

- Durability: 2500 cycles
- Temperature Rating: -50° to 170° C
- Mating Force: 2.5 lbs max
- Unmating Force: 1.0 lb min

MATERIALS

- Housing, Insert, Collet & Nut - Polyphenylsulfone
- Contacts - Copper Alloy, Gold Finish
- Hex Nut - Copper Alloy, Nickel Finish

STANDARDS & SPECS

- EIA-364: Electrical Connector/Socket Test procedure Including Environmental Classifications

PRODUCT OFFERING

Keying (plug front view):

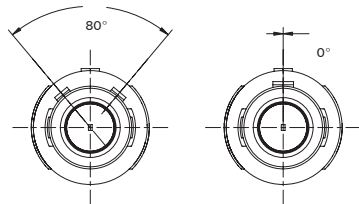

Contact Configuration:

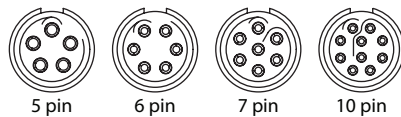

Cable flex/strain reliefs:

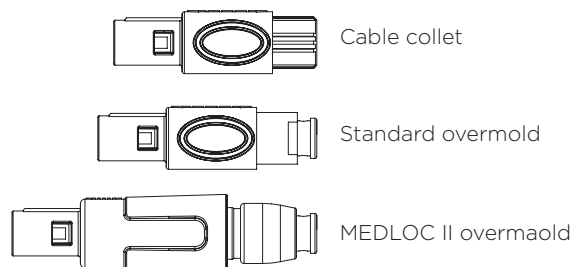

Color Coded Receptacles and Plugs

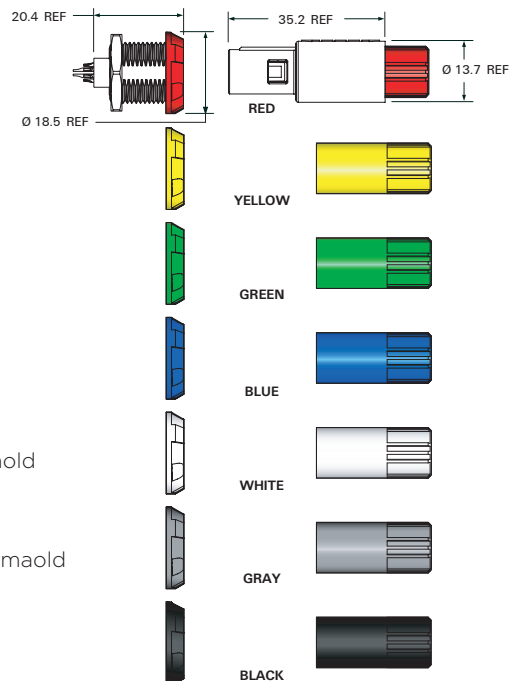

©2007 by Tyco Electronics Corporation. All Rights Reserved. STERRAD, CIDEX+ are trademarks of Johnson & Johnson Corporation. Dimensions are shown for reference purposes only. Specifications subject to change.

Tyco Electronics Corporation
Harrisburg, PA 17001
800-522-6752
medicalsales@tycoelectronics.com
tycoelectronics.com/medical
6-1773445-3-GIC-03-28-2007

Contact your local Tyco Electronics sales engineer for availability of additional configurations or complete cable assemblies.

 **Tyco Electronics**
Our commitment. Your advantage.

PART NUMBERS
Cable Plugs - Cable Collet - No Flex Relief
5 pin 0° Alignment Key

Housing Color	Collet Color	<u>Ø2.7 - 3.9</u>	Cable Diameter <u>Ø4.0 - 5.2</u>	<u>Ø5.3 - 6.5</u>
BLACK	BLACK	1877845-3	1877845-2	1877845-1
	RED	1-1877845-5	1-1877845-4	1-1877845-3
	WHITE	2-1877845-7	2-1877845-6	2-1877845-5
	YELLOW	3-1877845-9	3-1877845-8	3-1877845-7
	GREEN	5-1877845-1	5-1877845-0	4-1877845-9
	BLUE	6-1877845-3	6-1877845-2	6-1877845-1
GRAY	GRAY	1877845-9	1877845-8	1877845-7
	RED	2-1877845-1	2-1877845-0	1-1877845-9
	WHITE	3-1877845-3	3-1877845-2	3-1877845-1
	YELLOW	4-1877845-5	4-1877845-4	4-1877845-3
	GREEN	5-1877845-7	5-1877845-6	5-1877845-5
	BLUE	6-1877845-9	6-1877845-8	6-1877845-7

5 pin 80° Alignment Key

Housing Color	Collet Color	<u>Ø2.7 - 3.9</u>	Cable Diameter <u>Ø4.0 - 5.2</u>	<u>Ø5.3 - 6.5</u>
BLACK	BLACK	1877845-6	1877845-5	1877845-4
	RED	1-1877845-8	1-1877845-7	1-1877845-6
	WHITE	3-1877845-0	2-1877845-9	2-1877845-8
	YELLOW	4-1877845-2	4-1877845-1	4-1877845-0
	GREEN	5-1877845-4	5-1877845-3	5-1877845-2
	BLUE	6-1877845-6	6-1877845-5	6-1877845-4
GRAY	GRAY	1-1877845-2	1-1877845-1	1-1877845-0
	RED	2-1877845-4	2-1877845-3	2-1877845-2
	WHITE	3-1877845-6	3-1877845-5	3-1877845-4
	YELLOW	4-1877845-8	4-1877845-7	4-1877845-6
	GREEN	6-1877845-0	5-1877845-9	5-1877845-8
	BLUE	7-1877845-2	7-1877845-1	7-1877845-0

6 pin 0° Alignment Key

Housing Color	Collet Color	<u>Ø2.7 - 3.9</u>	Cable Diameter <u>Ø4.0 - 5.2</u>	<u>Ø5.3 - 6.5</u>
BLACK	BLACK	1877846-3	1877846-2	1877846-1
	RED	1-1877846-5	1-1877846-4	1-1877846-3
	WHITE	2-1877846-7	2-1877846-6	2-1877846-5
	YELLOW	3-1877846-9	3-1877846-8	3-1877846-7
	GREEN	5-1877846-1	5-1877846-0	4-1877846-9
	BLUE	6-1877846-3	6-1877846-2	6-1877846-1
GRAY	GRAY	1877846-9	1877846-8	1877846-7
	RED	2-1877846-1	2-1877845-0	1-1877846-9
	WHITE	3-1877846-3	3-1877846-2	3-1877846-1
	YELLOW	4-1877846-5	4-1877846-4	4-1877846-3
	GREEN	5-1877846-7	5-1877846-6	5-1877846-5
	BLUE	6-1877846-9	6-1877846-8	6-1877846-7

6 pin 80° Alignment Key

Housing Color	Collet Color	<u>Ø2.7 - 3.9</u>	Cable Diameter <u>Ø4.0 - 5.2</u>	<u>Ø5.3 - 6.5</u>
BLACK	BLACK	1877846-6	1877846-5	1877846-4
	RED	1-1877846-8	1-1877846-7	1-1877846-6
	WHITE	3-1877846-0	2-1877846-9	2-1877846-8
	YELLOW	4-1877846-2	4-1877846-1	4-1877846-0
	GREEN	5-1877846-4	5-1877846-3	5-1877846-2
	BLUE	6-1877846-6	6-1877846-5	6-1877846-4
GRAY	GRAY	1-1877846-2	1-1877846-1	1-1877846-0
	RED	2-1877846-4	2-1877846-3	2-1877846-2
	WHITE	3-1877846-6	3-1877846-5	3-1877846-4
	YELLOW	4-1877846-8	4-1877846-7	4-1877846-6
	GREEN	6-1877846-0	5-1877846-9	5-1877846-8
	BLUE	7-1877846-2	7-1877846-1	7-1877846-0

Cable Plugs - Cable Collet - No Flex Relief
7 pin 0° Alignment Key

Housing Color	Collet Color	<u>Ø2.7 - 3.9</u>	Cable Diameter <u>Ø4.0 - 5.2</u>	<u>Ø5.3 - 6.5</u>
BLACK	BLACK	1877847-3	1877847-2	1877847-1
	RED	1-1877847-5	1-1877847-4	1-1877847-3
	WHITE	2-1877847-7	2-1877847-6	2-1877847-5
	YELLOW	3-1877847-9	3-1877847-8	3-1877847-7
	GREEN	5-1877847-1	5-1877847-0	4-1877847-9
	BLUE	6-1877847-3	6-1877847-2	6-1877847-1
GRAY	GRAY	1877847-9	1877847-8	1877847-7
	RED	2-1877847-1	2-1877847-0	1-1877847-9
	WHITE	3-1877847-3	3-1877847-2	3-1877847-1
	YELLOW	4-1877847-5	4-1877847-4	4-1877847-3
	GREEN	5-1877847-7	5-1877847-6	5-1877847-5
	BLUE	6-1877847-9	6-1877847-8	6-1877847-7

7 pin 80° Alignment Key

Housing Color	Collet Color	<u>Ø2.7 - 3.9</u>	Cable Diameter <u>Ø4.0 - 5.2</u>	<u>Ø5.3 - 6.5</u>
BLACK	BLACK	1877847-6	1877847-5	1877847-4
	RED	1-1877847-8	1-1877847-7	1-1877847-6
	WHITE	3-1877847-0	2-1877847-9	2-1877847-8
	YELLOW	4-1877847-2	4-1877847-1	4-1877847-0
	GREEN	5-1877847-4	5-1877847-3	5-1877847-2
	BLUE	6-1877847-6	6-1877847-5	6-1877847-4
GRAY	GRAY	1-1877847-2	1-1877847-1	1-1877847-0
	RED	2-1877847-4	2-1877847-3	2-1877847-2
	WHITE	3-1877847-6	3-1877847-5	3-1877847-4
	YELLOW	4-1877847-8	4-1877847-7	4-1877847-6
	GREEN	6-1877847-0	5-1877847-9	5-1877847-8
	BLUE	7-1877847-2	7-1877847-1	7-1877847-0

10 pin 0° Alignment Key

Housing Color	Collet Color	<u>Ø2.7 - 3.9</u>	Cable Diameter <u>Ø4.0 - 5.2</u>	<u>Ø5.3 - 6.5</u>
BLACK	BLACK	1877848-3	1877848-2	1877848-1
	RED	1-1877848-5	1-1877848-4	1-1877848-3
	WHITE	2-1877848-7	2-1877848-6	2-1877848-5
	YELLOW	3-1877848-9	3-1877848-8	3-1877848-7
	GREEN	5-1877848-1	5-1877848-0	4-1877848-9
	BLUE	6-1877848-3	6-1877848-2	6-1877848-1
GRAY	GRAY	1877848-9	1877848-8	1877848-7
	RED	2-1877848-1	2-1877848-0	1-1877848-9
	WHITE	3-1877848-3	3-1877848-2	3-1877848-1
	YELLOW	4-1877848-5	4-1877848-4	4-1877848-3
	GREEN	5-1877848-7	5-1877848-6	5-1877848-5
	BLUE	6-1877848-9	6-1877848-8	6-1877848-7

10 pin 80° Alignment Key

Housing Color	Collet Color	<u>Ø2.7 - 3.9</u>	Cable Diameter <u>Ø4.0 - 5.2</u>	<u>Ø5.3 - 6.5</u>
BLACK	BLACK	1877848-6	1877848-5	1877848-4
	RED	1-1877848-8	1-1877848-7	1-1877848-6
	WHITE	3-1877848-0	2-1877848-9	2-1877848-8
	YELLOW	4-1877848-2	4-1877848-1	4-1877848-0
	GREEN	5-1877848-4	5-1877848-3	5-1877848-2
	BLUE	6-1877848-6	6-1877848-5	6-1877848-4
GRAY	GRAY	1-1877848-2	1-1877848-1	1-1877848-0
	RED	2-1877848-4	2-1877848-3	2-1877848-2
	WHITE	3-1877848-6	3-1877848-5	3-1877848-4
	YELLOW	4-1877848-8	4-1877848-7	4-1877848-6
	GREEN	6-1877848-0	5-1877848-9	5-1877848-8
	BLUE	7-1877848-2	7-1877848-1	7-1877848-0

Cable Plugs - Overmold Flex Relief - Cable OD Ø6.4 mm Max

Contacts	Keying	Color	Standard	MEDLOC II
5P	0°	Black.....	1877849-1	1811797-1
5P	80°	Black.....	1877849-2	1811797-2
5P	0°	Gray.....	1877849-3	1811797-3
5P	80°	Gray.....	1877849-4	1811797-4
6P	0°	Black.....	1877850-1	1811897-1
6P	80°	Black.....	1877850-2	1811897-2
6P	0°	Gray.....	1877850-3	1811897-3
6P	80°	Gray.....	1877850-4	1811897-4
7P	0°	Black.....	1877851-1	1811798-1
7P	80°	Black.....	1877851-2	1811798-2
7P	0°	Gray.....	1877851-3	1811798-3
7P	80°	Gray.....	1877851-4	1811798-4
10P	0°	Black.....	1877852-1	1811799-1
10P	80°	Black.....	1877852-2	1811799-2
10P	0°	Gray.....	1877852-3	1811799-3
10P	80°	Gray.....	1877852-4	1811799-4

Panel Mount - Receptacles

Contacts	Keying	Color	Part number
5P	0°	Gray	1877066-1
5P	0°	Black.....	1877066-2
5P	80°	Gray	1877066-3
5P	80°	Black.....	1877066-4
6P	0°	Gray	1877067-1
6P	0°	Black.....	1877067-2
6P	80°	Gray	1877067-3
6P	80°	Black.....	1877067-4
7P	0°	Gray	1877068-1
7P	0°	Black.....	1877068-2
7P	80°	Gray	1877068-3
7P	80°	Black.....	1877068-4
10P	0°	Gray	1877069-1
10P	0°	Black.....	1877069-2
10P	80°	Gray	1877069-3
10P	80°	Black.....	1877069-4

Front Nut

RED.....	1811448-1
WHITE	1811448-2
YELLOW	1811448-3
GREEN.....	1811448-4
BLUE	1811448-5

Back Nut

RED	1877841-1
WHITE	1877841-2
YELLOW.....	1877841-3
GREEN	1877841-4
BLUE.....	1877841-5

Wrench

GRAY	195457-1
------------	----------

NOTES:
