

PRODUCT NUMBER	PCB THICKNESS
91877-001	1.6MM
91877-002	2.4MM
91877-003	2.4MM
91877-001LF	1.6MM
91877-002LF	2.4MM

OBSOLETE USE 91877-002

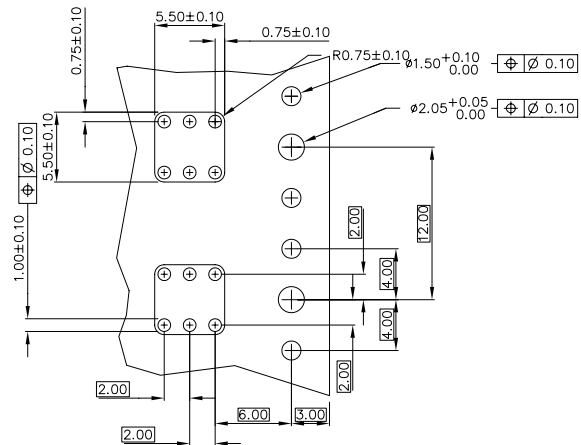
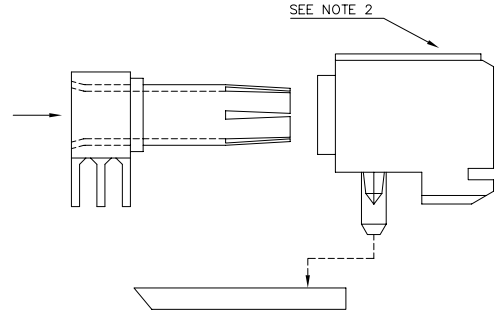
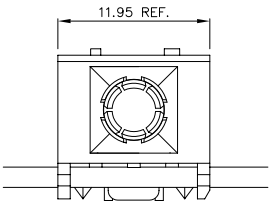
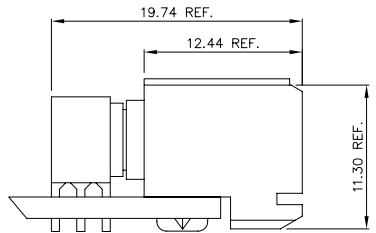
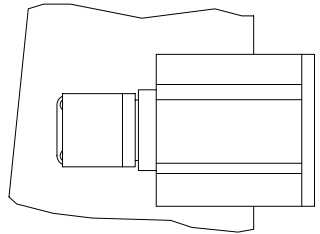

RECOMMENDED HOLE PATTERN
COMPONENT SIDE

- NOTE:
- HOUSING SHOWN FOR APPLICATION CLARITY AND DOES NOT COME WITH R.A. RECEPTACLE POWER CONTACT
 - 4 ROW HSG W/HEAT STAKE PEG: P/N 70292-101
4 ROW HSG W/PRESS PEG: P/N 89092-101
5 ROW HSG W/HEAT STAKE PEG: P/N 73477-101
5 ROW HSG W/PRESS PEG: P/N 73478-101
 - RECEPTACLE CONTACT PLATING:
GOLD OVER NICKEL
 - PLATING ON TAILS OF 91877-YYY IS SnPb
PLATING ON TAILS OF 91877-YYLF IS Sn (LEAD FREE)
 - IF P/N IS "LF" THE PRODUCT MEETS EUROPEAN UNION DIRECTIVES AND OTHER COUNTRY REGULATION AS DESCRIBED IN GS-22-008.

mat'l. code	surface	tolerance	projection	product family
-	ISO 1302 ✓	ISO 406 ISO 1101	ISO 1101	METRAL (tm)
ltr	ecn	nd	dr	date
B	v31676	SCS	9/08/93	
C	v60188	CSC	2/02/96	
D	v01818	JWS	7/17/00	
E	v02928	JWS	12/12/00	dr
F	v04-1176	TAB	12/14/04	engr
G	M06-0156	MHT	4/13/06	chr
H	M06-0286	MNR	7/27/06	appd
sheet	revisor	H		
index	sheet	1		

tolerances unless otherwise specified	angles	linear	xx ±0.1/3	xxx ±.005/13	xxxx ±.0020/.050
scale 1:1	mm				
title	R.A. PASS-THRU POWER CONTACT				
dwg no	91877		sheet 1 of 1	size	A3
type	Product Customer Drawing				