

1 2 3 4

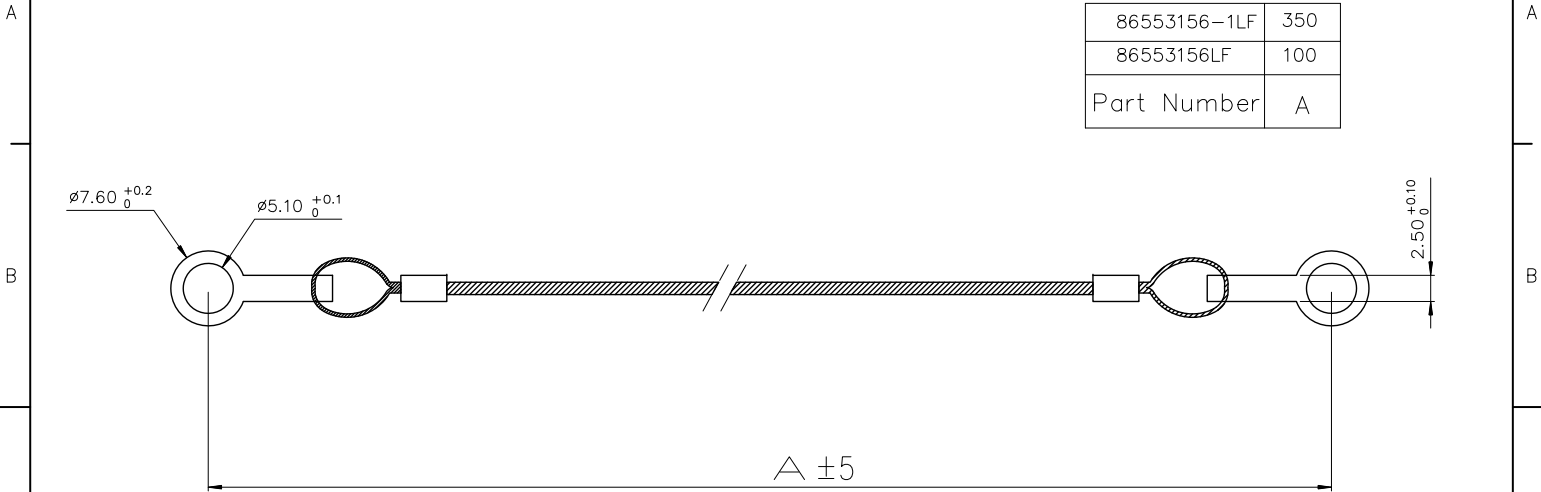

TECHNICAL CHARACTERISTICS :

Packaging : individual

86553156-1LF	350
86553156LF	100
Part Number	A

Part number	86553156-1LF
	86553156LF

**NOTE:RoHS INFORMATIONS**

- The "LF" product meets European union Directives and other country regulations as described in GS-22-008.
- The product is not intended to be exposed to a manufacturing solder process.
- Packaging spec: see GS-14-920.

European Views

www.fciconnect.com		surface	ISO 1302	tolerance std	ISO 406 ISO 1101	projection	mm	
		TOLERANCES UNLESS OTHERWISE SPECIFIED				size	Scale	
Dr	GOISNARD	2006/01/12	ANGULAR	0.X	±0.1	A3	2	
Eng	PESSON	2006/01/12	LINEAR	0.XX	±0.1			
Chr	ABHILASH	2009/06/20	0.xx   ±2	0.xxx	±0.1	ECN	111-0048	
Appr	SUDHIR	2009/06/20	Product family		D-SUB	Spec ref	-	
FCj		title			ATTACHING CORD FOR METAL CAPS		dwg no	Rev.
		catalog no					C01-8655-1670	D
						CUSTOMER	sheet 1 of 1	

rev	ecn no	dr	date
A	LS05-0123	LGO	2006/01/12
B	LS06-0095	LGO	2006/06/26
C	109-0102	AMR	2009/06/20
D	111-0048	AMR	2011/03/08
-	-	-	-
-	-	-	-
-	-	-	-

Copyright FCj

REV F - 2006-04-17

1 2 3 4

PDM: Rev:D STATUS: Released Printed: Mar 11, 2011