

PRODUCT NUMBER 88916-2YZ PRESS PEG VERSION NOTE 4

FRONT VIEW

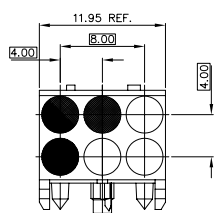

PRESS PEG VERSION

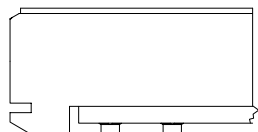
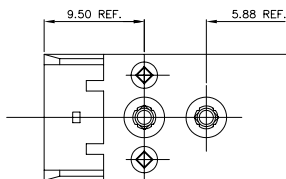
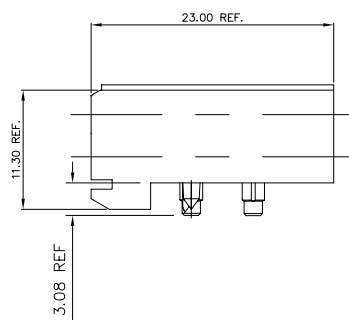

ASSEMBLY ON P.C.B.

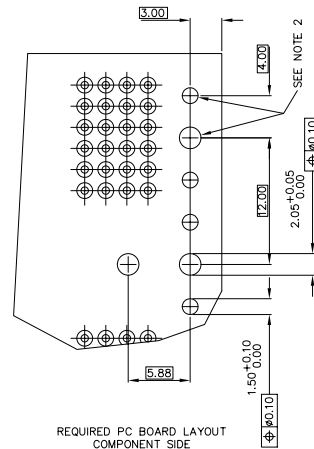

REQUIRED PC BOARD LAYOUT COMPONENT SIDE

NOTE:

- ① HOUSING MATERIAL: LCP, 30% GLASS FILLED
FLAME RETARDANT ACC. UL 94V-0
COLOR: NATURAL
- ② INDICATED HOLES ARE UNPLATED
- ③ SHADED AREA DENOTES PLUGGED (CLOSE) POSITION.
SEE SHEET #4 FOR PLUG COMBINATIONS AND PRODUCT NUMBERS.
PLUG COMBINATION SHOWN ABOVE IS FOR REFERENCE ONLY.
(PLUG COMBINATION #13)

④ ADD "LF" SUFFIX AT THE END OF PART NUMBER FOR LEAD FREE OPTION.

5. THIS PRODUCT MEETS EUROPEAN UNION DIRECTIVES AND OTHER COUNTRY REGULATION AS DESCRIBED IN GS-22-008.
6. THE HOUSING WILL WITHSTAND EXPOSURE TO 260°C PEAK TEMPERATURE FOR 15 SECONDS IN A WAVE SOLDER APPLICATION WITH A 1.5mm MINIMUM THICK CIRCUIT BOARD OR FOR 10-20 SECONDS IN A CONVECTION, INFRA-RED OR VAPOR PHASE REFLOW OVEN. SEE APPLICATION NOTES/PROCEDURES IF THEY ARE AVAILABLE.

mat'l. code	surface ISO 1302	tolerance ISO 406 ISO 1101	projection	product family METRAL ACC
ltr	ecn	no	dr	date
R				
tolerances unless otherwise specified		title RECEPTACLE KEYING MODULE		
angles	linear	.0±.3	MM	dwg no
0°±2'		.00±.13	scale 1:1	88916
dr	S.STONER	4/16/93	FCJ	sheet 2 of 6
enrg	R.DOUTRICH	4/16/93		A3
chr	S.STONER	4/16/93		size
appd	S.STONER	4/16/93	type	Product Customer Drawing
sheet index	revision sheet			

PRODUCT NUMBER 88916-4YZ SCREW DOWN VERSION NOTE 5

FRONT VIEW

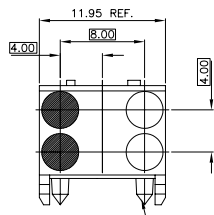

SCREW DOWN VERSION

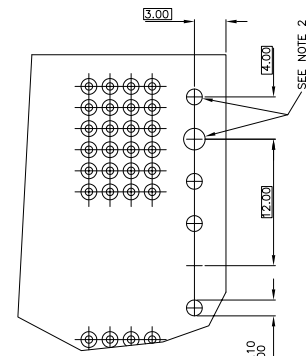
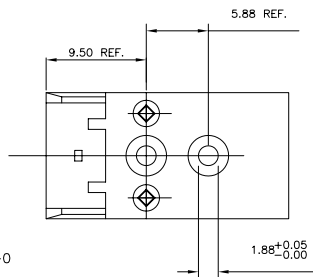
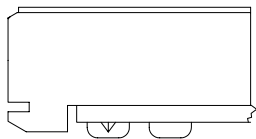
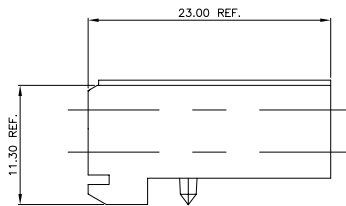

REQUIRED PC BOARD LAYOUT COMPONENT SIDE

NOTE:

- ① HOUSING MATERIAL: LCP, 30% GLASS FILLED
FLAME RETARDANT PER UL 94V-0
COLOR: NATURAL
- ② INDICATED HOLES ARE UNPLATED
3. TWO MOUNTING SCREW, P/N 63787-001, FOR MAX PCB THICKNESS 2.4MM[0.094"] OR P/N 63787-002 FOR MAX. PCB THICKNESS 3.2MM[0.126"] MUST BE ORDERED SEPARATLY.
4. SHADED AREA DENOTES PLUGGED (CLOSE) POSITION. SEE SHEET #6 FOR PLUG COMBINATIONS AND PRODUCT NUMBERS. PLUG COMBINATION SHOWN ABOVE IS FOR REFERENCE ONLY. (PLUG COMBINATION #04)
- ⑤ ADD "LF" SUFFIX AT THE END OF PART NUMBER FOR LEAD FREE OPTION.
6. THIS PRODUCT MEETS EUROPEAN UNION DIRECTIVES AND OTHER COUNTRY REGULATION AS DESCRIBED IN GS-22-008.
7. THE HOUSING WILL WITHSTAND EXPOSURE TO 260°C PEAK TEMPERATURE FOR 15 SECONDS IN A WAVE SOLDER APPLICATION WITH A 1.5mm MINIMUM THICK CIRCUIT BOARD OR FOR 10-20 SECONDS IN A CONVECTION, INFRA-RED OR VAPOR PHASE REFLOW OVEN. SEE APPLICATION NOTES/PROCEDURES IF THEY ARE AVAILABLE.

mat'l. code		surface	tolerance	projection	product family
ISO 1302		ISO 406	ISO 1101	MM	METRAL ACC
ltr	ecn	no	dr	date	title
R					RECEPTACLE KEYING MODULE
tolerances unless otherwise specified					scale 1:1
angles		linear		MM	
0°±2'		.0±.3		FCJ	
		.00±.13		dwg no	
		.000±.051		88916	
		dr S.STONER 4/16/93		sheet 3 of 6 size	
		enrg R.DOUTRICH 4/16/93		A3	
		chr S.STONER 4/16/93		type	
		appd S.STONER 4/16/93		Product Customer Drawing	
sheet	revision				
index	sheet				

PRODUCT NUMBER 88916-XYZ

PLUG COMBINATIONS - (FRONT VIEW)

PLUGGED POSITION
SEE NOTE 1

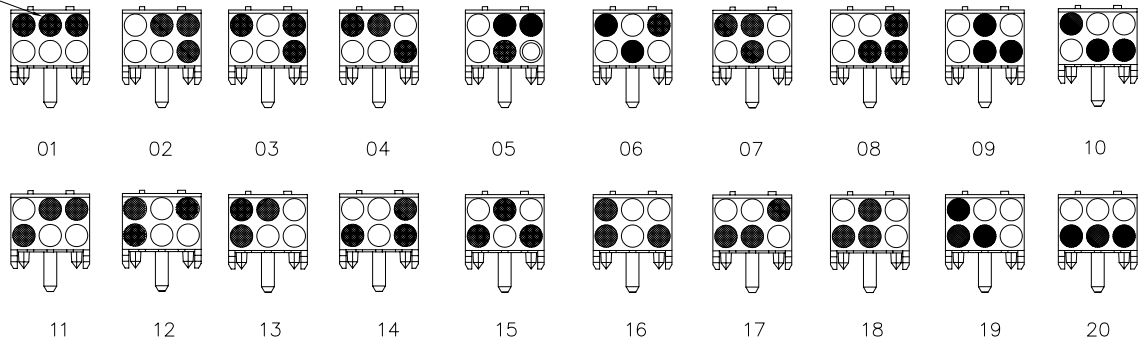

PRODUCT NUMBER	PRODUCT NUMBER	COMBINATION NUMBER
HEAT-STAKE VERSION	PRESS-PEG VERSION	
88916-101	88916-201	01
88916-102	88916-202	02
88916-103	88916-203	03
88916-104	88916-204	04
88916-105	88916-205	05
88916-106	88916-206	06
88916-107	88916-207	07
88916-108	88916-208	08
88916-109	88916-209	09
88916-110	88916-210	10
88916-111	88916-211	11
88916-112	88916-212	12
88916-113	88916-213	13
88916-114	88916-214	14
88916-115	88916-215	15
88916-116	88916-216	16
88916-117	88916-217	17
88916-118	88916-218	18
88916-119	88916-219	19
88916-120	88916-220	20

NOTES:

- ① PLUGGED (CLOSE) POSITIONS ARE SHADED.
- 2. HEATSTAKE VERSIONS SHOWN ABOVE FOR REFERENCE ONLY.

mat'l. code		surface	tolerance	projection	product family
ISO 1302		ISO 406	ISO 1101	product family	METRAL ACC
ltr	ecn	no	dr	date	title
R					RECEPTACLE KEYING MODULE
angles		linear	.0±.3	MM	title
0°±2'			.00±.13	scale 1:1	dwg no
dr		S.STONER	4/16/93	FCJ	88916
engr		R.DOUTRICH	4/16/93		sheet 4 of 6 size
chr		S.STONER	4/16/93		A3
appd		S.STONER	4/16/93		type
sheet index		revision sheet			Product Customer Drawing

PRODUCT NO. 88916-3YZ NOTE 1

PLUG COMBINATIONS – (FRONT VIEW)

PART NUMBER	CONFIGURATION	APPLICABLE NOTES
88916-301		PRESS PEG
88916-302		PRESS PEG
88916-303		PRESS PEG
88916-304		PRESS PEG
88916-305		PRESS PEG
88916-306		PRESS PEG
88916-307		PRESS PEG

PART NUMBER	CONFIGURATION	APPLICABLE NOTES
88916-308		PRESS PEG

- ① ADD "LF" SUFFIX AT THE END OF PART NUMBER FOR LEAD FREE OPTION.
- 2. THIS PRODUCT MEETS EUROPEAN UNION DIRECTIVES AND OTHER COUNTRY REGULATION AS DESCRIBED IN GS-22-008.
- 3. THE HOUSING WILL WITHSTAND EXPOSURE TO 260°C PEAK TEMPERATURE FOR 15 SECONDS IN A WAVE SOLDER APPLICATION WITH A 1.5mm MINIMUM THICK CIRCUIT BOARD OR FOR 10-20 SECONDS IN A CONVECTION, INFRA-RED OR VAPOR PHASE REFLOW OVEN. SEE APPLICATION NOTES/PROCEDURES IF THEY ARE AVAILABLE.

mat'l. code		surface	tolerance	projection	product family
ISO 1302		ISO 406	ISO 1101		METRAL ACC
ltr	ecn no	dr	date	title	
R				RECEPTACLE KEYING MODULE	
tolerances unless otherwise specified		angles	linear	MM	dwg no
0°±2'			.0±.3	←	88916
			.00±.13	→	sheet 5 of 6
			.000±.051	scale 1:1	size A3
		dr	S.STONER	4/16/93	type Product Customer Drawing
		enrg	R.DOUTRICH	4/16/93	
		chr	S.STONER	4/16/93	
		appd	S.STONER	4/16/93	
sheet index	revision sheet				

PRODUCT NO. 88916-4YZ NOTE 2

PLUG COMBINATIONS - (FRONT VIEW)

PLUGGED POSITION
SEE NOTE 1

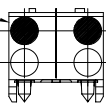

01

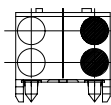

02

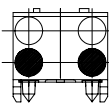

03

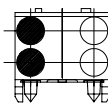

04

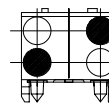

05

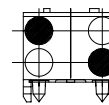

06

PRODUCT NUMBER	COMBINATION NUMBER
88916-401	01
88916-402	02
88916-403	03
88916-404	04
88916-405	05
88916-406	06

NOTES:

1. PLUGGED (CLOSE) POSITION ARE SHOWN SHADE.
2. ADD "LF" SUFFIX AT THE END OF PART NUMBER FOR LEAD FREE OPTION.
3. THIS PRODUCT MEETS EUROPEAN UNION DIRECTIVES AND OTHER COUNTRY REGULATION AS DESCRIBED IN GS-22-008.
4. THE HOUSING WILL WITHSTAND EXPOSURE TO 260°C PEAK TEMPERATURE FOR 15 SECONDS IN A WAVE SOLDER APPLICATION WITH A 1.5mm MINIMUM THICK CIRCUIT BOARD OR FOR 10-20 SECONDS IN A CONVECTION, INFRA-RED OR VAPOR PHASE REFLOW OVEN. SEE APPLICATION NOTES/PROCEDURES IF THEY ARE AVAILABLE.

mat'l. code		surface	tolerance	projection	product family
ISO 1302		ISO 406	ISO 1101		METRAL ACC
ltr	ecn no dr date	tolerances unless otherwise specified			title
R		angles	linear	MM	RECEPTACLE KEYING MODULE
		0°±2'	.0±.3 .00±.13 .000±.051	scale 1:1	dwg no 88916 sheet 6 of 6 size A3
		dr	S.STONER 4/16/93		type Product Customer Drawing
		enrg	R.DOUTRICH 4/16/93		
		chr	S.STONER 4/16/93		
		appd	S.STONER 4/16/93		
sheet index	revision sheet				