

4

3

2

1

THIS DRAWING IS UNPUBLISHED. RELEASED FOR PUBLICATION 27-02-02 .- .  
 © COPYRIGHT 2002 BY TYCO ELECTRONICS CORPORATION. ALL RIGHTS RESERVED.

LOC	DIST	REVISIONS			
P	LTR	DESCRIPTION	DATE	DWN	APVD
F		ECR-06-013400	02-06-06	AM	FWK
F1		REVISED PER ECO-09-024927	10NOV09	KK	AEG
F2		ECR-10-022205	02FEB11	KK	HMR

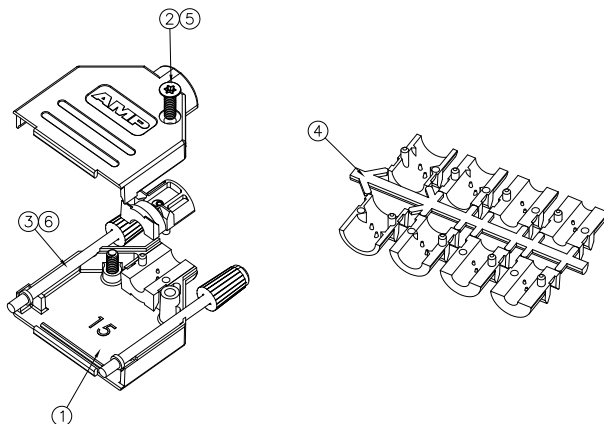
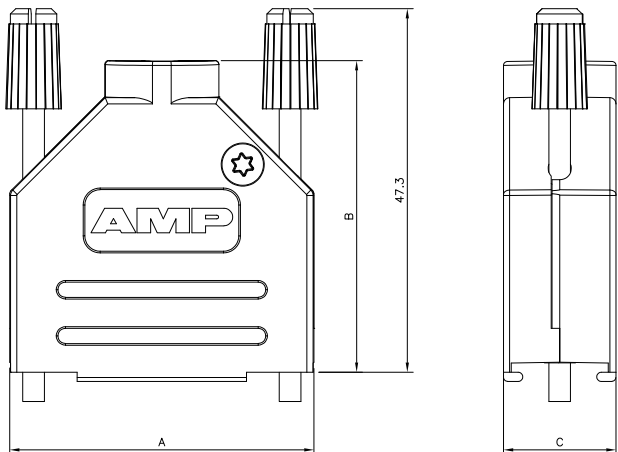

PART NUMBER	A	B	C	ITEM	QTY	BACKSHELL	FIXING SCREW	JACKSCREW	STRAIN RELIEF	FIXING SCREW	JACKSCREW
						HALF	(TYPE) TORQUE DRIVE	M3	SET	(TYPE) POZIDRIVE DRIVE	4-40
6-1478762-7	53.2	47.3	14.6			2	-	2	1	2	-
6-1478762-6	39.5	40.5	14.6			2	-	2	1	2	-
<del>6-1478762-5</del>	31	38.3	14.6			2	-	2	1	2	-
<del>6-1478762-3</del>	53.2	47.3	14.6			2	-	-	1	2	2
<del>6-1478762-2</del>	39.5	40.5	14.6			2	-	-	1	2	2
<del>6-1478762-1</del>	31	38.3	14.6			2	-	-	1	2	2
5-1478762-4 & 3-1478762-7	70.9	52.2	15			2	2	-	1	-	2
5-1478762-3 & 2-1478762-5	53.2	47.3	14.6			2	2	-	1	-	2
5-1478762-2 & 1-1478762-5	39.5	40.5	14.6			2	2	-	1	-	2
5-1478762-1 & 1478762-9	31	38.3	14.6			2	2	-	1	-	2

OBSOLETE  
 OBSOLETE  
 OBSOLETE

1. FOR ASSEMBLY DETAILS REFER TO LEAFLET 0-1478530-1.  
 1-PER BOX OF 100 PARTS  
 OBSOLETE PARTS: OBSOLETE CIS STREAMLINING PER D.RENAUD/D.SINISI

KITS/BAG	DESCRIPTION	PART NUMBER
1	METAL BACKSHELL 37 WAY TOP ENTRY	5-1478762-4
1	METAL BACKSHELL 25 WAY TOP ENTRY	5-1478762-3
1	METAL BACKSHELL 15 WAY TOP ENTRY	5-1478762-2
1	METAL BACKSHELL 9 WAY TOP ENTRY	5-1478762-1
100	METAL BACKSHELL 25 WAY TOP ENTRY	6-1478762-7
100	METAL BACKSHELL 15 WAY TOP ENTRY	6-1478762-6
100	METAL BACKSHELL 9 WAY TOP ENTRY	6-1478762-5
100	METAL BACKSHELL 25 WAY TOP ENTRY	6-1478762-3
100	METAL BACKSHELL 15 WAY TOP ENTRY	6-1478762-2
100	METAL BACKSHELL 9 WAY TOP ENTRY	6-1478762-1
100	METAL BACKSHELL 37 WAY TOP ENTRY	3-1478762-7
100	METAL BACKSHELL 25 WAY TOP ENTRY	2-1478762-5
100	METAL BACKSHELL 15 WAY TOP ENTRY	1-1478762-5
100	METAL BACKSHELL 9 WAY TOP ENTRY	1478762-9

OBSOLETE  
 OBSOLETE  
 OBSOLETE

PART NUMBER	A	B	C	ITEM
6-1478762-7	53.2	47.3	14.6	
6-1478762-6	39.5	40.5	14.6	
<del>6-1478762-5</del>	31	38.3	14.6	
<del>6-1478762-3</del>	53.2	47.3	14.6	
<del>6-1478762-2</del>	39.5	40.5	14.6	
<del>6-1478762-1</del>	31	38.3	14.6	
5-1478762-4 & 3-1478762-7	70.9	52.2	15	
5-1478762-3 & 2-1478762-5	53.2	47.3	14.6	
5-1478762-2 & 1-1478762-5	39.5	40.5	14.6	
5-1478762-1 & 1478762-9	31	38.3	14.6	

THIS DRAWING IS A CONTROLLED DOCUMENT.

DWN	A.BEKEN	27-02-02
CHK	R.G.	27-02-02
APVD	F.W-KING	27-02-02

NAME: AM STRAIGHT ENTRY

SIZE: A3 CAGE CODE: 00779 DRAWING NO: C-1478762

RESTRICTED TO: -

CUSTOMER DRAWING SCALE: 1:1 SHEET: 1 OF 1 REV: F2

Tyco Electronics Corporation  
 Stanmore, Middlesex, HA7 4RS

AMP 1470-19 REV 31MAR2000