

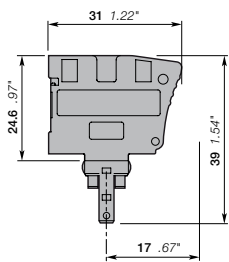

PG5 Component Plugs

Terminal Blocks Accessories



Features and Benefits

- Ease components installation (components not supplied with plug) with our quick plug-in mounting system (spring technology) which avoids soldering process,
- Compatible with 8.8 x 3.2 mm 0.346 x 0.125 in components such as resistors or diodes,
- Maximum dissipated power: 1 W.

Main Technical Data

	IEC	cULus - CSA	Ex e
Rated current			
Rated voltage	Standard use 400 V	150 V	
Impulse withstand voltage	6000 V		
Protection	IP 20	NEMA 1	

Mounting Instructions

Plug In

Tool
Torque

Material Specifications	Insulating material	Polyamide	
Flammability	NF F 16 101	V0	
Ambient temperature min/max	Service IEC 60068-2-1	-55 +110 °C	-67 +230 F
	Storage	-55 +110 °C	-67 +230 F
	Installing	-5 +40 °C	-23 +104 F

Ordering Details

PG5 Component Plugs

Description	Type	Order Code	Pack ^(mg) pieces	Weight g (1 pce)
Components in series with circuit	Dark Grey <input checked="" type="checkbox"/> PG5	1SNK 900 401 R0000	20	3.45

PG5 Accessories

Description	Type	Order Code	Pack ^(mg) pieces	Weight g (1 pce)
1 Blank card	White <input type="checkbox"/> MC512	1SNK 140 000 R0000	22	0.06
Universal wire markers holder	Grey <input type="checkbox"/> UMH	1SNK 900 611 R0000	10	0.20
Self adhesive strip	White <input type="checkbox"/> SAT5	1SNK 900 614 R0000	5	6.00

PG5 Mounting Instructions

