

ALL RIGHTS RESERVED. NO PORTION OF THIS PUBLICATION, WHETHER IN WHOLE OR IN PART CAN BE REPRODUCED WITHOUT THE EXPRESS WRITTEN CONSENT OF SPC TECHNOLOGY.



RoHS Compliant

REVISIONS		Doc. No. SPC-F005	Effective 12/21/08	Doc No B90				
DWG #	REV	DESCRIPTION	DRAWN	DATE	CHECKD	DATE	APPRVD	DATE
1950	C	Released	JJM	10/09/08	JJM	10/09/08	JJM	10/09/08

SPC Type No.	Screw Size	Inside Diameter		Outside Diameter		Thickness	
		Basic	Tolerance	Basic	Tolerance	Basic	Max Min
SPC21883	4	.125	.008 .005	.312	.008 .005	.032	.040 .025
SPC21884	6	.156	.008 .005	.375	.015 .005	.049	.065 .036
SPC21885	8	.188	.008 .005	.438	.015 .005	.049	.065 .036
SPC21886	10	.219	.008 .005	.500	.015 .005	.049	.065 .036
SPC21887	1/4	.281	.015 .005	.625	.015 .005	.065	.080 .051

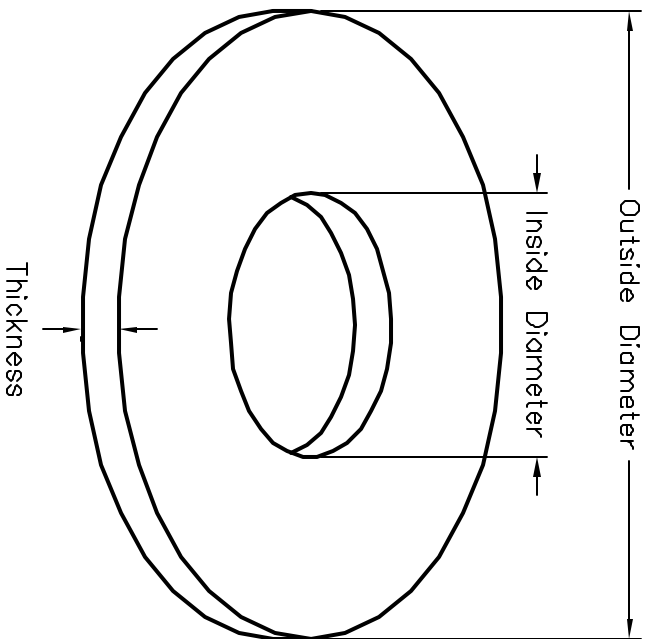

MATERIAL: Steel, Nickel Plated

DISCLAIMER:
ALL STATEMENTS AND TECHNICAL INFORMATION CONTAINED HEREIN ARE BASED UPON INFORMATION AND/OR TESTS WE BELIEVE TO BE ACCURATE AND RELIABLE. SINCE CONDITIONS OF USE ARE BEYOND OUR CONTROL, THE USER SHALL DETERMINE THE SUITABILITY OF THE PRODUCT FOR THE INTENDED USE AND ASSUME ALL RISK AND LIABILITY WHATSOEVER IN CONNECTION THEREWITH.

UNLESS OTHERWISE SPECIFIED, DIMENSIONS ARE FOR REFERENCE PURPOSES ONLY.

DRAWN BY:	DATE:
Jason Nash	10/09/08
CHECKED BY:	DATE:
JJM	10/09/08
APPROVED BY:	DATE:
JJM	10/09/08

DRAWING TITLE:

FLAT STEEL WASHER



SPC TECHNOLOGY

SIZE	DWG. NO.	ELECTRONIC FILE	REV
A	TA-955	TA-955.DWG	A
SCALE:	NTS	U.O.M.: INCHES	SHEET: 1 OF 1