

PART NO. STYLE 1 .098 (2.5) DIA. HOLE	PART NO. STYLE 2 .138 (3.5) DIA. HOLE	"A" ±.015 (0.38)
MDLSP1-02M-01	MDLSP2-02M-01	.078 (2.0)
MDLSP1-04M-01	MDLSP2-04M-01	.156 (4.0)
MDLSP1-05M-01	MDLSP2-05M-01	.197 (5.0)
MDLSP1-06M-01	MDLSP2-06M-01	.236 (6.0)
MDLSP1-08M-01	MDLSP2-08M-01	.314 (8.0)
MDLSP1-10M-01	MDLSP2-10M-01	.394 (10.0)
MDLSP1-12M-01	MDLSP2-12M-01	.472 (12.0)
MDLSP1-14M-01	MDLSP2-14M-01	.551 (14.0)
MDLSP1-16M-01	MDLSP2-16M-01	.630 (16.0)
MDLSP1-18M-01	MDLSP2-18M-01	.709 (18.0)
MDLSP1-20M-01	MDLSP2-20M-01	.787 (20.0)
MDLSP1-22M-01	MDLSP2-22M-01	.866 (22.0)

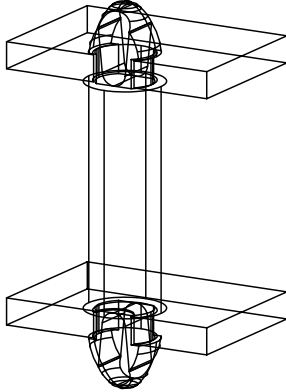
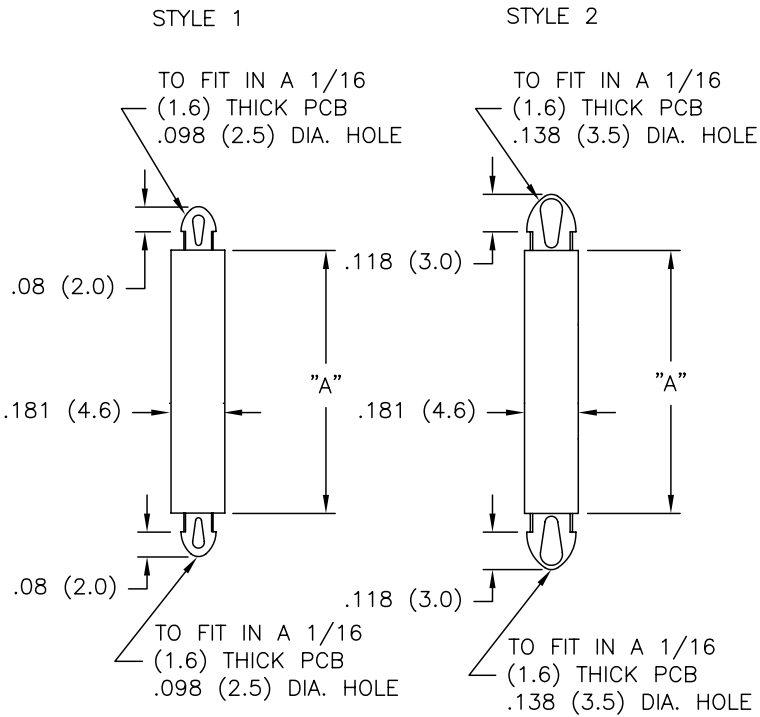

NOTES:

- MATERIAL: NYLON 6/6 (RMS-01).
- COLOR: NATURAL.

C CHANGED FILE NO. AND TITLE BLOCK SM 05.08.01		TOLERANCES UNLESS NOTED .XX=±.010 .XXX=±.005 FRAC=±1/64 ANG=±1°		FILE # MDLSP1	DWN: P.B.	APP:	DWG IN IN (MM) FINAL	PRINT TYPE CA
B P/N MDLSP1(2)-05-01 ADDED TO TABLE J.L. 9.22.99		MATERIAL: SEE NOTES		DT: 09-20-94	DT:	PART #		
A "100" & "138" REMOVED FROM P/N PB 110794		RE: RICHCO, INC.		RICHCO INC. PO BOX 804238, CHICAGO, 60680 (773) 539-4060		SEE TABLE		
REV DESCRIPTION ENGR DATE								