

Introducing the **MDLCBS**— Metal Dual Locking Circuit Board Support

Features and Benefits

- Highly conductive and impact resistant
- Innovative removable design
- High temperature and corrosion resistant stainless steel
- Metal lends superior strength and durability
- RoHS Compliant
- Patented design

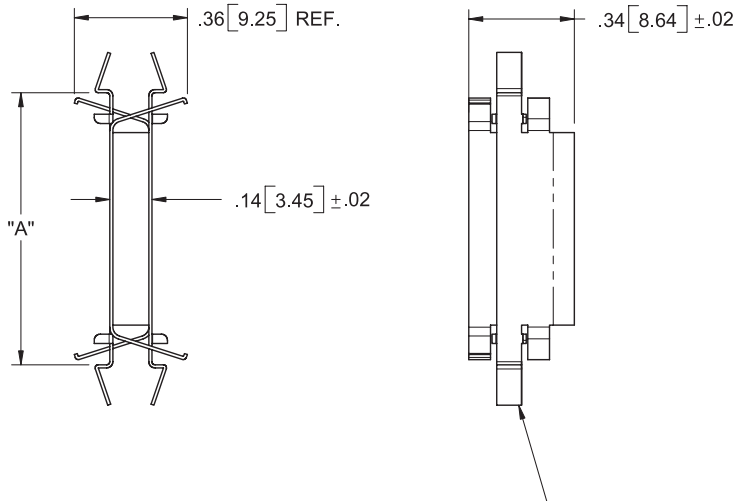
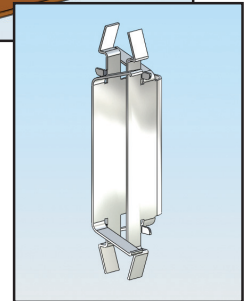
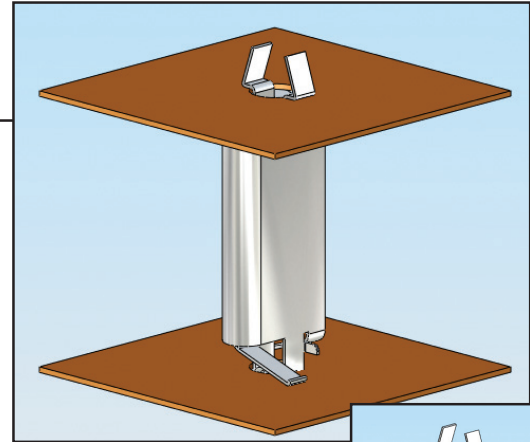

TO SNAP-LOCK IN A .156±.003 [4±0.08] DIA. HOLE,
IN A .062 [1.57] PANEL THICKNESS

Material: Stainless Steel, RMS-320	Standard Pack: 1,000 per bag
Part No.	"A" ±.015 (.04)
MDLCBS-4	3/8 (9.5)
MDLCBS-6	1/2 (12.7)
MDLCBS-8	5/8 (15.9)
MDLCBS-12	7/8 (22.2)
MDLCBS-16	1-1/8 (28.6)

Markets

- Automotive
- Consumer Electronics
- Security Systems
- Office Equipment
- White Goods
- Telecommunications Equipment

Other Related Richco Product Solutions

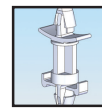

DLCBS

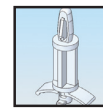

LCBS

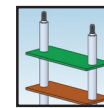

TNSP

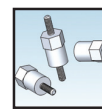

MTNSP

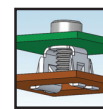

GCBS

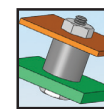

QM

FOR FURTHER INFORMATION AND FREE SAMPLES PLEASE CONTACT YOUR LOCAL RICHCO OFFICE



Richco UK (Int'l HQ) Tel: (44) 1474 327527
 Richco Benelux Tel: (31) 334556262
 Richco Germany Tel: (49) 8171 43280
 Richco Finland Tel: (358) 925221500

Richco France Tel: (33) 47208 7140
 Richco Spain Tel: (34) 90222 2250
 Richco Italy Tel: (39) 051 6325 266
 Richco Sweden Tel: (46) 8667 9185