

4

3

2

1

THIS DRAWING IS UNPUBLISHED. RELEASED FOR PUBLICATION
 © COPYRIGHT 19 BY AMP INCORPORATED. ALL RIGHTS RESERVED.

LOC	DIST	REVISIONS			
P	LTR	DESCRIPTION	DATE	DWN	APVD
G	14	H REV & REDRAW / 0720-0777-95	28SEP95	MLE	NB

AMP WIRE RANGE	E13288	LR7189 Certified
16-14 AWG SOLID OR STRANDED	16-14 AWG SOLID OR STRANDED	16-14 AWG SOLID OR STRANDED

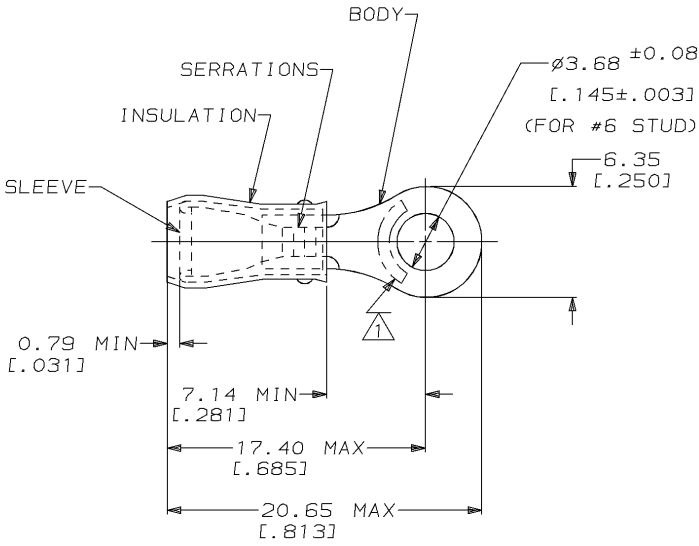

- 1 STAMP AMP 16-14* APPROX AS SHOWN
- 2 WIRE INSUL DIA, 2.92-4.32 [.115-.170]
- 3 TONGUE MATERIAL THK, 0.79±0.05 [.031±.002]

QTY	PACKAGE TYPE	PART NO
5000	ON TAPE, REEL	50881-2
1000	LOOSE PIECE	50881

AMP INCORPORATED CUSTOMER SERVICE SYSTEM		MAX RECOMMENDED OPERATING TEMPERATURE: 105°C [221°F]	THIS DRAWING IS A CONTROLLED DOCUMENT FOR AMP INCORPORATED. IT IS SUBJECT TO CHANGE AND THE CONTROLLING ENGINEERING ORGANIZATION SHOULD BE CONTACTED FOR THE LATEST REVISION.		DWN M ELLIS 28SEP95	AMP Incorporated Harrisburg, PA 17105-3608	
FOR ADDITIONAL PRODUCT INFORMATION OR COPIES OF DRAWINGS AND TECHNICAL DOCUMENTS	PRODUCT INFORMATION CENTER 1-800-522-6752	VOLTAGE RATING: 300 V MAX	DIMENSIONS: mm [in]	TOLERANCES UNLESS OTHERWISE SPECIFIED: 0 PLC ±- 1 PLC ±- 2 PLC ±0.20 [.008] 3 PLC ±- 4 PLC ±- ANGLES ±-	CHK C PRESNELL 28SEP95		NAME N BIRCH
FOR APPLICATION TOOLING INFORMATION	TOOLING ASSISTANCE CENTER 1-800-722-1111	CIRCULAR MIL AREA: 1.04mm²-2.62mm² [2050-5180]		MATERIAL BODY, SLV, COPPER PER ASTM B 152 INSUL, NYLON, COLOR, BLUE	FINISH BODY & SLV, TIN PLATE PER MIL-T-10727	PRODUCT SPEC UL 486A	TERMINAL, RING TONGUE, PIDG™, WIRE SIZE, 16-14 AWG
FOR ORDER ENTRY	1-800-526-5142					APPLICATION SPEC	SIZE A3
					WEIGHT -	CAGE CODE 00779	DRAWING NO C-50881
					CUSTOMER DRAWING	SCALE 4:1	SHEET 1 OF 1

AMP 1470-19 REV 09MAY94
 26 MAY 1995 16:23:53 AMP10390 <UJ128A>DEPT1132-U, DWG1132-U, RBY-U, PID6-U, CUST