

More power. More comfort. More Productivity.

Get all three with the new selection of compound
action pliers from Crescent[®].

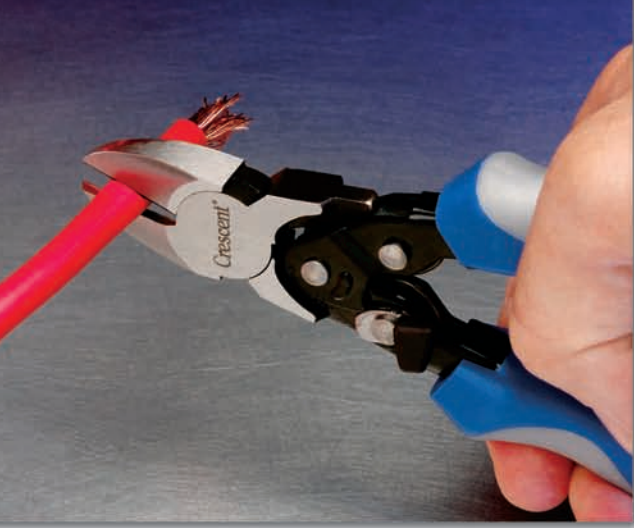

Get the compound action advantage.



Crescent brand Pro Series compound action pliers offer a winning combination of increased power and unparalleled comfort for exceptional ease of use. Their advanced compound action design provides up to 60% more cutting or holding power with the same amount of effort compared to standard pliers. In addition, the ergonomically-designed co-molded grips are 30% wider than those found on standard pliers. The wider contact area spreads out the load of the grip against the fingers and palm for much improved comfort and added control. Add famous Crescent quality and durability to these outstanding features and you have tools that will pay for themselves many times over with increased productivity and long service life.

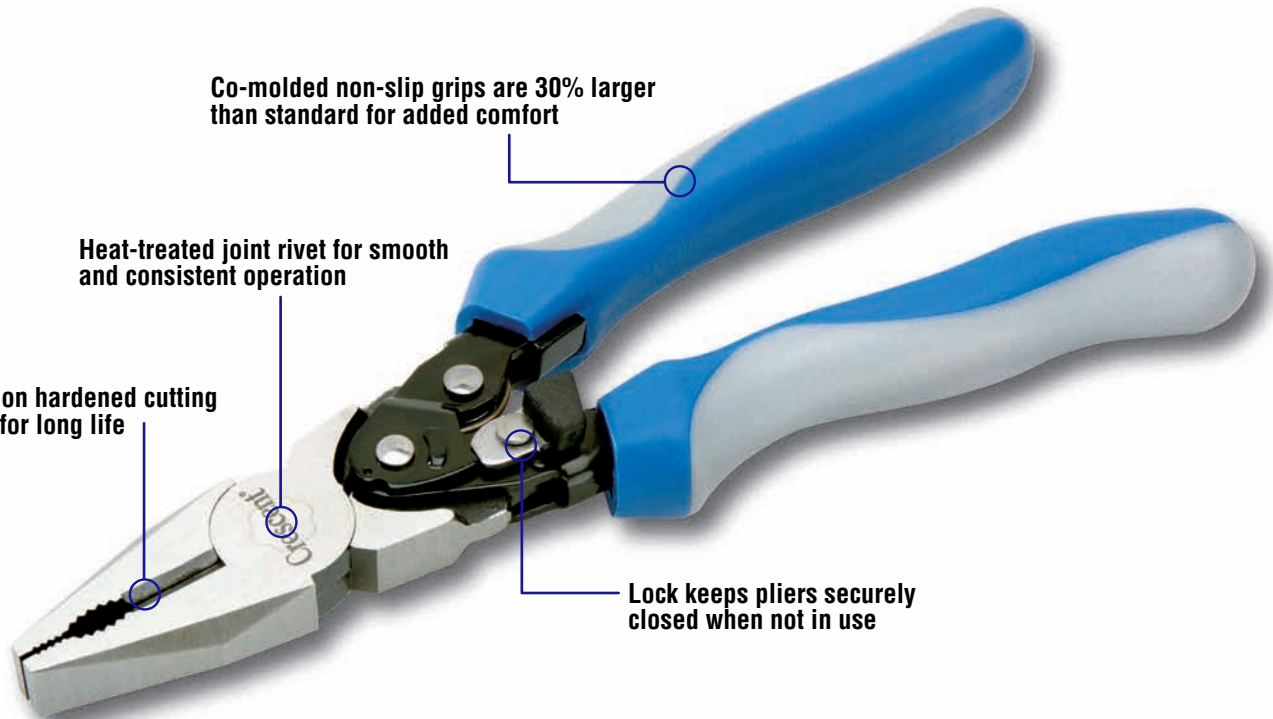

Co-molded non-slip grips are 30% larger than standard for added comfort

Heat-treated joint rivet for smooth and consistent operation

Induction hardened cutting edges for long life

Lock keeps pliers securely closed when not in use

- Heat-treated chrome vanadium alloy steel construction for superior strength
- Patented high-leverage design gives up to 60% power gain
- Special heat-treated steel spring holds jaws comfortably open. Tested to over 1,000,000 cycles

PS20509C



PS5429C



PS6549C



Catalog Number	Description
PS20509C	9" Lineman's Compound Action Pliers, Pro Series
PS6549C	9" Long Nose Compound Action Pliers, Pro Series
PS5429C	9" Diagonal Compound Action Pliers, Pro Series

COOPER Hand Tools

Campbell® CaulkMaster® Crescent® Diamond® Erem® Kahnetics® Lufkin®
 Nicholson® Plumb® H.K.Porter® Weller® Wire-Wrap® Wiss® Xcelite®

P.O. Box 728
 Apex, NC 27502
www.cooperhandtools.com

CHT06-10892/MW-????/25M/PRINTED 7/06/USA COOPER NO. 550544 © 2006, Cooper Industries, LLC
 Specifications subject to change without notice.