

FiberInspector™ Mini Video Microscope

Instruction Sheet

The FT500 FiberInspector™ Mini video microscope is a hand-held, 200x magnification probe and display used to inspect fiber optic end-faces on patch cord and bulkhead connectors.

The video microscope comes with the following:

- FT500 probe and display
- AC adapter/charger
- Standard probe tip set (ST, SC, and universal 2.5 mm)
- Hex key
- Instruction sheet
- Soft carrying case

If anything is missing or damaged, contact the place of purchase immediately.

Safety Information



To avoid possible eye damage caused by hazardous radiation, never look directly into optical output connectors. Some sources produce invisible radiation that can permanently damage your eyes.

To avoid possible fire, electric shock, personal injury, or damage to the video microscope:

- **Do not open the case; no user-serviceable parts are inside.**
- **Use only the ac adapter/charger provided to power the display and charge the battery.**

Charging the Battery

Charge the battery for about 4 hours before using battery power for the first time. To charge the battery, connect the ac adapter/charger and set the switch on the display to **OFF/CHARGE**. The LED on the ac adapter/charger is red during charging and green when charging is complete. A fully-charged battery lasts about 3 hours when the display is on continuously.

⚠ Warning ⚠

To avoid possible fire, electric shock, personal injury or damage to the video microscope, use only the ac adapter/charger provided to power the display and charge the battery.

Note

*The battery charges only when the display's power switch is in the **OFF/CHARGE** position.*

Features and Use

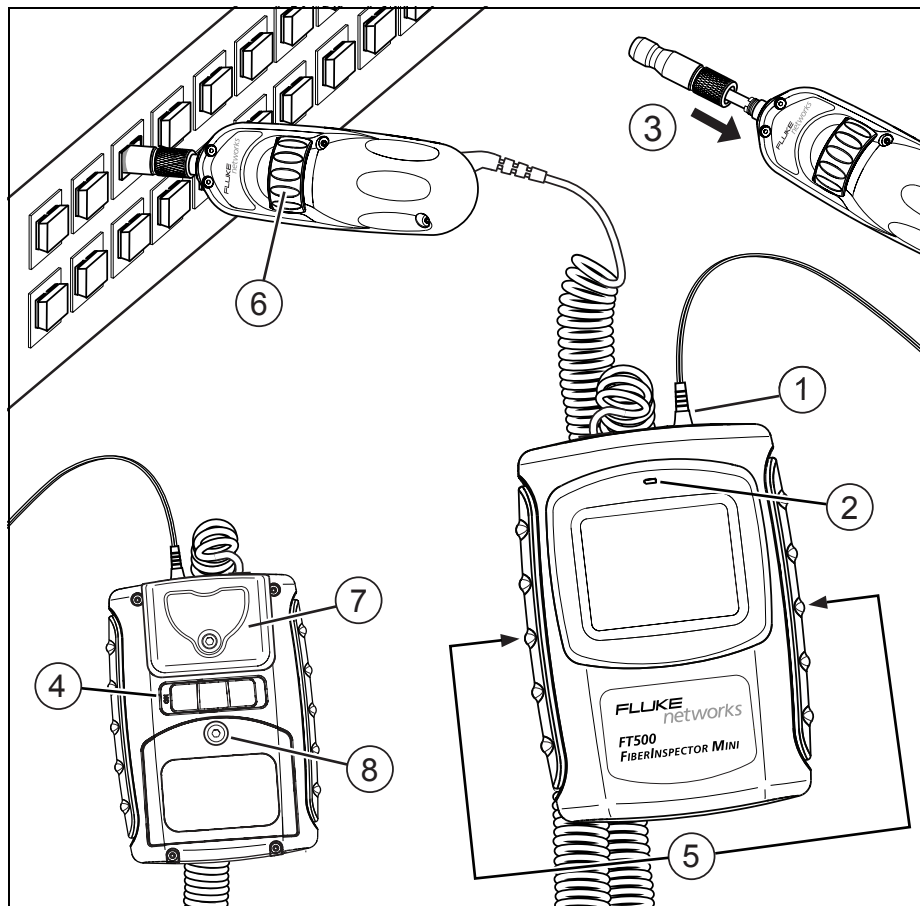

etn01.eps

- ① To ensure continuous operation, connect the ac adapter whenever possible.
- ② The LED lights when remaining battery life is about 30 minutes.
- ③ Screw an adapter tip onto the fiber probe to match the connection you are inspecting. Use the universal tip for patch cords. Use the connector-specific tips for bulkhead connectors.
- ④ Set the power mode:
 - **OFF/CHARGE:** Display is off. The battery charges when the ac adapter/charger is connected.
 - **ON:** Display is always on.
 - **GRIP:** Display is on when you squeeze the grip triggers (⑤). Use this mode to conserve battery power.

Note

*Set the switch to **OFF/CHARGE** when not using the display. If the switch is left in the **GRIP** position, the display may be turned on unintentionally, draining the battery.*

- ⑤ Grip triggers. See **GRIP** under ④.
- ⑥ Turn the wheel to focus the image.
- ⑦ Used with the optional TPak™ kit to hang the display. May be removed using the hex key included.
- ⑧ Battery door. See "Replacing the Battery".

Maintenance

Clean the LCD display with glass cleaner and a soft, lint-free cloth. Clean the display and probe housings with a soft cloth dampened with water or a mild detergent. Do not use solvents or abrasive cleansers.

Replacing the Battery

Replace the NiMH battery when its life becomes noticeably shorter. To replace the battery, use the hex key provided to remove the battery door screw. Remove and disconnect the battery. Connect and install the new battery, running the battery wires around, not under, the battery. Replace the battery door and secure it with the hex screw.

Getting Service

Contact Fluke Networks for information on authorized Fluke Networks service centers.

Accessories

The following accessories are available from Fluke Networks for the FT500 FiberInspector Mini video microscope. Visit the Fluke Networks website at www.flukenetworks.com for a complete list of fiber test equipment and accessories.

Description	Fluke Networks Model
TPak™ meter hanging kit (Lets you hang the display from a strap or a magnet.)	TPAK
Fiber Optic Cleaning Kit	NFC-Kit-Case
Accessory tip set (LC, FC, and universal 1.25 mm)	NFM110
NiMH battery pack	NFM120
AC adapter/charger (100 V-240 V)	Contact Fluke Networks

Registration

Registering your product with Fluke Networks gives you access to valuable information on product updates, troubleshooting tips, and other support services. To register, fill out the online registration form on the Fluke Networks website at www.flukenetworks.com/registration.

Contacting Fluke Networks



www.flukenetworks.com



support@flukenetworks.com



+1-425-446-4519

- Australia: 61 (2) 8850-3333 or 61 (3) 9329-0244
- Beijing: 86 (10) 6512-3435
- Brazil: 11 3759 7600
- Canada: 1-800-363-5853
- Europe: +44-(0)1923-281-300
- Hong Kong: 852 2721-3228
- Japan: 03-3434-0510
- Korea: 82 2 539-6311
- Singapore: 65 6799-5566
- Taiwan: (886) 2-227-83199
- USA: 1-800-283-5853

Visit our website for a complete list of phone numbers.

Specifications

General Specifications

Temperature range	Operating: 0 °C to 40 °C Storage: -10 °C to +60 °C
Humidity range	Operating: 0 % to 45 % RH non-condensing Storage: 0 % to 95 % RH non-condensing
Weight	8.1 oz (230 g) (probe and display)
Certifications	CE

Probe Specifications

Magnification	200X
Camera type	0.33 in (8.38 mm) CMOS sensor
Light source	LED, >100,000 hr life
Lighting technique	Coaxial
Dimensions	5.5 in x 1.8 in x 1.7 in (140 mm x 46 mm x 44 mm) (length depends on adapter tip)

Display Specifications

Display type	1.8 in (46 cm) TFT LCD
Video input	NTSC
Power source	Rechargeable NiMH battery or ac power
AC adapter/ charger	Charges six NiMH cells Input: 100-240 Vac, 0.5 A, 47 Hz to 63 Hz Output: 9 V dc, 0.4 A
Battery life	3 hours continuous use
Dimensions	3.9 in x 2.8 in x 1.7 in (100 mm x 72 mm x 43 mm, with TPAK adapter)

LIMITED WARRANTY AND LIMITATION OF LIABILITY

Fluke Networks mainframe products will be free from defects in material and workmanship for one year from the date of purchase. Parts, accessories, product repairs and services are warranted for 90 days, unless otherwise stated. Ni-Cad, Ni-MH and Li-Ion batteries, cables or other peripherals are all considered parts or accessories. This warranty does not cover damage from accident, neglect, misuse, alteration, contamination, or abnormal conditions of operation or handling. Resellers are not authorized to extend any other warranty on Fluke Networks' behalf. To obtain service during the warranty period, contact your nearest Fluke Networks authorized service center to obtain return authorization information, then send your defective product to that Service Center with a description of the problem. THIS WARRANTY IS YOUR ONLY REMEDY. NO OTHER WARRANTIES, SUCH AS FITNESS FOR A PARTICULAR PURPOSE, ARE EXPRESSED OR IMPLIED. FLUKE NETWORKS IS NOT LIABLE FOR ANY SPECIAL, INDIRECT, INCIDENTAL OR CONSEQUENTIAL DAMAGES OR LOSSES, ARISING FROM ANY CAUSE OR THEORY. Since some states or countries do not allow the exclusion or limitation of an implied warranty or of incidental or consequential damages, this limitation of liability may not apply to you.

Fluke Networks
PO Box 777
Everett, WA 98206-0777
USA

4/04