

PART NUMBER	"A" (HOLE DIAMETER)	"B" (PANEL THICKNESS)	"C"	"D" REF.	"E"	FIGURE
USR 1131	.197 (5.0)	.158-.276 (4.0-7.0)	.472 (12.0)	.433 (11.0)	.153 (3.9)	1.
USR 1132	.236 (6.0)		.630 (16.0)			2.
USR 1133	.315 (8.0)	.118-.394 (3.0-10.0)	.787 (20.0)	.551 (14.0)	.157 (4.0)	3.

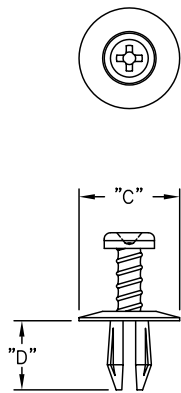

FIG. 1.

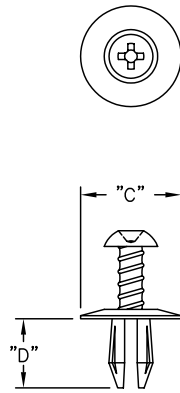

FIG. 2.

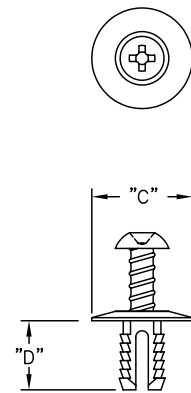
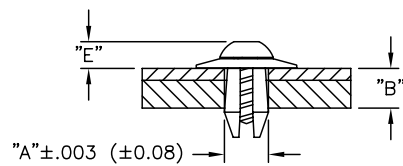

FIG. 3.



TYPICAL ASSEMBLY

NOTES:

1. MATERIAL: NYLON 6/6 (RMS-115).
2. COLOR: BLACK.

TITLE: UNSCREWING SNAP RIVETS			DWG IN IN.(MM)	FINAL	
TOLERANCES UNLESS NOTED	FILE #	USR	DWN: S.M.	APP:	PART #
.XX=±.020	MAT'L:	SEE NOTES	DT: 10/30/00	DT:	USR-SERIES
.XX=±.015	RE:	RICHCO INC.	RICHCO INC.		PRINT TYPE
FRAC=1/32			PO BOX 804238, CHICAGO, 60680		CA
ANG=±1°			(773) 539-4060		
C	TABLE CORRECTED	SM 01.18.02			
B	ADDED RMS-115 AND CHANGED FILE NO.	S.M 03.29.01			
A	COMPLETELY RE-DRAWN	SM 11.01.00			
REV	DESCRIPTION	ENGR DATE			