

THIS COPY IS PROVIDED ON A RESTRICTED BASIS AND IS NOT TO BE USED IN ANY WAY DETRIMENTAL TO THE INTERESTS OF PANDUIT CORP.

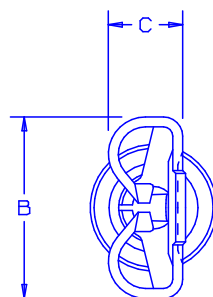
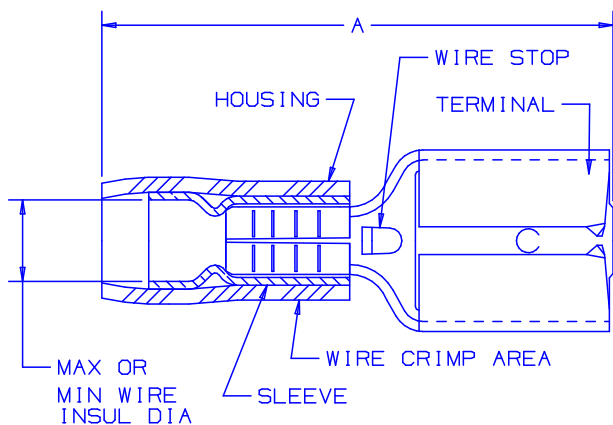

NOTES:

- UL LISTED AND CSA CERTIFIED FOR:
  - A. 300V MAX VOLTAGE RATING
  - B. 194°F (90°C) MAX TEMP RATING
  - C. STRANDED COPPER WIRE ONLY
  - D. 6-12 LBS INITIAL INSERTION/WITHDRAWAL FORCE
- MATERIAL:
  - A. STAMPING-BRASS, TIN PLATED
  - B. HOUSING-NYLON
  - C. SLEEVE-BRASS, TIN PLATED
- DIMENSIONS IN BRACKETS ARE IN mm OR mm<sup>2</sup>
- INSTALLATION TOOLS: UL/CSA: CT-500  
PANDUIT APPROVED: CT-100, CT-160, CT-260, CT-400, CT-460, CT-1551, CT-1550
- WIRE STRIP LENGTH: 9/32 ±1/32 (7.1 ±.8)
- PKG QTY:
  - C = 100
  - M = 1000

| PART NUMBER | TAB SIZE    | WIRE RANGE AWG | COLOR | MAX. INSUL.    | MIN. INSUL.    | DIMENSIONS in. |               |               |
|-------------|-------------|----------------|-------|----------------|----------------|----------------|---------------|---------------|
|             |             |                |       |                |                | A ±.03         | B ±.01        | C ±.004       |
| DNF18-250   | .250 X .032 | 22-18          | RED   | .138<br>(3.51) | .040<br>(1.02) | .81<br>(20.57) | .29<br>(7.37) | .12<br>(3.05) |
| DNF14-250   | .250 X .032 | 16-14          | BLUE  | .162<br>(4.11) | .050<br>(1.27) | .83<br>(21.08) | .29<br>(7.37) | .12<br>(3.05) |



| 07  | 7/03  | KLFU |     | ADDED INTERNAL SERRATIONS          |       |      |     |  |  |
|-----|-------|------|-----|------------------------------------|-------|------|-----|--|--|
| 06  | 1/01  | KMD  | SKB | CAD FILE SPEC. WAS N41200AA_PCD_05 | 8938  | JAC  | CCH |  |  |
| 05  | 3/99  | JKD  |     | ADDED CT-1551 & CT-1550 TOOLS      | 07632 |      |     |  |  |
| 04  | 12/96 | JB   | RLS | ADDED TO TABLE "MIN INSUL"         | 05427 | LA   | DBH |  |  |
| 03  | 4/95  | MS   | RLS | REMOVED SLOT FROM TERMINAL         | 03132 | LA   | KRS |  |  |
| REV | DATE  | BY   | CHK | DESCRIPTION                        | ECN # | CUST | PM  |  |  |

A41200\_07

**PANDUIT** CORP. TINLEY PARK, ILLINOIS

FEMALE DISCONNECTS, NYLON INSULATED, FUNNEL .250 X .032

|          |       |       |             |
|----------|-------|-------|-------------|
| DRAWN BY | CHK'D | SCALE | DRAWING NO. |
| FES      | LA    | NONE  | A41200      |