

DRAWING MADE IN THIRD ANGLE PROJECTION

THIS DRAWING IS UNPUBLISHED. RELEASED FOR PUBLICATION

© COPYRIGHT 19 BY AMP INCORPORATED. ALL INTERNATIONAL RIGHTS RESERVED.

LOC	DIST	ZONE	LTR	REVISIONS	DATE	APPD
AF	50		B	REDRAWN & ADD -2 PR 90-53	3/20/90	PF/JR

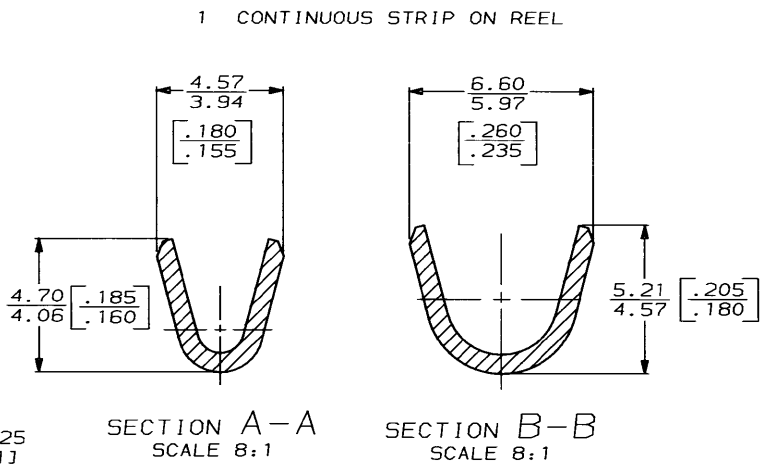
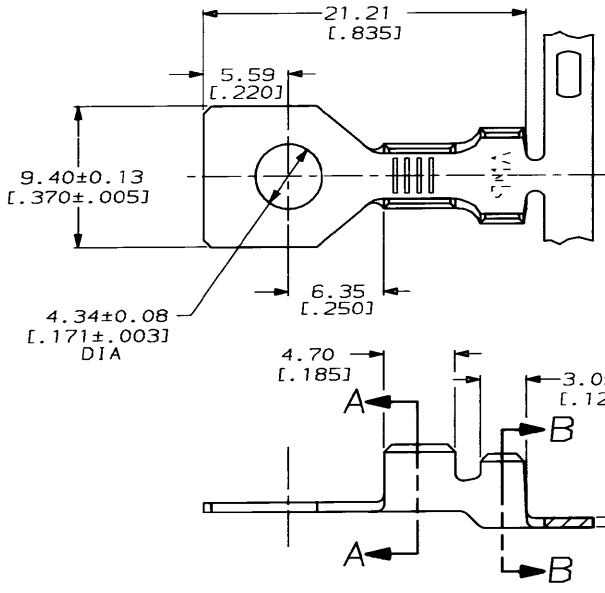

METRIC

F or 0	5.59 [.220]	6.35 [.250]	F	3.56 [.140]	2.16 [.085]	2.04 [.14]
					1.98 [.078]	1.34 [.16]
					1.85 [.073]	0.84 [.18]
TYPE	WIDTH	STRIP LENGTH ±0.38 [±.015]	TYPE	WIDTH	±0.051 [±.002] HEIGHT	WIRE
INSUL BARREL CRIMP			WIRE BARREL CRIMP			

#2 HARD BRASS	2.16-3.56 DIA [.085-.140]	0.8mm ² -2.0mm ² [18-14] AWG	62975-2
1/4 HARD PHOS BRONZE			62975-1
MATERIAL	INSULATION RANGE	WIRE RANGE	PART NO
SEE TABLE			
FINISH 0.02032 [.000080] MIN TIN PL PER MIL-T-10727	DR 5/20/90 P FORMY CHK 9/20/90 JK BWH APPD 5/20/90 S YETTER PRODUCT SPEC -	AMP Incorporated Harrisburg, PA 17105-3608	
	APPLICATION SPEC -	NAME RING	
WEIGHT -		SIZE B	CAGE CODE 00779
		DRAWING NO 62975	
	SCALE 4:1	SHEET 1 OF 1	

CUSTOMER DRAWING

AMP 1470-15 REV 11-89