

4

3

2

1

THIS DRAWING IS UNPUBLISHED. RELEASED FOR PUBLICATION  
 © COPYRIGHT 19 BY AMP INCORPORATED. ALL RIGHTS RESERVED.

| LOC | DIST | REVISIONS          |         |     |      |
|-----|------|--------------------|---------|-----|------|
| P   | LTR  | DESCRIPTION        | DATE    | DWN | APVD |
| G   | 14   | REV / 0L20-0197-97 | 21AUG97 | MLE | SB   |

|                             |                             |                             |
|-----------------------------|-----------------------------|-----------------------------|
| AMP WIRE RANGE              | E13288                      | LR7189 Certified            |
| 12-10 AWG SOLID OR STRANDED | 12-10 AWG SOLID OR STRANDED | 12-10 AWG SOLID OR STRANDED |

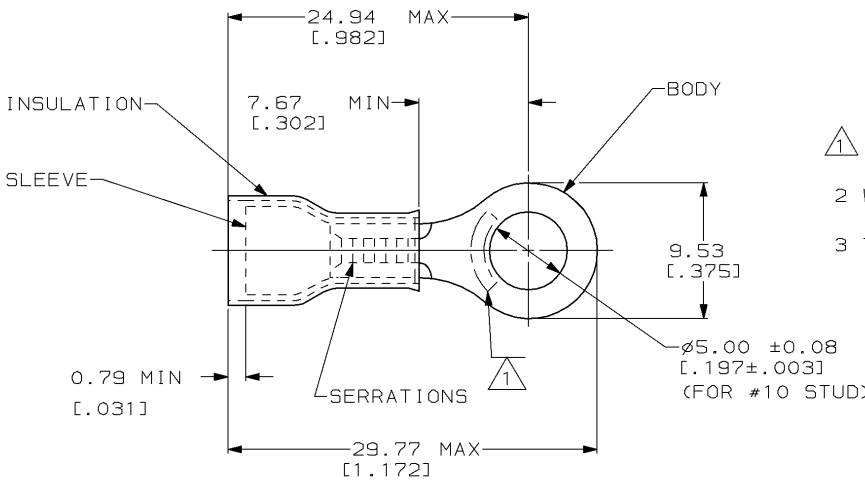

- 1 STAMP AMP 12-10\* APPROX AS SHOWN
- 2 WIRE INSUL DIA, 4.32-7.62 [0.170-.300]
- 3 TONGUE MATERIAL THK, 0.99±0.05 [0.039±.002]

|      |                  |           |
|------|------------------|-----------|
| ---  | -----            | -----     |
| 50   | LOOSE PIECE, BOX | 8-35364-2 |
| 1500 | ON TAPE, REEL    | 2-35364-1 |
| 500  | LOOSE PIECE      | 35364     |
| QTY  | PACKAGE TYPE     | PART NO   |

|  |  |   |  |  |                              |   |
|--|--|---|--|--|------------------------------|---|
| AMP INCORPORATED<br>CUSTOMER SERVICE SYSTEM                                      |  | MAX RECOMMENDED OPERATING TEMPERATURE:<br>105° C (221° F)                   | THIS DRAWING IS A CONTROLLED DOCUMENT FOR AMP INCORPORATED.<br>IT IS SUBJECT TO CHANGE AND THE CONTROLLING ENGINEERING ORGANIZATION SHOULD BE CONTACTED FOR THE LATEST REVISION. |  | DWN<br>M ELLIS<br>17APR95    | AMP Incorporated<br>Harrisburg, PA 17105-3608         |
| FOR ADDITIONAL PRODUCT INFORMATION OR COPIES OF DRAWINGS AND TECHNICAL DOCUMENTS | PRODUCT INFORMATION CENTER<br>1-800-522-6752 | VOLTAGE RATING:<br>-<br>300V MAX  | DIMENSIONS:<br>mm [in]   | TOLERANCES UNLESS OTHERWISE SPECIFIED:<br>0 PLC ±-<br>1 PLC ±-<br>2 PLC ±0.20 [0.008]<br>3 PLC ±-<br>4 PLC ±-<br>ANGLES ±- | CHK<br>C BRESNELL<br>17APR95 |   |
| FOR APPLICATION TOOLING INFORMATION  | TOOLING ASSISTANCE CENTER<br>1-800-722-1111  | CIRCULAR MIL AREA:<br>2.63mm <sup>2</sup> -6.64mm <sup>2</sup> [5180-13100] | MATERIAL<br>BODY, SLV, COPPER PER ASTM B 152<br>INSUL., PVC, COLOR, YELLOW   | FINISH<br>BODY & SLV, TIN PLATE<br>PER ASTM B 545  | APVD<br>N BIRCH<br>17APR95   | PRODUCT SPEC<br>UL 486A                               |
| FOR ORDER ENTRY  | 1-800-526-5142                               |   |  |  | APPLICATION SPEC             | TERMINAL, RING TONGUE, PIDG™,<br>WIRE SIZE, 12-10 AWG |
| AMP 1470-13 REV 09HAY94  |  |   |  |  | WEIGHT                       | SIZE<br>A3  |
|  |  |   |  |  | CUSTOMER DRAWING             | CAGE CODE<br>00779                                    |
|  |  |   |  |  | SCALE<br>4:1                 | DRAWING NO<br>C-35364                                 |
|  |  |   |  |  | SHEET<br>1 OF 1              | REV<br>G  |