

Product Number: 3302-3-14-01-00-00-08-0

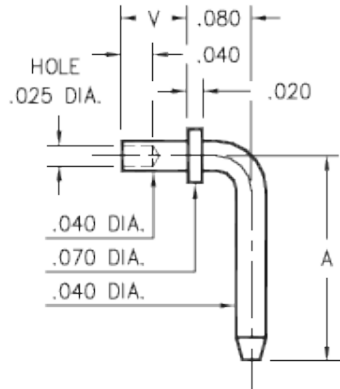

330X-X-14-XX-00-00-08-0

Specify board thickness
Swage mount in .043 hole

| Basic Part Number | Pin Centers A |
|-------------------|---------------|
| 3301-X | .257 |
| 3302-X | .357 |
| 3303-X | .375 |
| 3304-X | .562 |

| - X - | Board Thickness | Length V |
|-------|-----------------|----------|
| 1 | .031 | .051 |
| 2 | .062 | .082 |
| 3 | .094 | .113 |

Description:

3302 - Swage Terminal Pin

Packaging:

Packaged in Bulk

| Mill-Max Part Number | Shell Plating | Contact Plating | RoHS Compliant |
|-------------------------|-----------------------------------|-----------------|----------------|
| 3302-3-14-01-00-00-08-0 | 200 - 300 μ" Tin/Lead over Nickel | 00 | NO |

SHELL MATERIAL:

BRASS ALLOY (UNS C36000) per ASTM B 16

Properties of BRASS ALLOY:

- Chemical composition: Cu 61.5%, Zn 35.4%, Pb 3.1%†
- Hardness as machined: 80-90 Rockwell B
- Density: .307 lbs/in³
- Electrical conductivity: 26% IACS*
- Melting point: 900°C/885°C (liquidus/solidus)

†(3 to 4% lead is used to permit "free machining" and is permitted by EC Directive 2002/95Annex 6; so all pin materials are RoHS compliant)

*International Annealed Copper Standard, i.e. as a % of pure copper.