

NOTES: UNLESS OTHERWISE SPECIFIED

- P/N: 0148/0 & P/N: 0201
INSULATOR: HEAT SHRINK TUBING 221. BLACK.
BODY: BRASS. 40µ [1.02µm] MIN GOLD OVER NICKEL PLATED.
CONTACT: BeCu OR PHOSPHOR BRONZE. 40µ [1.02µm] MIN GOLD OVER NICKEL PLATED.
- P/N: W-701/COLOR
28AWG 19X40 TINNED COPPER
0.047 [1.19] O.D. PVC INSULATION
AVAILABLE IN TEN COLORS.
- PERFORMANCE
MAXIMUM CURRENT: 1.0 AMPS
MAXIMUM VOLTAGE: 600 W.V.D.C.
MAXIMUM TEMPERATURE: 221°F (105°C)

LTR	DESCRIPTION	REVISIONS	DATE	APPROVED

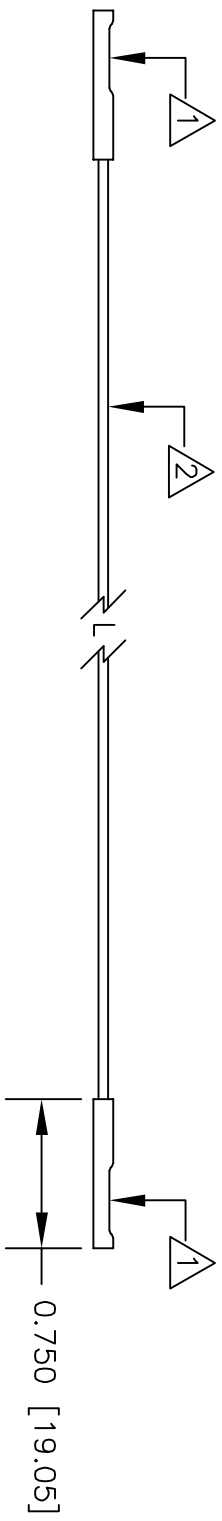

UNLESS OTHERWISE SPECIFIED DIMENSIONS ARE IN INCHES TOLERANCES ARE: FRACTIONS DECIMALS ANGLES		CONTRACT NO.		DESCRIPTION		
±	.XX ±	±	APPROVALS	DATE	E-Z-HOOK DIVISION OF TEKTEST INC. ARCADIA, CA 91006 U.S.A.	
±	.XXX ±	±	DRAWN	R.L.		10/10
MATERIAL SEE NOTE.		APPROVED BY				
FINISH SEE NOTE.					SIZE CODE IDENT NO. DRAWING NO.	
USED ON					A 08505 9120	
APPLICATION		DO NOT SCALE DRAWING			SCALE 1:1	
					SHEET 1 OF 1	

THE INFORMATION CONTAINED IN THIS DOCUMENT IS PROPRIETARY TO E-Z-HOOK. THE INFORMATION IS NOT TO BE REPRODUCED WITHOUT PRIOR WRITTEN PERMISSION OF E-Z-HOOK. DIV. OF TEKTEST INC. MAXIMUM TESTED RATINGS IN A HANDS-FREE CONTROLLED ENVIRONMENT. MAXIMUM RATINGS ARE NOT TO BE USED CONCURRENTLY.