

FLUKE
336 and 337
Clamp Meter
 Instruction Card

Clamp Meter
 335, 336, 337
 Användning av detta apparat.
 Användning
 Clamp Meter
 335, 336, 337
 Användning "333, 334,
 Användning" antes de
 Meter Safety
 Clamp Meter Safety
 Meter Safety Sheet
 337 Clamp Meter
 Användning i brug.
 Meter Safety
 335, 336, 337
 Användning
 336, 337 Clamp
 36, 337 クランプ
 ください。
 335, 336, 337
 Användning
 335, 336, 337
 Användning
 Safety Sheet

On/Off

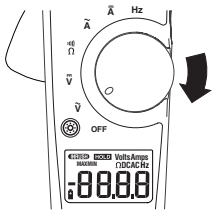

Backlight On/Off ☼

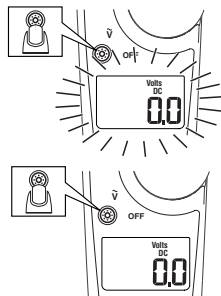

Automatic Off

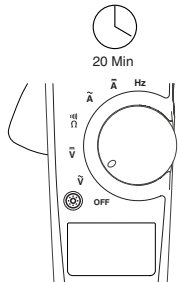

Battery Replacement

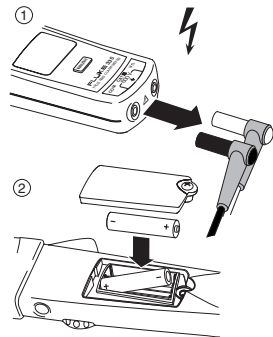

~A

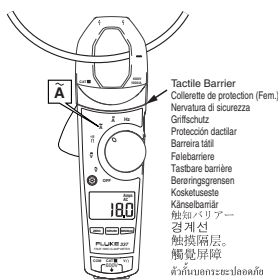

-A

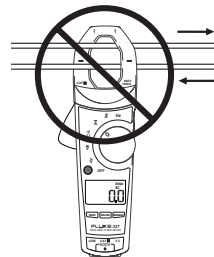
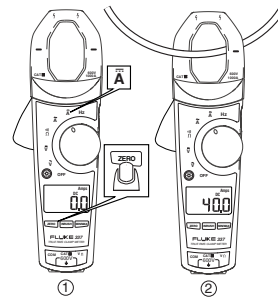

Currents Cancel
 Les courants s'annulent. Le correnti si cancellano,
 Ströme abbrechen. Se cancelan las corrientes,
 Cancellamento de correntes, Strömen kompensieren
 elkaar. Stromuljevning. Strömstyrkeannullering
 Strömstyrker udbalancerer. Virta pois. Avbryt ström
 電流のキャンセル, 전류 상쇄, 電流互相取消,
 電流互相取消, 電流互相取消

V, Ω
 0 - 600.0 V ac
 0 - 600.0 V dc
 0 - 6000 Ω

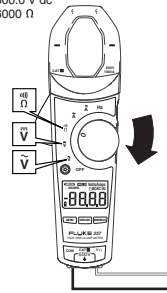

Inrush Current

Appel de courant, Corrente di spunto, Einschaltstoßstrom, Corrente de entrada, Corrente de partida, Inkomende stroom, Innkopplingsstrømspiss, Sekundær tomgangsstrømsstyrke, Tasoitettu virta, Inström, 突入電流, 突入 전류, 湧流, 涌流, 湧流, 湧流

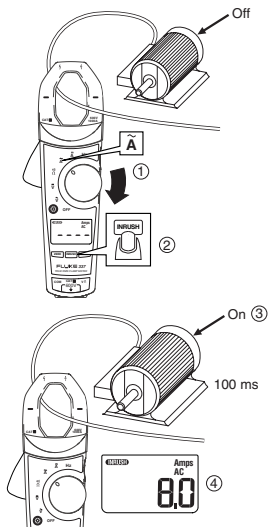

Hold

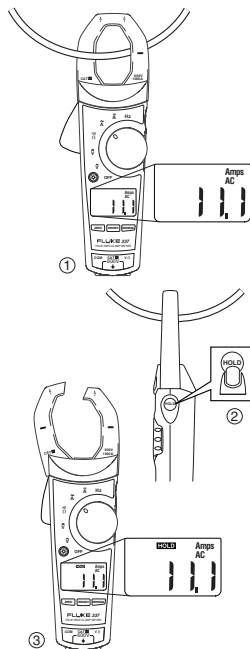

Hz (Amps Only)

337

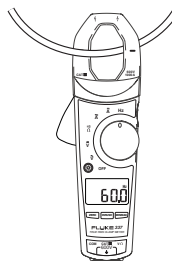

Min Max

337



Specifications

		336	337
A	Range	0 - 600.0 A	0 - 999.9 A
	Accuracy	2% ± 5 counts (10 - 100 Hz) 6% ± 5 counts (100 - 400 Hz)	
	Crest Factor add 2% for CF > 2	3 @ 500 A 2.5 @ 600 A	3 @ 500 A 2.5 @ 600 A 1.42 @ 1000 A
	AC Response	rms	
Inrush	Integration Time	100 ms	
A	Range	0 - 600.0 A	0 - 999.9 A
	Accuracy	2% ± 5 counts	
V	Range	0 - 600.0 V	
	Accuracy	1% ± 5 counts (20 - 100 Hz) 6% ± 5 counts (100 - 400 Hz)	
	AC Response	rms	
V	Range	0 - 600.0 V	
	Accuracy	1% ± 5 counts	
Ω	Range	0 - 600.0 Ω, 600 - 6000 Ω	
	Accuracy	1.5% ± 5 counts	
Continuity	μΩ	≤ 30 Ω	
Hz-Amps Only Trigger Level	Range	—	
10-100 Hz ≥ 5 A	Accuracy	5.0 - 400.0 Hz	
5-10, 100-400 Hz > 10 A	Accuracy	0.5% ± 5 counts	
Storage Temperature		-40 °C to 60 °C	
Operating Temperature		-10 °C to 50 °C	
Altitude		2500 m	
EMC - instrument unspecified for use in EMC field ≥ 0.5 V/m			
CAT III 600V, pollution degree II:			
CAT III equipment is designed to protect against transients in equipment in fixed - equipment installations, such as distribution panels, feeders and short branch circuits, and lighting systems in large buildings.			
* < 18 °C, > 28 °C add 0.1 x (specified accuracy) / °C			