

**Product Number: 2506-1-00-44-00-00-07-0**

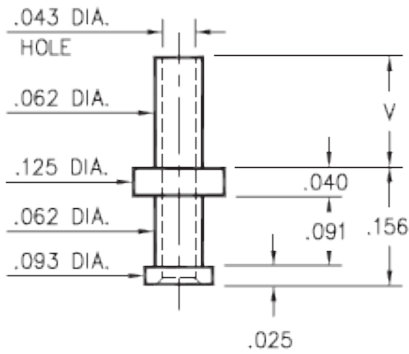

| - X - | Board Thickness | Length V |
|-------|-----------------|----------|
| 1     | .031            | .053     |
| 2     | .062            | .084     |
| 3     | .094            | .115     |
| 4     | .125            | .147     |

**Description:**

**2506** - Turret Terminal Pin

**Packaging:**

Packaged in Bulk

**2506-X-00-XX-00-00-07-0**

Swage mount in .067 hole

| Mill-Max Part Number    | Shell Plating             | Contact Plating | RoHS Compliant  |
|-------------------------|---------------------------|-----------------|---|
| 2506-1-00-44-00-00-07-0 | 300 μ" Silver over Copper | 00              |  |

**SHELL MATERIAL:**

**BRASS ALLOY (UNS C36000) per ASTM B 16**

**Properties of BRASS ALLOY:**

- Chemical composition: Cu 61.5%, Zn 35.4%, Pb 3.1%†
- Hardness as machined: 80-90 Rockwell B
- Density: .307 lbs/in<sup>3</sup>
- Electrical conductivity: 26% IACS\*
- Melting point: 900°C/885°C (liquidus/solidus)

†(3 to 4% lead is used to permit "free machining" and is permitted by EC Directive 2002/95Annex 6; so all pin materials are RoHS compliant)

\*International Annealed Copper Standard, i.e. as a % of pure copper.