

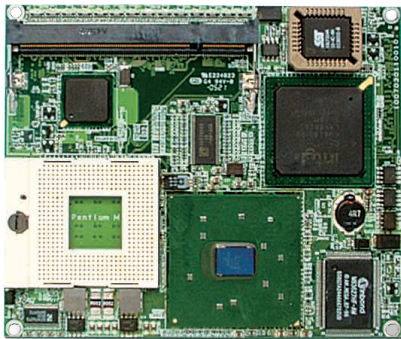

# EmETX-i702

Intel® Pentium® M ETX® CPU Module



## ETX

### Features

- Support Socket 479 Intel® Mobile Processors
- Dual Channels 18-bit LVDS, and Analog RGB
- Dual Independent Displays
- Multi-expansion (4 x USB, 2 x PATA, 2 x Serial Ports, 4 x PCI Masters, ISA Bus)
- **Extended Operating Temp.: -20 ~ 70°C**

### System

<b>CPU</b>	Intel® Pentium® M/Celeron® M CPU with 400MHz FSB
<b>Memory</b>	1 x 200-pin DDR SO-DIMM Socket supporting 200/266MHz SDRAM up to 1GB
<b>Chipset</b>	Intel® 852GM + ICH4
<b>BIOS</b>	Phoenix-Award PnP Flash BIOS
<b>Storage</b>	2 x Ultra ATA, support 4 IDE devices
	1 x Floppy disk drive shared with parallel port
<b>Watchdog Timer</b>	1~255 levels reset

### I/O

<b>I/O Chip</b>	Winbond W83627HG
<b>Serial Port</b>	2 x COM ports (1 x RS-232, 1 x RS-232/422/485 selectable via PBE-1000)
<b>Parallel Port</b>	SPP/EPP/ECP mode
<b>USB Port</b>	4 x USB 2.0 ports
<b>KB/MS</b>	PS/2 interface for Keyboard and Mouse (via PBE-1000)
<b>Expansion Bus</b>	PCI (4 x PCI masters) and ISA bus

### Ethernet

<b>Chipset</b>	1 x Intel® 82562EZ 10/100Base-T Ethernet controller
----------------	---

### Audio

<b>CODEC/Interface</b>	Realtek ALC655 6 Channel AC97 Audio CODEC, Mic-in/Line-in/Line-out
------------------------	--

### Display

<b>Graphics Chipset</b>	Integrated Intel® 852GM Extreme Graphics2 Engine up to 64MB UMA Video RAM
<b>Graphics Interface</b>	Analog RGB support up to 2048 x 1536
	LCD: Dual Channels 18-bit LVDS UXGA up to 1600 x 1200
	Support dual independent displays

### Mechanical & Environmental

<b>Power Consumption</b>	3.53A/5V with Intel® Celeron® M 600MHz
	5.5A/5V with Intel® Pentium® M 1.4GHz
<b>Operating Temp.</b>	-20 ~ 70°C (-4 ~ 158°F)
<b>Operating Humidity</b>	0 ~ 90% (non-condensing)
<b>Dimension (L x W)</b>	114 x 95 mm (4.5" x 3.7")

### Dimensions

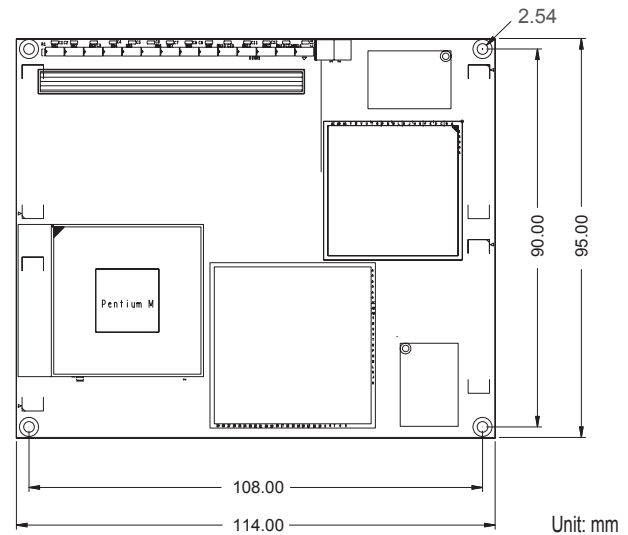

### Ordering Information

<b>EmETX-i702</b>	Socket 479 Intel® Pentium® M/Celeron® M ETX® CPU module
<b>HS-0702-C3</b>	Heatsink with fan (116 x 98 x 42 mm)
<b>HS-0702-F2</b>	Heat spreader (117 x 95 x 8 mm)
<b>PBE-1000 R2.1</b>	ETX® evaluation board in ATX form factor Page 1-20
<b>CBK-05-1000-00</b>	Cable kit for PBE-1000 R2.1
	1 x FDD cable
	3 x COM port cables
	1 x USB cable
	2 x IDE cables
	1 x TV-out cable

All specifications are subject to change without notice.

Computer on Module

Compact Board

Slot Board

Industrial Motherboard

Wide Temperature

SBC Daughterboard /Power Converter /Mounting Kit

Rugged Tablet PC

Medical PC

Industrial Panel PC/Monitor

Box PC

Industrial Chassis Backplane/Power supply