

Mini-Universal MATE-N-LOK Connectors (Continued)

Contacts

Pin Diameter — 0.99 [.039]
 Stock Thickness — 0.20 [.008]

Material and Finish

Brass or phosphor bronze with pre-tin plating or duplex plated 0.00076 [.000030] min. gold in mating area and .00254 [.000100] min. tin-lead in crimping area over 0.00127 [.000050] nickel underplate on entire contact

Wire Size Range AWG (mm ²)	Ins. Dia. Range	Finish	Contact Part Numbers			
			Pin		Socket	
			Strip Form	Loose Form	Strip Form	Loose Form
30-26 [.05-.12]	1.19-1.27 [.035-.050]	Pre-tin	—	—	770834-1	794058-1
26-22 [.12-.3]	1.19-1.75 [.047-.069]	Pre-tin	770901-1	770985-1	770902-1	770986-1
		Duplex ¹	770901-3	770985-3	770902-3	770986-3
22-18 [.3-.8] or 22 x (2) [.3]	1.50-2.39 [.059-.110] or 3.38 Max. [.3]	Pre-tin	—	—	770904-1	770988-1
		Duplex ¹	—	770987-3	770904-3	770988-3
20-16 [.5-1.2] or 20 x (2) [.5]	2.01-3.20 [.079-.126] or 2.39 x (2) [.094]	Pre-tin	171636-1 ²	171638-1 ²	171637-1 ²	171639-1 ²
		Duplex ¹	—	—	171637-3 ²	—

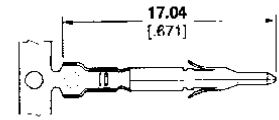

Pin

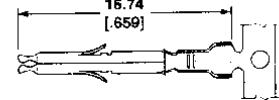

Socket

¹Duplex Finish — Plated with .000762 [.000030] min. gold in mating area and .00254 [.000100] min. tin-lead in crimping area over .00127 [.000050] min. nickel underplate on entire contact.

²17.04 [.671] and 16.74 [.659] dimensions are 17.50 [.689] for indicated part numbers.

Housings

Free Hanging or Panel Mount

Centerline Spacing — 4.14 [.163]
 Mating Headers — Page 398

Recommended Cap Housing Panel Cutout

View is from cap entry side
 Recommended Panel Thickness — .79 - 2.01 [.031 - .079]

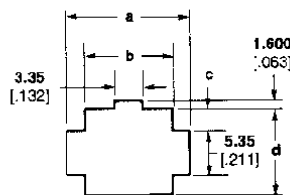

1 Circuit, Free Hanging

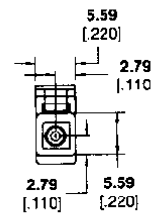
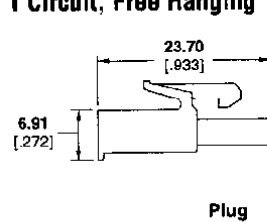

2 and 3 Circuit, In-Line

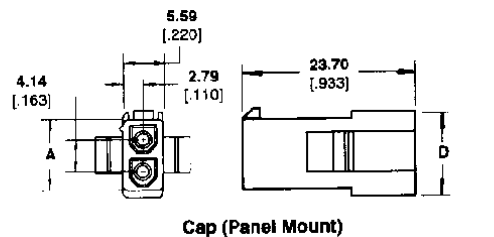
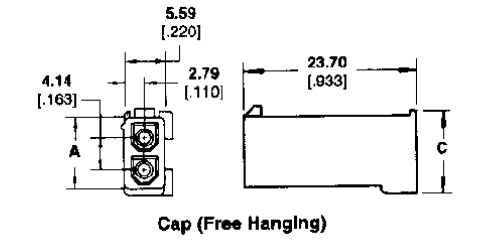
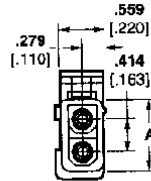
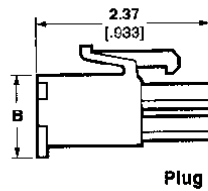

Number of Circuits	Dimensions			
	a	b	c	d
1	—	—	—	—
2	10.69 [.421]	6.15 [.242]	2.49 [.098]	10.3 [.407]
3	10.69 [.421]	6.15 [.242]	4.60 [.181]	14.55 [.573]

Number of Circuits	Dimensions				Housing Part Numbers						
	A	B	C	D	UL 94V-0 Nylon, White Color			UL 94V-2 Nylon, Natural Color			
					Plug	Cap		Plug	Cap		
1	—	—	—	—	172164-1	—	—	—	—	—	—
2	9.80 [.386]	10.79 [.425]	12.39 [.488]	11.78 [.464]	172165-1	172157-1	172233-1	172336-1	172328-1	172343-1	
3	14.00 [.551]	15.01 [.591]	16.61 [.654]	16.00 [.630]	172166-1	172158-1	172234-1	172337-1	172329-1	172344-1	